

Indoor | Linear systems and solutions for coves | Yori Channel Arm

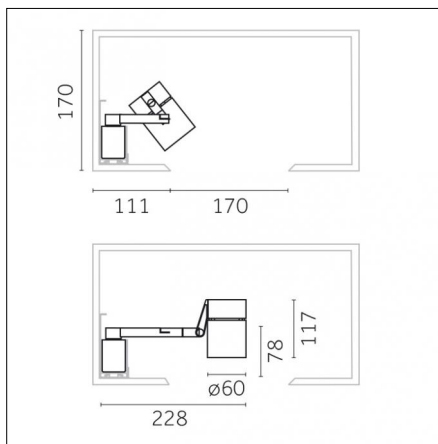

Narrow 13°

12

IP20



Risk 1

850°



**Code 0.QM22B.HC12**

### Light source features

**Number of light sources:** 1

**Source type:** LED HC

**Watt:** 9W

**Lm:** 960lm

**Lm/W:** 107lm/W

**Kelvin/CRI:** 3000K / >98

**SDCM/L90 B10:** < 2 / 50000

**Fixture total output:** 797 lm

**Fixture efficacy:** 77 lm/W

**Imax:** 10201 cd

### Electrical features

**Driver included:** YES

**Driver position:** integrated

**Driver type:** On-Off

**Isolation class:** Class I

### Optical features

**Beam angle:** 13°

**Optical type, adjustability:** Adjustable

**Interchangeable optic (IOS):** YES

### Physical features

**Material:** Die-cast aluminium

**Mounting:** Surface mounted

**Fixing:** Ceiling

**Finishing:** Embossed matt white (Standard)

**Weight:** 0.75Kg

### Notes:

The lighting body is fitted with a 4-point articulated arm: Adapter: +/- 68° in the vertical axis First articulation point: +/- 90° in the vertical axis Second articulation point: 45° in the horizontal axis Projector head: 90° in the horizontal axis

Luminaire constructed in conformity with Directives 2014/35/EU (LV), 2014/30/EU (EMC), 2009/125/EC (Ecodesign) with Regulations (EC) No 245/2009, (EU) No 347/2010 and (EU) 2015/1428 (for luminaires with fluorescent and metal halide lamps only), 2009/125/EC (Ecodesign) with Regulations (EU) No 1194/2012 and 2015/1428 (for LED luminaires only), 2011/65/EU (RoHS 2) and 2012/19/EU (WEEE).

### Reggiani SPA Illuminazione

Viale Monza, 16 20845 Sovico (MB) Italy  
Tel. (+39) 039 2071.1 fax (+39) 039 2071 999

www.reggiani.net  
contact@reggiani.net

## Photometries

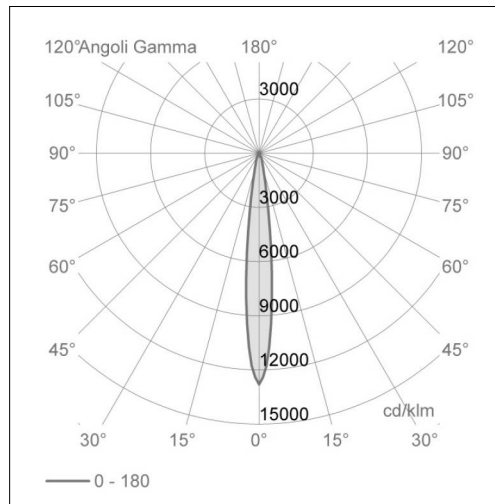
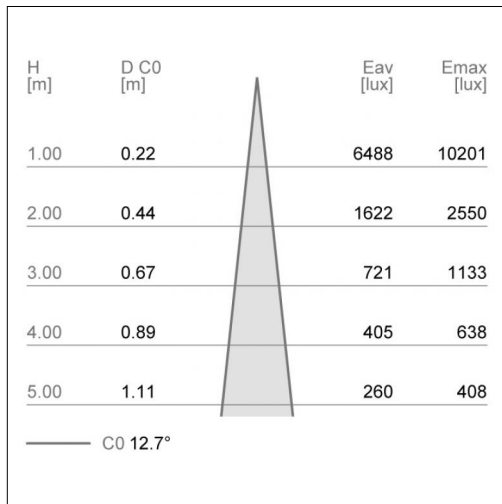

0\_QM22B\_HC\_12.ies

0\_QM22B\_HC\_12.LDT

## Specifications text

### YORI

Track, channel, recessed and surface mounting fixture. Symmetrical output. Available for LED and metal halide lamps. Die-cast aluminium body. Interchangeable IOS Ø 50mm (LL1) and Ø 80mm (LL2) reflectors in polycarbonate stabilised up to 140° with highly reflective metal coating - exclusive anti-scratch treatment with surface vitrification for LED lamps. Interchangeable IOS Ø 80mm reflectors in 99.99% pure aluminium, with bayonet fitting for metal halide lamps. Anti-static polycarbonate protective screen with a high transmission index (97%); transparent for very narrow light beams, satin for narrow, medium and wide beams and satin/prismatic for the Mira version; anti-yellowing, stabilised against UV rays, resistant to 850° incandescent wire test, self-extinguishing V0; tempered protective glass for IOS reflectors for metal halide lamps Spot adjustable 0° to 90° vertically and 356° horizontally; integrated plastic no-glare screen; recessed optics for improved visual comfort; mounts to false ceilings with the innovative ClikFix one-way spring system (for recessed, semi-recessed and surface mounted versions); drilled bezel for fine mortaring with 0.7 mm trimless bezel thickness for perfect plastering (recessed version); special perforated steel panel maximises heat dispersal outwards (recessed version); vertical slide for moving the luminaire outwards (recessed version); grub screw for locking the adjustment (recessed version); mechanical/electrical connector with m/f connectors (channel version); up to 10 units can be connected in line with a single power supply (channel version); articulated boom for orienting the fixture (for coves, false ceiling and surround versions); available as pre-assembled KIT version with 2, 3 and 4 fixtures for channel, surface and trimless mounting. Anti-yellowing epoxy powder coating, stabilised against UV rays. Product available with the following finishes: matt embossed white 12, matt embossed black 31. Passive heat dissipation via optimised fixture casing construction, which uses the heat conductivity of the metal and convective currents. Available with LED ON/OFF driver, DIMM 1-10V, PHASE CUTTING and DALI 220/240V VAC 50/60 Hz. Electronic driver for LED lamps, electronic power supply for metal halide lamps. Driver/power supply included in package. Isolation class II and III. IP20. The product can be equipped with: cross grille, no-glare honeycomb grille and UV, IR, dichroic and selective filters for food applications. Emergency unit (3 hour) available as accessory equipment. Fixture built in compliance with Standard EN 60598-1 and amendments and EC Directives 2006/95/CE (low voltage), 2004/108/CE (EMC), 2009/125/CE (Ecodesign), 2002/96/CE (RAEE), 2011/65/CE (RoHS).

Luminaire constructed in conformity with Directives 2014/35/EU (LV), 2014/30/EU (EMC), 2009/125/EC (Ecodesign) with Regulations (EC) No 245/2009, (EU) No 347/2010 and (EU) 2015/1428 (for luminaires with fluorescent and metal halide lamps only), 2009/125/EC (Ecodesign) with Regulations (EU) No 1194/2012 and 2015/1428 (for LED luminaires only), 2011/65/EU (RoHS 2) and 2012/19/EU (WEEE).

### Reggiani SPA Illuminazione

Viale Monza, 16 20845 Sovico (MB) Italy  
Tel. (+39) 039 2071.1 fax (+39) 039 2071 999

www.reggiani.net  
contact@reggiani.net

## Optics

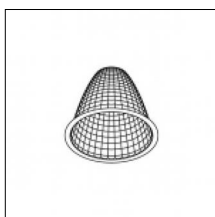

**Code 0.35145.0000 - Ø60mm performance optic 13° - LED**

Finishing:  
Description:



Narrow 13°

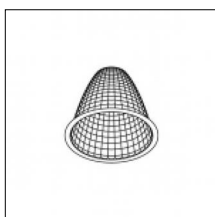

**Code 0.35146.0000 - Ø60mm performance optic 24° - LED**

Finishing:  
Description:



Medium 24°

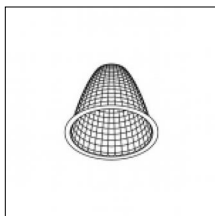

**Code 0.35147.0000 - Ø60mm performance optic 39° - LED**

Finishing:  
Description:



Medium-wide 38°

## Accessories

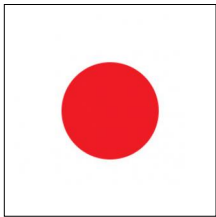

**Code 0.26403.004A - Red glass filter 1 mm**

Type: Optical  
Finishing: Red

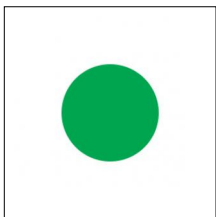

**Code 0.26403.005A - Green glass filter 1 mm**

Type: Optical  
Finishing: Green

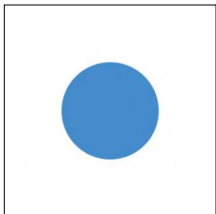

**Code 0.26403.006A - Blue glass filter 1 mm**

Type: Optical  
Finishing: Blue

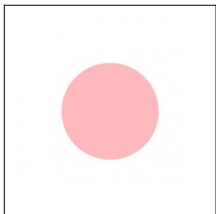

**Code 0.26403.007A - Pink glass filter 1 mm**

Type: Optical  
Finishing: Pink

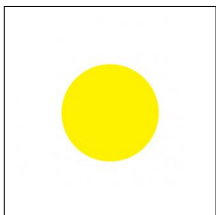

**Code 0.26403.008A - Yellow glass filter 1 mm**

Type: Optical  
Finishing: Yellow

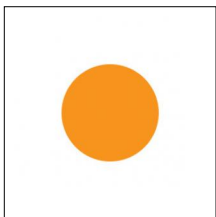

**Code 0.26403.009A - Orange glass filter 1 mm**

Type: Optical  
Finishing: Orange

## Accessories

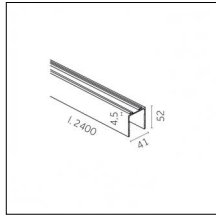
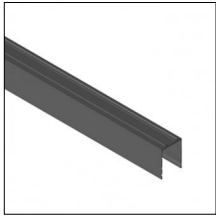

### Code 0.25401.0012 - Surface-mounted rail + connecting piece

Type: Structural  
 Finishing: Embossed matt white (Standard)  
 Description: Length: 2400mm

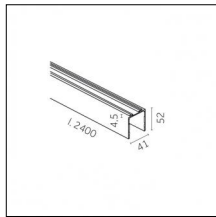
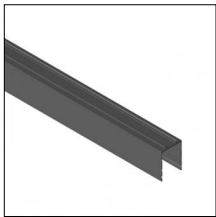

### Code 0.25401.0031 - Surface-mounted rail + connecting piece

Type: Structural  
 Finishing: Embossed matt black (Standard)  
 Description: Length: 2400mm

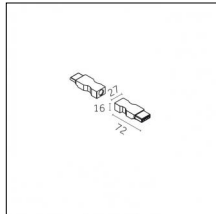
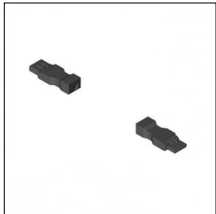

### Code 0.25417.0000 - Connector

Type: Structural  
 Finishing: Without finish / Stainles Steel / Natural aluminium (Standard)  
 Height: 16mm  
 Description: Connector with plug and socket for electric cable with maximum section of 1.5 mm

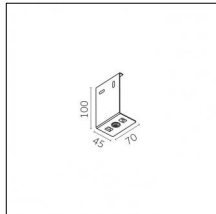

### Code 0.25431.0012 - Concealed mounting rail bracket

Type: Structural  
 Finishing: Embossed matt white (Standard)  
 Length: 70mm Width: 45mm Height: 100mm

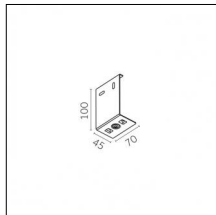

### Code 0.25431.0031 - Concealed mounting rail bracket

Type: Structural  
 Finishing: Embossed matt black (Standard)  
 Length: 70mm Width: 45mm Height: 100mm

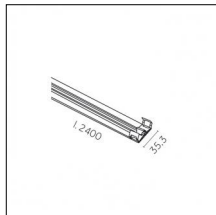

### Code 0.25432.0012 - Mounting rail cover including spring clips

Type: Structural  
 Finishing: Embossed matt white (Standard)  
 Description: Length: 2400mm

## Accessories

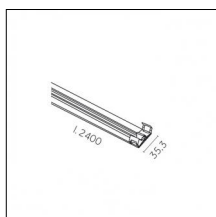

### Code 0.25432.0031 - Mounting rail cover including spring clips

Type: Structural  
 Finishing: Embossed matt black (Standard)  
 Description: Length: 2400mm

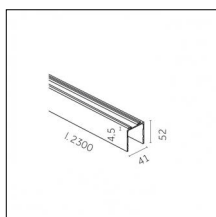
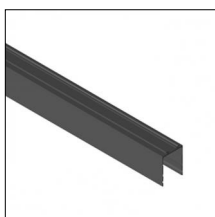

### Code 0.25801.0012 - Surface-mounted rail module

Type: Structural  
 Finishing: Embossed matt white (Standard)  
 Description: Add on to 0.25401.00 for strip configuration for up to 10 Yori luminaires on total section, including mechanical coupler  
 Length: 2300mm

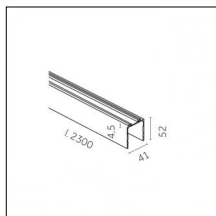
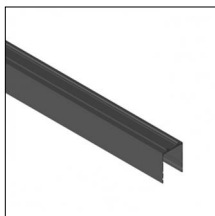

### Code 0.25801.0031 - Surface-mounted rail module

Type: Structural  
 Finishing: Embossed matt black (Standard)  
 Description: Add on to 0.25401.00 for strip configuration for up to 10 Yori luminaires on total section, including mechanical coupler  
 Length: 2300mm

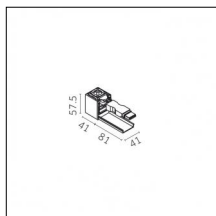
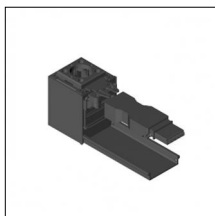

### Code 0.25850.0012 - Live end cap

Type: Structural  
 Finishing: Embossed matt white (Standard)  
 Height: 57.5mm  
 Description: Live end cap (dead end) module composed of: connector, 41 mm pronged base cap, fill-in space cover, 81 mm mounting rail cap

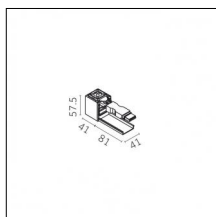
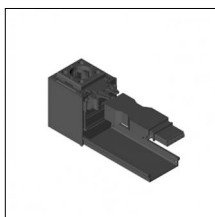

### Code 0.25850.0031 - Live end cap

Type: Structural  
 Finishing: Embossed matt black (Standard)  
 Height: 57.5mm  
 Description: Live end cap (dead end) module composed of: connector, 41 mm pronged base cap, fill-in space cover, 81 mm mounting rail cap

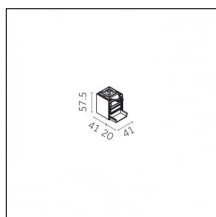
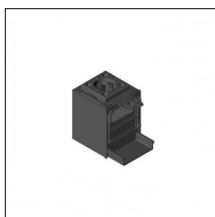

### Code 0.25851.0012 - Terminal end cap

Type: Structural  
 Finishing: Embossed matt white (Standard)  
 Height: 57.5mm  
 Description: Terminal end cap (dead end) module composed of: 41 mm cap, 41 mm pronged base cap, fill-in space cover, 20 mm mounting rail cap

## Accessories

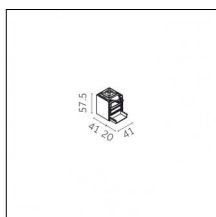
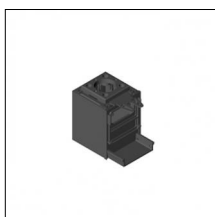

### Code 0.25851.0031 - Terminal end cap

Type: Structural

Finishing: Embossed matt black (Standard)

Height: 57.5mm

Description: Terminal end cap (dead end) module composed of: 41 mm cap, 41 mm pronged base cap, fill-in space cover, 20 mm mounting rail cap

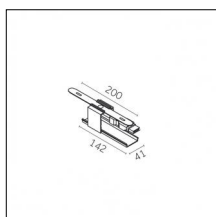
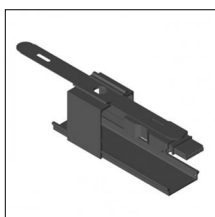

### Code 0.25852.0012 - Centre feed module

Type: Structural

Finishing: Embossed matt white (Standard)

Height: 57.5mm

Description: Centre feed module composed of: central body, mechanical coupler and 142 mm cover

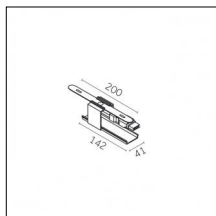
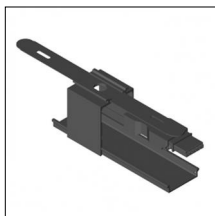

### Code 0.25852.0031 - Centre feed module

Type: Structural

Finishing: Embossed matt black (Standard)

Height: 57.5mm

Description: Centre feed module composed of: central body, mechanical coupler and 142 mm cover

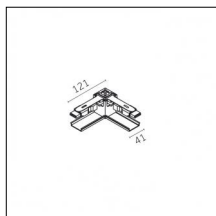

### Code 0.25853.0012 - "L" coupler for surface-mounted rail

Type: Structural

Finishing: Embossed matt white (Standard)

Length: 121mm Width: 41mm Height: 57.5mm

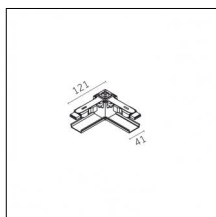
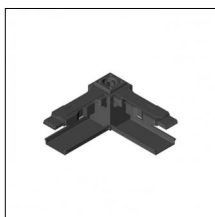

### Code 0.25853.0031 - "L" coupler for surface-mounted rail

Type: Structural

Finishing: Embossed matt black (Standard)

Length: 121mm Width: 41mm Height: 57.5mm

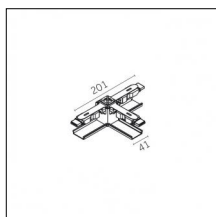

### Code 0.25854.0012 - "T" coupler for surface-mounted rail

Type: Structural

Finishing: Embossed matt white (Standard)

Length: 201mm Width: 41mm Height: 57.5mm

## Accessories

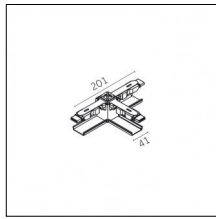
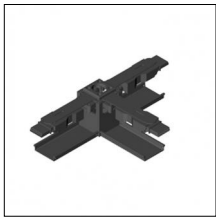

### Code 0.25854.0031 - "T" coupler for surface-mounted rail

Type: Structural  
Finishing: Embossed matt black (Standard)  
Length: 201mm Width: 41mm Height: 57.5mm

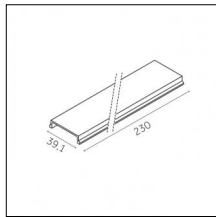

### Code 0.25870.0012 - Hard cover for surface-mounted and suspended mounting rail

Type: Structural  
Finishing: Embossed matt white (Standard)  
Length: 230mm Width: 35.3mm

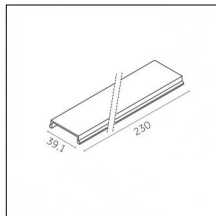

### Code 0.25870.0031 - Hard cover for surface-mounted and suspended mounting rail

Type: Structural  
Finishing: Embossed matt black (Standard)  
Length: 230mm Width: 35.3mm

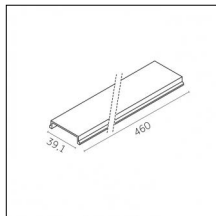

### Code 0.25871.0012 - Hard cover for surface-mounted and suspended mounting rail

Type: Structural  
Finishing: Embossed matt white (Standard)  
Length: 460mm Width: 35.3mm

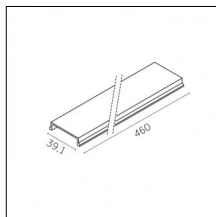

### Code 0.25871.0031 - Hard cover for surface-mounted and suspended mounting rail

Type: Structural  
Finishing: Embossed matt black (Standard)  
Length: 460mm Width: 35.3mm

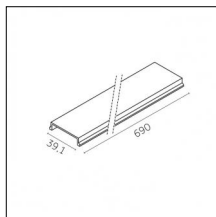

### Code 0.25872.0012 - Hard cover for surface-mounted and suspended mounting rail

Type: Structural  
Finishing: Embossed matt white (Standard)  
Length: 690mm Width: 35.3mm



## Accessories

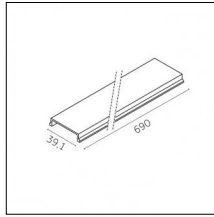

### Code 0.25872.0031 - Hard cover for surface-mounted and suspended mounting rail

Type: Structural  
Finishing: Embossed matt black (Standard)  
Length: 690mm Width: 35.3mm

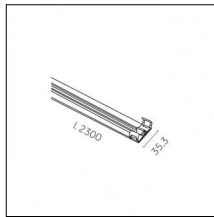

### Code 0.25874.0012 - Mounting rail cover including spring clips length: 2300 mm

Type: Structural  
Finishing: Embossed matt white (Standard)  
Length: 2300mm Width: 35.3mm  
Description: Mounting rail cover including spring clips length: 2300 mm

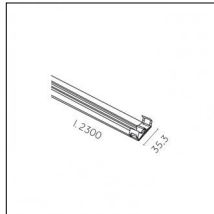

### Code 0.25874.0031 - Mounting rail cover including spring clips length: 2300 mm

Type: Structural  
Finishing: Embossed matt black (Standard)  
Length: 2300mm Width: 35.3mm  
Description: Mounting rail cover including spring clips length: 2300 mm

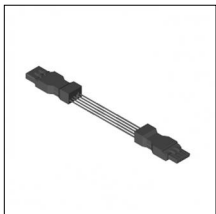

### Code 0.25880.0000 - Pre-wired power cable with plug and socket

Type: Structural  
Finishing: Without finish / Stainles Steel / Natural aluminium (Standard)  
Length: 230mm  
Description:

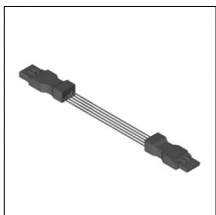

### Code 0.25881.0000 - Pre-wired power cable with plug and socket

Type: Structural  
Finishing: Without finish / Stainles Steel / Natural aluminium (Standard)  
Length: 460mm

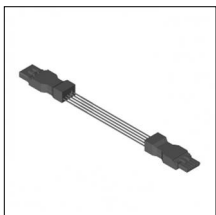

### Code 0.25882.0000 - Pre-wired power cable with plug and socket

Type: Structural  
Finishing: Without finish / Stainles Steel / Natural aluminium (Standard)  
Length: 690mm

## Accessories



### Code 0.26411.0000 - Colored Gel Slides (2 pieces)

Type: Optical  
Finishing: Without finish / Stainles Steel / Natural aluminium (Standard)

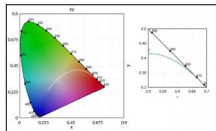
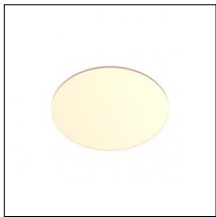

### Code 0.26419.0000 - Selective filter 2700K - 2500K

Type: Optical  
Finishing: Without finish / Stainles Steel / Natural aluminium (Standard)

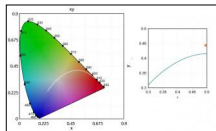
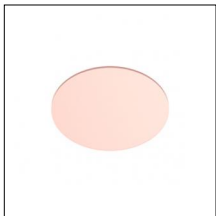

### Code 0.26427.0000 - Selective filter 2700K - 2200K

Type: Optical  
Finishing: Without finish / Stainles Steel / Natural aluminium (Standard)

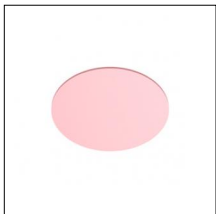

### Code 0.26435.0000 - Selective filter 2700K - 2000K

Type: Optical  
Finishing: Without finish / Stainles Steel / Natural aluminium (Standard)



### Code 0.26443.0000 - Honeycomb dense texture

Type: Optical  
Finishing: Without finish / Stainles Steel / Natural aluminium (Standard)



### Code 0.26451.0000 - Honeycomb wide texture

Type: Optical  
Finishing: Without finish / Stainles Steel / Natural aluminium (Standard)

## Accessories

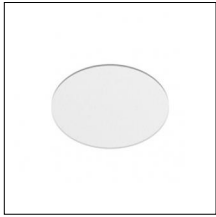

### Code 0.26463.0000 - Opal lens

Type: Optical

Finishing: Without finish / Stainles Steel / Natural aluminium (Standard)

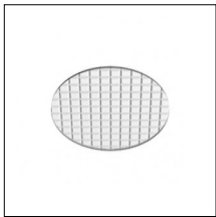

### Code 0.26471.0000 - Diffusive lens

Type: Optical

Finishing: Without finish / Stainles Steel / Natural aluminium (Standard)

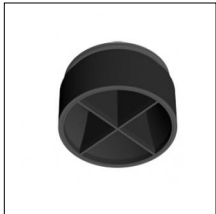

### Code 0.26481.0000 - Cross blade louvre

Type: Optical

Finishing: Without finish / Stainles Steel / Natural aluminium (Standard)

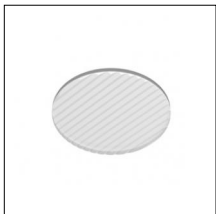

### Code 0.26493.0000 - Ribbed glass

Type: Optical

Finishing: Without finish / Stainles Steel / Natural aluminium (Standard)



### Code 0.26497.0012 - Cone 45 ° wall washer

Type: Optical

Finishing: Embossed matt white (Standard)



### Code 0.26497.0031 - Cone 45 ° wall washer

Type: Optical

Finishing: Embossed matt black (Standard)

## Accessories

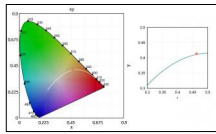
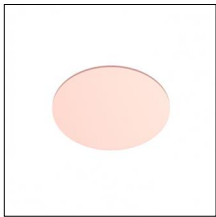

**Code 0.26560.0000 - Selective filter 3000K-2700K**

Type: Optical

Finishing: Without finish / Stainles Steel / Natural aluminium (Standard)

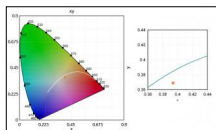
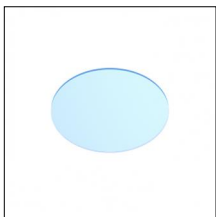

**Code 0.26568.0000 - Selective filter 3000K-3600K**

Type: Optical

Finishing: Without finish / Stainles Steel / Natural aluminium (Standard)

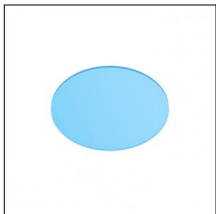

**Code 0.26576.0000 - Selective filter 3000K-4000K**

Type: Optical

Finishing: Without finish / Stainles Steel / Natural aluminium (Standard)

Indoor | Linear systems and solutions for coves | Yori Channel Arm

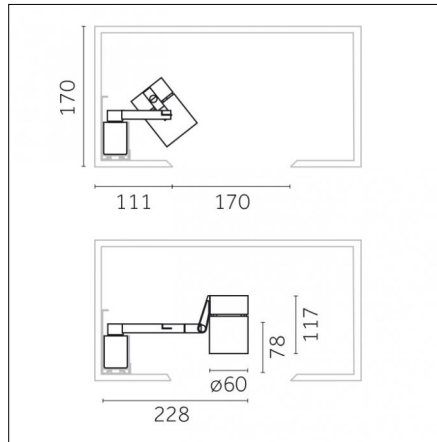

Narrow 12°

12

IP20



Risk 1

850°



**Code 0.QM12B.HC12**

### Light source features

**Number of light sources:** 1

**Source type:** LED HC

**Watt:** 9W

**Lm:** 960lm

**Lm/W:** 107lm/W

**Kelvin/CRI:** 3000K / >98

**SDCM/L90 B10:** < 2 / 50000

**Fixture total output:** 787 lm

**Fixture efficacy:** 76 lm/W

**Imax:** 12440 cd

### Electrical features

**Driver included:** YES

**Driver position:** integrated

**Driver type:** On-Off

**Isolation class:** Class I

### Optical features

**Beam angle:** 12°

**Optical type, adjustability:** Adjustable

**Interchangeable optic (IOS):** YES

### Physical features

**Material:** Die-cast aluminium

**Mounting:** Surface mounted

**Fixing:** Ceiling

**Finishing:** Embossed matt white (Standard)

**Weight:** 0.75Kg

### Notes:

The lighting body is fitted with a 4-point articulated arm: Adapter: +/- 68° in the vertical axis First articulation point: +/- 90° in the vertical axis Second articulation point: 45° in the horizontal axis Projector head: 90° in the horizontal axis

Luminaire constructed in conformity with Directives 2014/35/EU (LV), 2014/30/EU (EMC), 2009/125/EC (Ecodesign) with Regulations (EC) No 245/2009, (EU) No 347/2010 and (EU) 2015/1428 (for luminaires with fluorescent and metal halide lamps only), 2009/125/EC (Ecodesign) with Regulations (EU) No 1194/2012 and 2015/1428 (for LED luminaires only), 2011/65/EU (RoHS 2) and 2012/19/EU (WEEE).

**Reggiani SPA Illuminazione**

Viale Monza, 16 20845 Sovico (MB) Italy  
Tel. (+39) 039 2071.1 fax (+39) 039 2071 999

www.reggiani.net  
contact@reggiani.net

## Photometries

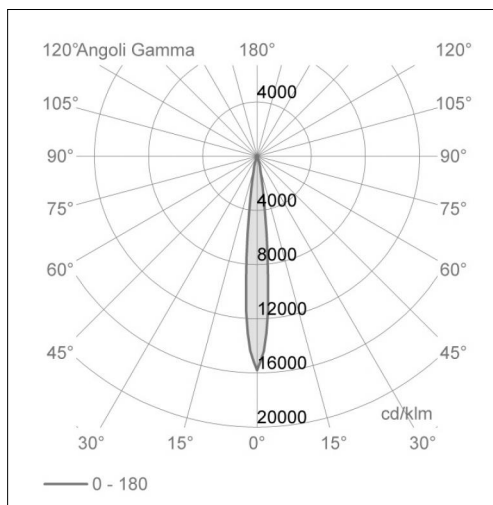
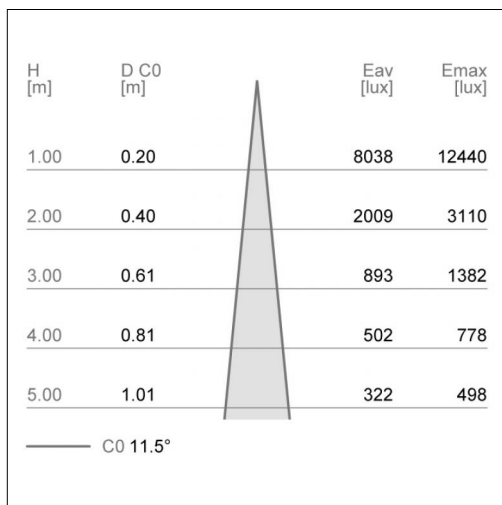

0\_QM12B\_HC\_12.ies

0\_QM12B\_HC\_12.LDT

## Specifications text

### YORI

Track, channel, recessed and surface mounting fixture. Symmetrical output. Available for LED and metal halide lamps. Die-cast aluminium body. Interchangeable IOS Ø 50mm (LL1) and Ø 80mm (LL2) reflectors in polycarbonate stabilised up to 140° with highly reflective metal coating - exclusive anti-scratch treatment with surface vitrification for LED lamps. Interchangeable IOS Ø 80mm reflectors in 99.99% pure aluminium, with bayonet fitting for metal halide lamps. Anti-static polycarbonate protective screen with a high transmission index (97%); transparent for very narrow light beams, satin for narrow, medium and wide beams and satin/prismatic for the Mira version; anti-yellowing, stabilised against UV rays, resistant to 850° incandescent wire test, self-extinguishing V0; tempered protective glass for IOS reflectors for metal halide lamps Spot adjustable 0° to 90° vertically and 356° horizontally; integrated plastic no-glare screen; recessed optics for improved visual comfort; mounts to false ceilings with the innovative ClikFix one-way spring system (for recessed, semi-recessed and surface mounted versions); drilled bezel for fine mortaring with 0.7 mm trimless bezel thickness for perfect plastering (recessed version); special perforated steel panel maximises heat dispersal outwards (recessed version); vertical slide for moving the luminaire outwards (recessed version); grub screw for locking the adjustment (recessed version); mechanical/electrical connector with m/f connectors (channel version); up to 10 units can be connected in line with a single power supply (channel version); articulated boom for orienting the fixture (for coves, false ceiling and surround versions); available as pre-assembled KIT version with 2, 3 and 4 fixtures for channel, surface and trimless mounting. Anti-yellowing epoxy powder coating, stabilised against UV rays. Product available with the following finishes: matt embossed white 12, matt embossed black 31. Passive heat dissipation via optimised fixture casing construction, which uses the heat conductivity of the metal and convective currents. Available with LED ON/OFF driver, DIMM 1-10V, PHASE CUTTING and DALI 220/240V VAC 50/60 Hz. Electronic driver for LED lamps, electronic power supply for metal halide lamps. Driver/power supply included in package. Isolation class II and III. IP20. The product can be equipped with: cross grille, no-glare honeycomb grille and UV, IR, dichroic and selective filters for food applications. Emergency unit (3 hour) available as accessory equipment. Fixture built in compliance with Standard EN 60598-1 and amendments and EC Directives 2006/95/CE (low voltage), 2004/108/CE (EMC), 2009/125/CE (Ecodesign), 2002/96/CE (RAEE), 2011/65/CE (RoHS).

Luminaire constructed in conformity with Directives 2014/35/EU (LV), 2014/30/EU (EMC), 2009/125/EC (Ecodesign) with Regulations (EC) No 245/2009, (EU) No 347/2010 and (EU) 2015/1428 (for luminaires with fluorescent and metal halide lamps only), 2009/125/EC (Ecodesign) with Regulations (EU) No 1194/2012 and 2015/1428 (for LED luminaires only), 2011/65/EU (RoHS 2) and 2012/19/EU (WEEE).

### Reggiani SPA Illuminazione

Viale Monza, 16 20845 Sovico (MB) Italy  
Tel. (+39) 039 2071.1 fax (+39) 039 2071 999

www.reggiani.net  
contact@reggiani.net

## Optics

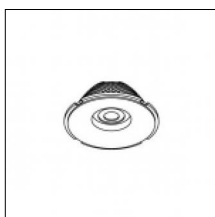

**Code 0.35125.0000 - Ø60mm precision optic 12° - LED**

Finishing:  
Description:



Narrow 12°

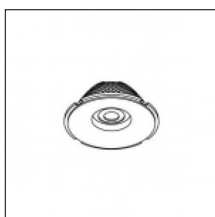

**Code 0.35126.0000 - Ø60mm precision optic 20° - LED**

Finishing:  
Description:



Medium 20°

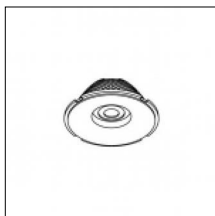

**Code 0.35127.0000 - Ø60mm precision optic 32° - LED**

Finishing:  
Description:



Wide 32°

## Accessories

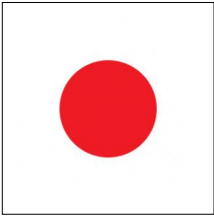

**Code 0.26402.004A - Red glass filter 1 mm**

Type: Optical  
Finishing: Red

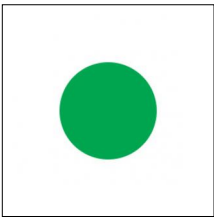

**Code 0.26402.005A - Green glass filter 1 mm**

Type: Optical  
Finishing: Green

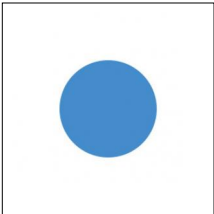

**Code 0.26402.006A - Blue glass filter 1 mm**

Type: Optical  
Finishing: Blue

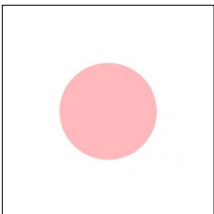

**Code 0.26402.007A - Pink glass filter 1 mm**

Type: Optical  
Finishing: Pink

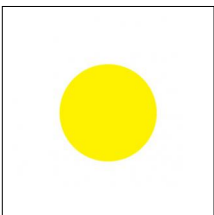

**Code 0.26402.008A - Yellow glass filter 1 mm**

Type: Optical  
Finishing: Yellow

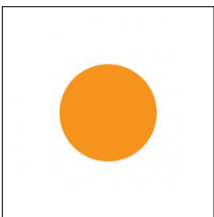

**Code 0.26402.009A - Orange glass filter 1 mm**

Type: Optical  
Finishing: Orange



## Accessories

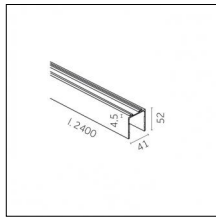
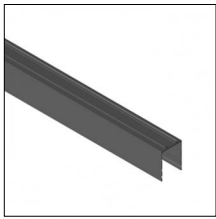

### Code 0.25401.0012 - Surface-mounted rail + connecting piece

Type: Structural  
 Finishing: Embossed matt white (Standard)  
 Description: Length: 2400mm

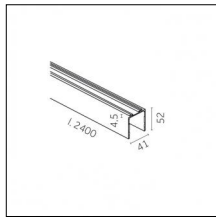
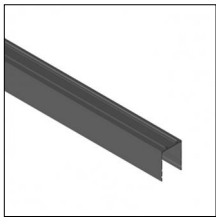

### Code 0.25401.0031 - Surface-mounted rail + connecting piece

Type: Structural  
 Finishing: Embossed matt black (Standard)  
 Description: Length: 2400mm

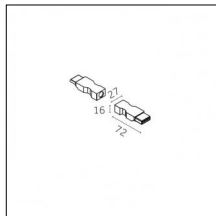
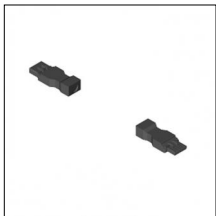

### Code 0.25417.0000 - Connector

Type: Structural  
 Finishing: Without finish / Stainles Steel / Natural aluminium (Standard)  
 Height: 16mm  
 Description: Connector with plug and socket for electric cable with maximum section of 1.5 mm

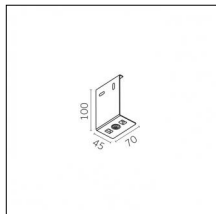

### Code 0.25431.0012 - Concealed mounting rail bracket

Type: Structural  
 Finishing: Embossed matt white (Standard)  
 Length: 70mm Width: 45mm Height: 100mm

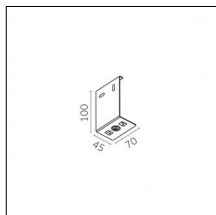

### Code 0.25431.0031 - Concealed mounting rail bracket

Type: Structural  
 Finishing: Embossed matt black (Standard)  
 Length: 70mm Width: 45mm Height: 100mm

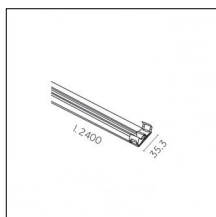

### Code 0.25432.0012 - Mounting rail cover including spring clips

Type: Structural  
 Finishing: Embossed matt white (Standard)  
 Description: Length: 2400mm

## Accessories

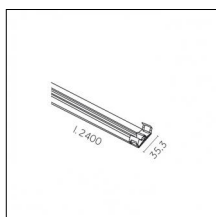

### Code 0.25432.0031 - Mounting rail cover including spring clips

Type: Structural  
 Finishing: Embossed matt black (Standard)  
 Description: Length: 2400mm

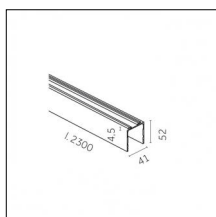
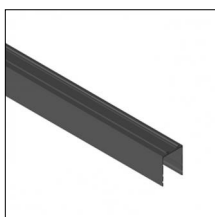

### Code 0.25801.0012 - Surface-mounted rail module

Type: Structural  
 Finishing: Embossed matt white (Standard)  
 Description: Add on to 0.25401.00 for strip configuration for up to 10 Yori luminaires on total section, including mechanical coupler  
 Length: 2300mm

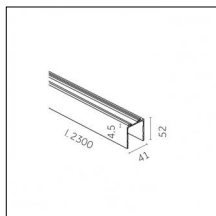
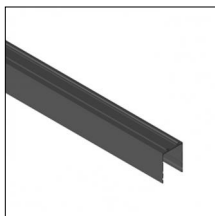

### Code 0.25801.0031 - Surface-mounted rail module

Type: Structural  
 Finishing: Embossed matt black (Standard)  
 Description: Add on to 0.25401.00 for strip configuration for up to 10 Yori luminaires on total section, including mechanical coupler  
 Length: 2300mm

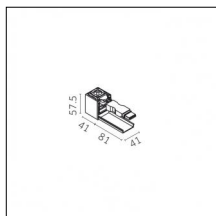
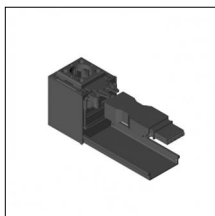

### Code 0.25850.0012 - Live end cap

Type: Structural  
 Finishing: Embossed matt white (Standard)  
 Height: 57.5mm  
 Description: Live end cap (dead end) module composed of: connector, 41 mm pronged base cap, fill-in space cover, 81 mm mounting rail cap

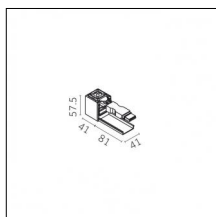
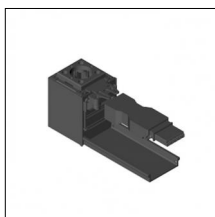

### Code 0.25850.0031 - Live end cap

Type: Structural  
 Finishing: Embossed matt black (Standard)  
 Height: 57.5mm  
 Description: Live end cap (dead end) module composed of: connector, 41 mm pronged base cap, fill-in space cover, 81 mm mounting rail cap

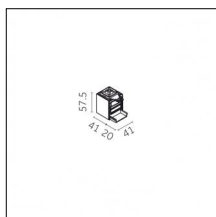
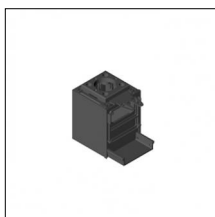

### Code 0.25851.0012 - Terminal end cap

Type: Structural  
 Finishing: Embossed matt white (Standard)  
 Height: 57.5mm  
 Description: Terminal end cap (dead end) module composed of: 41 mm cap, 41 mm pronged base cap, fill-in space cover, 20 mm mounting rail cap

## Accessories

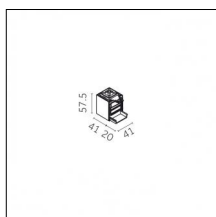
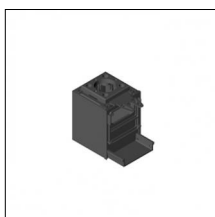

### Code 0.25851.0031 - Terminal end cap

Type: Structural

Finishing: Embossed matt black (Standard)

Height: 57.5mm

Description: Terminal end cap (dead end) module composed of: 41 mm cap, 41 mm pronged base cap, fill-in space cover, 20 mm mounting rail cap

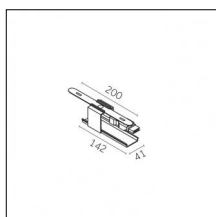
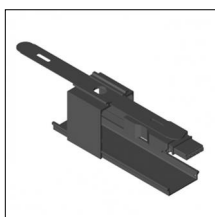

### Code 0.25852.0012 - Centre feed module

Type: Structural

Finishing: Embossed matt white (Standard)

Height: 57.5mm

Description: Centre feed module composed of: central body, mechanical coupler and 142 mm cover

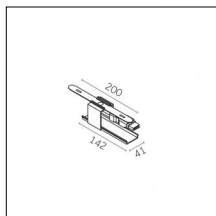
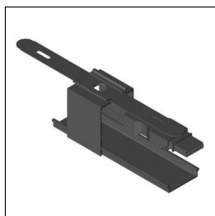

### Code 0.25852.0031 - Centre feed module

Type: Structural

Finishing: Embossed matt black (Standard)

Height: 57.5mm

Description: Centre feed module composed of: central body, mechanical coupler and 142 mm cover

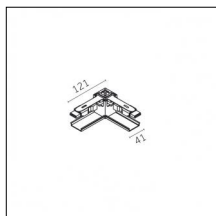
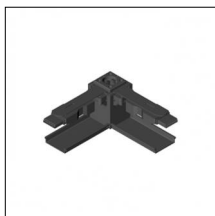

### Code 0.25853.0012 - "L" coupler for surface-mounted rail

Type: Structural

Finishing: Embossed matt white (Standard)

Length: 121mm Width: 41mm Height: 57.5mm

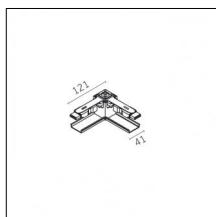

### Code 0.25853.0031 - "L" coupler for surface-mounted rail

Type: Structural

Finishing: Embossed matt black (Standard)

Length: 121mm Width: 41mm Height: 57.5mm

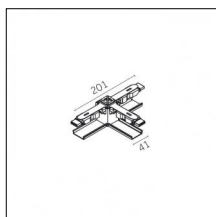

### Code 0.25854.0012 - "T" coupler for surface-mounted rail

Type: Structural

Finishing: Embossed matt white (Standard)

Length: 201mm Width: 41mm Height: 57.5mm

## Accessories

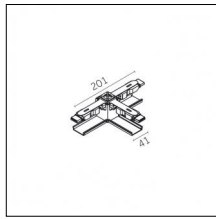
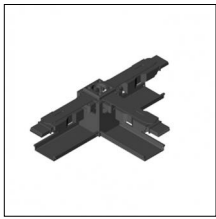

### Code 0.25854.0031 - "T" coupler for surface-mounted rail

Type: Structural  
Finishing: Embossed matt black (Standard)  
Length: 201mm Width: 41mm Height: 57.5mm

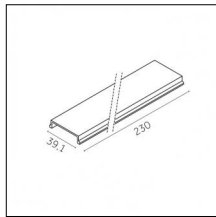

### Code 0.25870.0012 - Hard cover for surface-mounted and suspended mounting rail

Type: Structural  
Finishing: Embossed matt white (Standard)  
Length: 230mm Width: 35.3mm

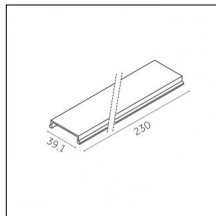

### Code 0.25870.0031 - Hard cover for surface-mounted and suspended mounting rail

Type: Structural  
Finishing: Embossed matt black (Standard)  
Length: 230mm Width: 35.3mm

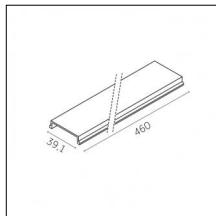

### Code 0.25871.0012 - Hard cover for surface-mounted and suspended mounting rail

Type: Structural  
Finishing: Embossed matt white (Standard)  
Length: 460mm Width: 35.3mm

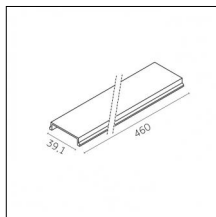

### Code 0.25871.0031 - Hard cover for surface-mounted and suspended mounting rail

Type: Structural  
Finishing: Embossed matt black (Standard)  
Length: 460mm Width: 35.3mm

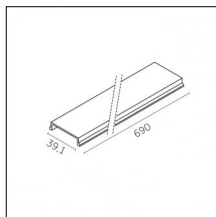

### Code 0.25872.0012 - Hard cover for surface-mounted and suspended mounting rail

Type: Structural  
Finishing: Embossed matt white (Standard)  
Length: 690mm Width: 35.3mm

## Accessories

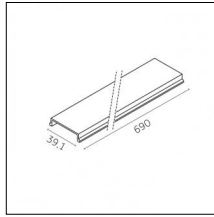

### Code 0.25872.0031 - Hard cover for surface-mounted and suspended mounting rail

Type: Structural  
Finishing: Embossed matt black (Standard)  
Length: 690mm Width: 35.3mm

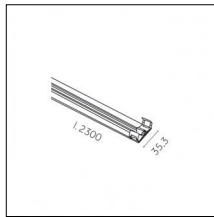

### Code 0.25874.0012 - Mounting rail cover including spring clips length: 2300 mm

Type: Structural  
Finishing: Embossed matt white (Standard)  
Length: 2300mm Width: 35.3mm  
Description: Mounting rail cover including spring clips length: 2300 mm

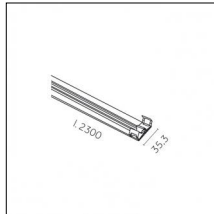

### Code 0.25874.0031 - Mounting rail cover including spring clips length: 2300 mm

Type: Structural  
Finishing: Embossed matt black (Standard)  
Length: 2300mm Width: 35.3mm  
Description: Mounting rail cover including spring clips length: 2300 mm

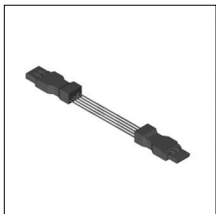

### Code 0.25880.0000 - Pre-wired power cable with plug and socket

Type: Structural  
Finishing: Without finish / Stainles Steel / Natural aluminium (Standard)  
Length: 230mm  
Description:



### Code 0.25881.0000 - Pre-wired power cable with plug and socket

Type: Structural  
Finishing: Without finish / Stainles Steel / Natural aluminium (Standard)  
Length: 460mm

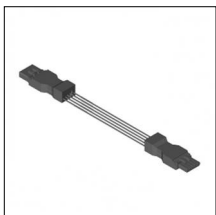

### Code 0.25882.0000 - Pre-wired power cable with plug and socket

Type: Structural  
Finishing: Without finish / Stainles Steel / Natural aluminium (Standard)  
Length: 690mm

## Accessories



### Code 0.26410.0000 - Colored Gel Slides (2 pieces)

Type: Optical  
Finishing: Without finish / Stainles Steel / Natural aluminium (Standard)

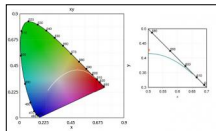
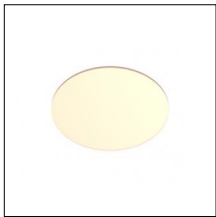

### Code 0.26418.0000 - Selective filter 2700K - 2500K

Type: Optical  
Finishing: Without finish / Stainles Steel / Natural aluminium (Standard)

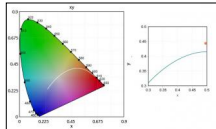
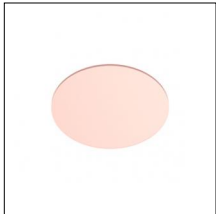

### Code 0.26426.0000 - Selective filter 2700K - 2200K

Type: Optical  
Finishing: Without finish / Stainles Steel / Natural aluminium (Standard)

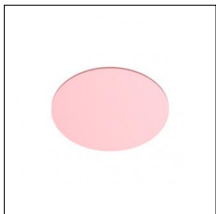

### Code 0.26434.0000 - Selective filter 2700K - 2000K

Type: Optical  
Finishing: Without finish / Stainles Steel / Natural aluminium (Standard)



### Code 0.26442.0000 - Honeycomb dense texture

Type: Optical  
Finishing: Without finish / Stainles Steel / Natural aluminium (Standard)



### Code 0.26450.0000 - Honeycomb wide texture

Type: Optical  
Finishing: Without finish / Stainles Steel / Natural aluminium (Standard)

## Accessories

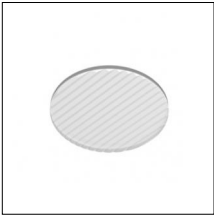

### Code 0.26457.0000 - Ribbed glass

Type: Optical

Finishing: Without finish / Stainles Steel / Natural aluminium (Standard)

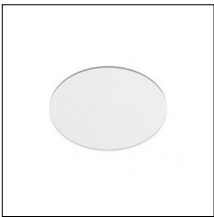

### Code 0.26462.0000 - Opal lens

Type: Optical

Finishing: Without finish / Stainles Steel / Natural aluminium (Standard)

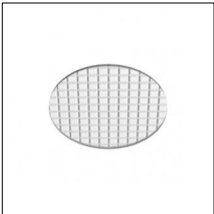

### Code 0.26470.0000 - Diffusive lens

Type: Optical

Finishing: Without finish / Stainles Steel / Natural aluminium (Standard)

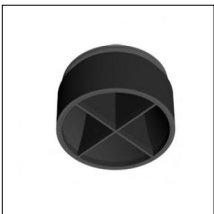

### Code 0.26477.0000 - Cross blade louver

Type: Optical

Finishing: Without finish / Stainles Steel / Natural aluminium (Standard)

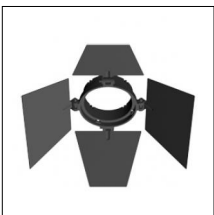

### Code 0.26485.0000 - Barn doors

Type: Optical

Finishing: Without finish / Stainles Steel / Natural aluminium (Standard)

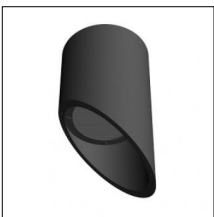

### Code 0.26489.0012 - Cone 45 ° wall washer

Type: Optical

Finishing: Embossed matt white (Standard)

## Accessories

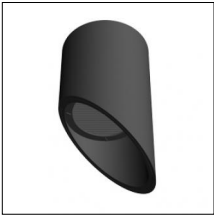

### Code 0.26489.0031 - Cone 45 ° wall washer

Type: Optical  
Finishing: Embossed matt black (Standard)

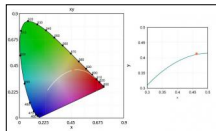

### Code 0.26559.0000 - Selective filter 3000K-2700K

Type: Optical  
Finishing: Without finish / Stainles Steel / Natural aluminium (Standard)

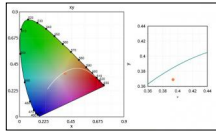
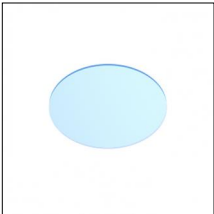

### Code 0.26567.0000 - Selective filter 3000K-3600K

Type: Optical  
Finishing: Without finish / Stainles Steel / Natural aluminium (Standard)

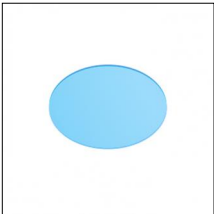

### Code 0.26575.0000 - Selective filter 3000K-4000K

Type: Optical  
Finishing: Without finish / Stainles Steel / Natural aluminium (Standard)



Indoor | Linear systems and solutions for coves | Yori Channel Arm

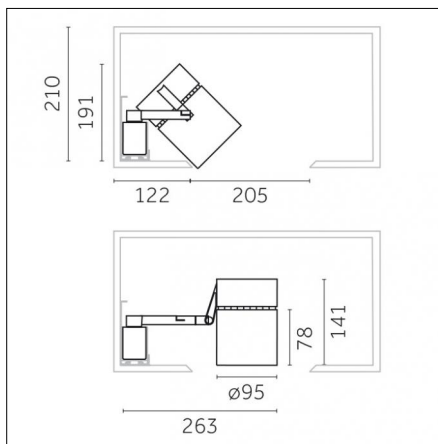

Very narrow 10°

31

IP20



Risk 1

850°



**Code 0.RM23B.HC31**

### Light source features

**Number of light sources:** 1

**Source type:** LED HC

**Watt:** 12W

**Lm:** 1323lm

**Lm/W:** 110lm/W

**Kelvin/CRI:** 3000K / >98

**SDCM/L90 B10:** < 2 / 50000

### Electrical features

**Driver included:** YES

**Driver position:** integrated

**Driver type:** On-Off

**Isolation class:** Class I

### Optical features

**Beam angle:** 10°

**Optical type, adjustability:** Adjustable

**Interchangeable optic (IOS):** YES

### Physical features

**Material:** Die-cast aluminium

**Mounting:** Surface mounted

**Fixing:** Ceiling

**Finishing:** Embossed matt black (Standard)

**Weight:** 1.4Kg

### Notes:

The lighting body is fitted with a 4-point articulated arm: Adapter: +/- 68° in the vertical axis First articulation point: +/- 90° in the vertical axis Second articulation point: 45° in the horizontal axis Projector head: 90° in the horizontal axis

Luminaire constructed in conformity with Directives 2014/35/EU (LV), 2014/30/EU (EMC), 2009/125/EC (Ecodesign) with Regulations (EC) No 245/2009, (EU) No 347/2010 and (EU) 2015/1428 (for luminaires with fluorescent and metal halide lamps only), 2009/125/EC (Ecodesign) with Regulations (EU) No 1194/2012 and 2015/1428 (for LED luminaires only), 2011/65/EU (RoHS 2) and 2012/19/EU (WEEE).

**Reggiani SPA Illuminazione**

Viale Monza, 16 20845 Sovico (MB) Italy  
Tel. (+39) 039 2071.1 fax (+39) 039 2071 999

www.reggiani.net  
contact@reggiani.net

## Photometries

H [m]	D C0 [m]	Eav [lux]	Emax [lux]
1.00	0.18	14599	22753
2.00	0.36	3650	5688
3.00	0.54	1622	2528
4.00	0.72	912	1422
5.00	0.90	584	910

— C0 10.3°

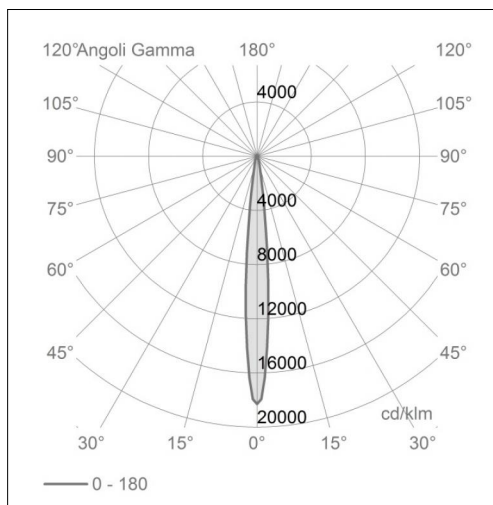

0\_RM23B\_HC\_31.ies  
0\_RM23B\_HC\_31.LDT

## Specifications text

### YORI

Track, channel, recessed and surface mounting fixture. Symmetrical output. Available for LED and metal halide lamps. Die-cast aluminium body. Interchangeable IOS Ø 50mm (LL1) and Ø 80mm (LL2) reflectors in polycarbonate stabilised up to 140° with highly reflective metal coating - exclusive anti-scratch treatment with surface vitrification for LED lamps. Interchangeable IOS Ø 80mm reflectors in 99.99% pure aluminium, with bayonet fitting for metal halide lamps. Anti-static polycarbonate protective screen with a high transmission index (97%); transparent for very narrow light beams, satin for narrow, medium and wide beams and satin/prismatic for the Mira version; anti-yellowing, stabilised against UV rays, resistant to 850° incandescent wire test, self-extinguishing V0; tempered protective glass for IOS reflectors for metal halide lamps Spot adjustable 0° to 90° vertically and 356° horizontally; integrated plastic no-glare screen; recessed optics for improved visual comfort; mounts to false ceilings with the innovative ClikFix one-way spring system (for recessed, semi-recessed and surface mounted versions); drilled bezel for fine mortaring with 0.7 mm trimless bezel thickness for perfect plastering (recessed version); special perforated steel panel maximises heat dispersal outwards (recessed version); vertical slide for moving the luminaire outwards (recessed version); grub screw for locking the adjustment (recessed version); mechanical/electrical connector with m/f connectors (channel version); up to 10 units can be connected in line with a single power supply (channel version); articulated boom for orienting the fixture (for coves, false ceiling and surround versions); available as pre-assembled KIT version with 2, 3 and 4 fixtures for channel, surface and trimless mounting. Anti-yellowing epoxy powder coating, stabilised against UV rays. Product available with the following finishes: matt embossed white 12, matt embossed black 31. Passive heat dissipation via optimised fixture casing construction, which uses the heat conductivity of the metal and convective currents. Available with LED ON/OFF driver, DIMM 1-10V, PHASE CUTTING and DALI 220/240V VAC 50/60 Hz. Electronic driver for LED lamps, electronic power supply for metal halide lamps. Driver/power supply included in package. Isolation class II and III. IP20. The product can be equipped with: cross grille, no-glare honeycomb grille and UV, IR, dichroic and selective filters for food applications. Emergency unit (3 hour) available as accessory equipment. Fixture built in compliance with Standard EN 60598-1 and amendments and EC Directives 2006/95/CE (low voltage), 2004/108/CE (EMC), 2009/125/CE (Ecodesign), 2002/96/CE (RAEE), 2011/65/CE (RoHS).

Luminaire constructed in conformity with Directives 2014/35/EU (LV), 2014/30/EU (EMC), 2009/125/EC (Ecodesign) with Regulations (EC) No 245/2009, (EU) No 347/2010 and (EU) 2015/1428 (for luminaires with fluorescent and metal halide lamps only), 2009/125/EC (Ecodesign) with Regulations (EU) No 1194/2012 and 2015/1428 (for LED luminaires only), 2011/65/EU (RoHS 2) and 2012/19/EU (WEEE).

## Optics

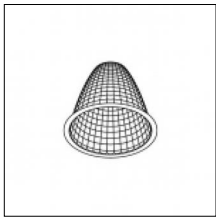

**Code 0.35155.0000 - Ø95mm performance optic 10°-12° - LED**

Finishing:  
Description:



Very narrow 10°

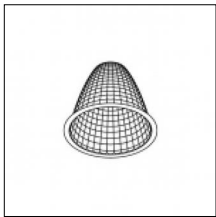

**Code 0.35156.0000 - Ø95mm performance optic 20° - LED**

Finishing:  
Description:



Medium 20°

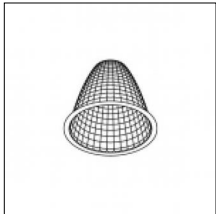

**Code 0.35157.0000 - Ø95mm performance optic 31° - LED**

Finishing:  
Description:



Medium 31°

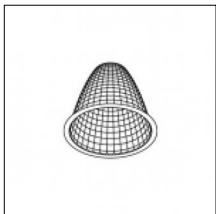

**Code 0.35158.0000 - Ø95mm performance optic 40° - LED**

Finishing:  
Description:



Medium-wide 40°

## Accessories

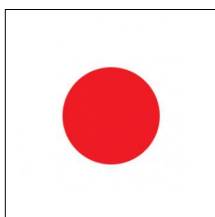

**Code 0.26407.004A - Red glass filter 1 mm**

Type: Optical  
Finishing: Red

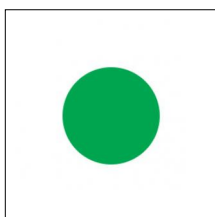

**Code 0.26407.005A - Green glass filter 1 mm**

Type: Optical  
Finishing: Green

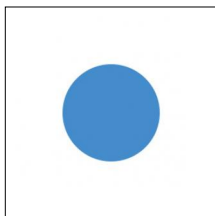

**Code 0.26407.006A - Blue glass filter 1 mm**

Type: Optical  
Finishing: Blue

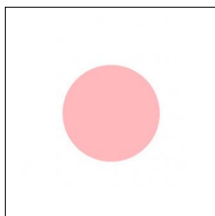

**Code 0.26407.007A - Pink glass filter 1 mm**

Type: Optical  
Finishing: Pink

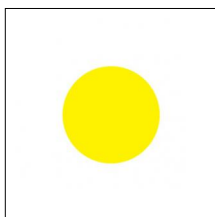

**Code 0.26407.008A - Yellow glass filter 1 mm**

Type: Optical  
Finishing: Yellow

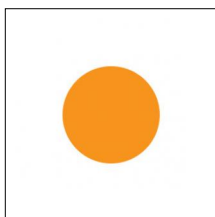

**Code 0.26407.009A - Orange glass filter 1 mm**

Type: Optical  
Finishing: Orange

## Accessories

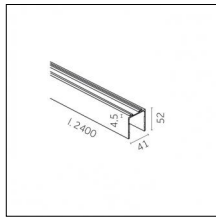
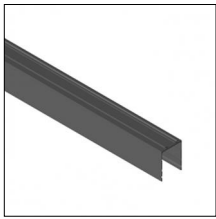

### Code 0.25401.0012 - Surface-mounted rail + connecting piece

Type: Structural  
 Finishing: Embossed matt white (Standard)  
 Description: Length: 2400mm

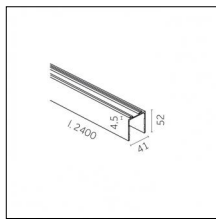
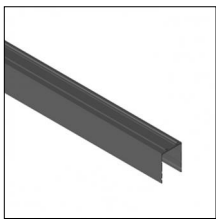

### Code 0.25401.0031 - Surface-mounted rail + connecting piece

Type: Structural  
 Finishing: Embossed matt black (Standard)  
 Description: Length: 2400mm

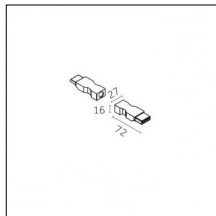
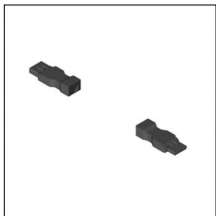

### Code 0.25417.0000 - Connector

Type: Structural  
 Finishing: Without finish / Stainles Steel / Natural aluminium (Standard)  
 Height: 16mm  
 Description: Connector with plug and socket for electric cable with maximum section of 1.5 mm

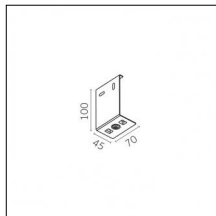

### Code 0.25431.0012 - Concealed mounting rail bracket

Type: Structural  
 Finishing: Embossed matt white (Standard)  
 Length: 70mm Width: 45mm Height: 100mm

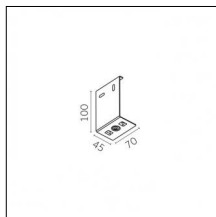

### Code 0.25431.0031 - Concealed mounting rail bracket

Type: Structural  
 Finishing: Embossed matt black (Standard)  
 Length: 70mm Width: 45mm Height: 100mm

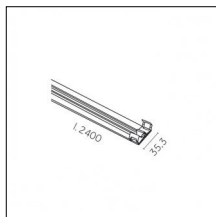

### Code 0.25432.0012 - Mounting rail cover including spring clips

Type: Structural  
 Finishing: Embossed matt white (Standard)  
 Description: Length: 2400mm

## Accessories

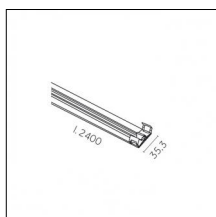

### Code 0.25432.0031 - Mounting rail cover including spring clips

Type: Structural  
 Finishing: Embossed matt black (Standard)  
 Description: Length: 2400mm

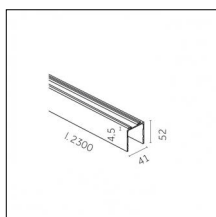
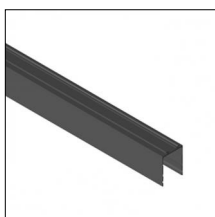

### Code 0.25801.0012 - Surface-mounted rail module

Type: Structural  
 Finishing: Embossed matt white (Standard)  
 Description: Add on to 0.25401.00 for strip configuration for up to 10 Yori luminaires on total section, including mechanical coupler  
 Length: 2300mm

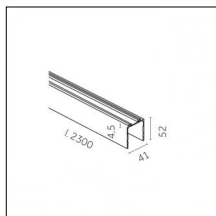
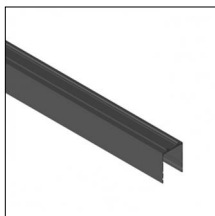

### Code 0.25801.0031 - Surface-mounted rail module

Type: Structural  
 Finishing: Embossed matt black (Standard)  
 Description: Add on to 0.25401.00 for strip configuration for up to 10 Yori luminaires on total section, including mechanical coupler  
 Length: 2300mm

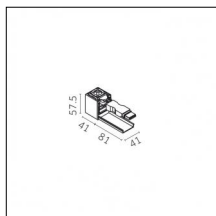
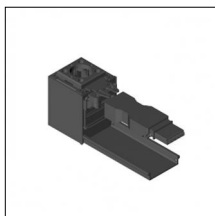

### Code 0.25850.0012 - Live end cap

Type: Structural  
 Finishing: Embossed matt white (Standard)  
 Height: 57.5mm  
 Description: Live end cap (dead end) module composed of: connector, 41 mm pronged base cap, fill-in space cover, 81 mm mounting rail cap

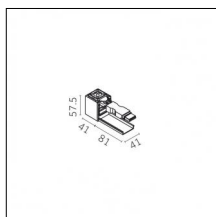
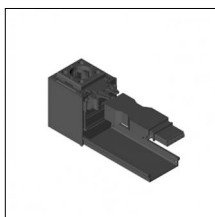

### Code 0.25850.0031 - Live end cap

Type: Structural  
 Finishing: Embossed matt black (Standard)  
 Height: 57.5mm  
 Description: Live end cap (dead end) module composed of: connector, 41 mm pronged base cap, fill-in space cover, 81 mm mounting rail cap

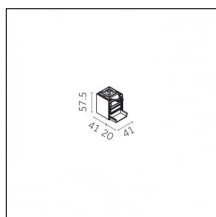
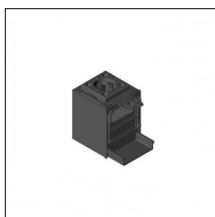

### Code 0.25851.0012 - Terminal end cap

Type: Structural  
 Finishing: Embossed matt white (Standard)  
 Height: 57.5mm  
 Description: Terminal end cap (dead end) module composed of: 41 mm cap, 41 mm pronged base cap, fill-in space cover, 20 mm mounting rail cap

## Accessories

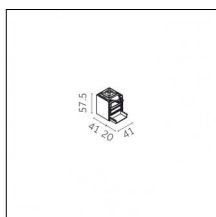
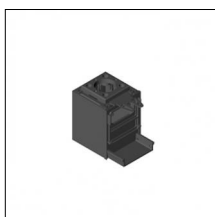

### Code 0.25851.0031 - Terminal end cap

Type: Structural

Finishing: Embossed matt black (Standard)

Height: 57.5mm

Description: Terminal end cap (dead end) module composed of: 41 mm cap, 41 mm pronged base cap, fill-in space cover, 20 mm mounting rail cap

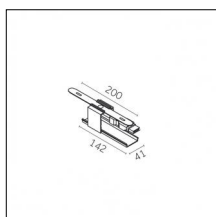
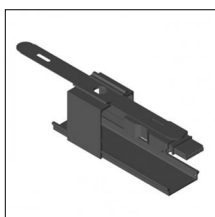

### Code 0.25852.0012 - Centre feed module

Type: Structural

Finishing: Embossed matt white (Standard)

Height: 57.5mm

Description: Centre feed module composed of: central body, mechanical coupler and 142 mm cover

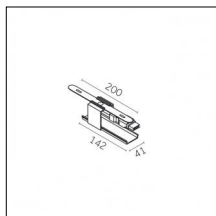
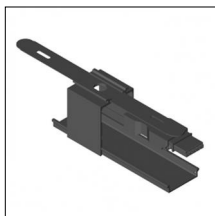

### Code 0.25852.0031 - Centre feed module

Type: Structural

Finishing: Embossed matt black (Standard)

Height: 57.5mm

Description: Centre feed module composed of: central body, mechanical coupler and 142 mm cover

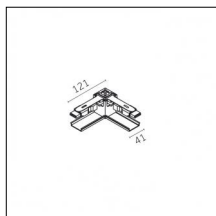

### Code 0.25853.0012 - "L" coupler for surface-mounted rail

Type: Structural

Finishing: Embossed matt white (Standard)

Length: 121mm Width: 41mm Height: 57.5mm

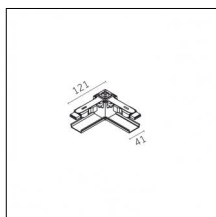
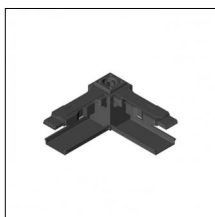

### Code 0.25853.0031 - "L" coupler for surface-mounted rail

Type: Structural

Finishing: Embossed matt black (Standard)

Length: 121mm Width: 41mm Height: 57.5mm

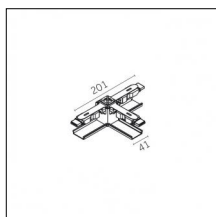

### Code 0.25854.0012 - "T" coupler for surface-mounted rail

Type: Structural

Finishing: Embossed matt white (Standard)

Length: 201mm Width: 41mm Height: 57.5mm

## Accessories

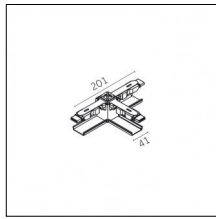
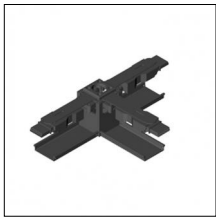

### Code 0.25854.0031 - "T" coupler for surface-mounted rail

Type: Structural  
Finishing: Embossed matt black (Standard)  
Length: 201mm Width: 41mm Height: 57.5mm

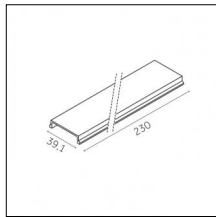

### Code 0.25870.0012 - Hard cover for surface-mounted and suspended mounting rail

Type: Structural  
Finishing: Embossed matt white (Standard)  
Length: 230mm Width: 35.3mm

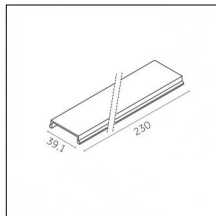

### Code 0.25870.0031 - Hard cover for surface-mounted and suspended mounting rail

Type: Structural  
Finishing: Embossed matt black (Standard)  
Length: 230mm Width: 35.3mm

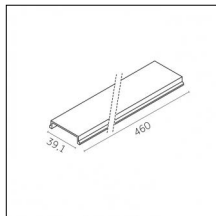

### Code 0.25871.0012 - Hard cover for surface-mounted and suspended mounting rail

Type: Structural  
Finishing: Embossed matt white (Standard)  
Length: 460mm Width: 35.3mm

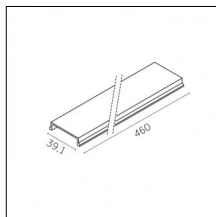

### Code 0.25871.0031 - Hard cover for surface-mounted and suspended mounting rail

Type: Structural  
Finishing: Embossed matt black (Standard)  
Length: 460mm Width: 35.3mm

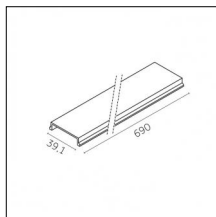

### Code 0.25872.0012 - Hard cover for surface-mounted and suspended mounting rail

Type: Structural  
Finishing: Embossed matt white (Standard)  
Length: 690mm Width: 35.3mm



## Accessories

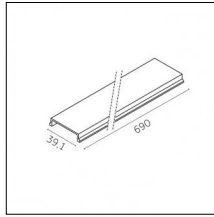

### Code 0.25872.0031 - Hard cover for surface-mounted and suspended mounting rail

Type: Structural  
Finishing: Embossed matt black (Standard)  
Length: 690mm Width: 35.3mm

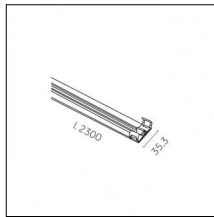

### Code 0.25874.0012 - Mounting rail cover including spring clips length: 2300 mm

Type: Structural  
Finishing: Embossed matt white (Standard)  
Length: 2300mm Width: 35.3mm  
Description: Mounting rail cover including spring clips length: 2300 mm

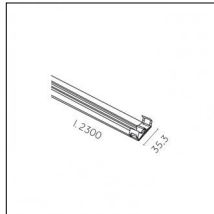

### Code 0.25874.0031 - Mounting rail cover including spring clips length: 2300 mm

Type: Structural  
Finishing: Embossed matt black (Standard)  
Length: 2300mm Width: 35.3mm  
Description: Mounting rail cover including spring clips length: 2300 mm

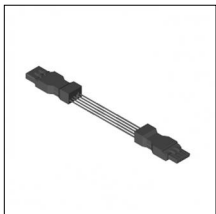

### Code 0.25880.0000 - Pre-wired power cable with plug and socket

Type: Structural  
Finishing: Without finish / Stainles Steel / Natural aluminium (Standard)  
Length: 230mm  
Description:

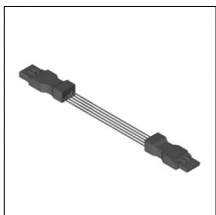

### Code 0.25881.0000 - Pre-wired power cable with plug and socket

Type: Structural  
Finishing: Without finish / Stainles Steel / Natural aluminium (Standard)  
Length: 460mm

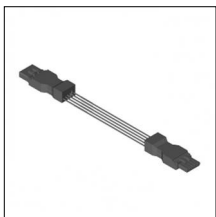

### Code 0.25882.0000 - Pre-wired power cable with plug and socket

Type: Structural  
Finishing: Without finish / Stainles Steel / Natural aluminium (Standard)  
Length: 690mm

## Accessories



### Code 0.26415.0000 - Colored Gel Slides (2 pieces)

Type: Optical  
Finishing: Without finish / Stainles Steel / Natural aluminium (Standard)

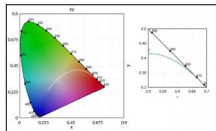
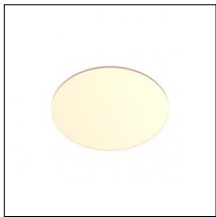

### Code 0.26423.0000 - Selective filter 2700K - 2500K

Type: Optical  
Finishing: Without finish / Stainles Steel / Natural aluminium (Standard)

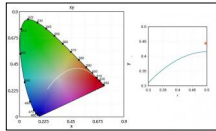
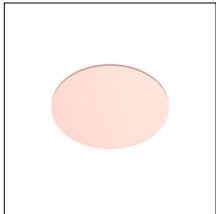

### Code 0.26431.0000 - Selective filter 2700K - 2200K

Type: Optical  
Finishing: Without finish / Stainles Steel / Natural aluminium (Standard)

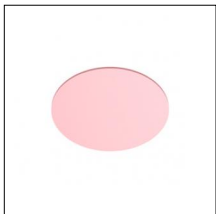

### Code 0.26439.0000 - Selective filter 2700K - 2000K

Type: Optical  
Finishing: Without finish / Stainles Steel / Natural aluminium (Standard)

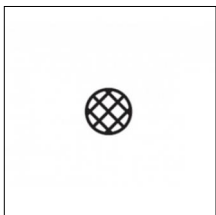

### Code 0.26447.0000 - Honeycomb dense texture

Type: Optical  
Finishing: Without finish / Stainles Steel / Natural aluminium (Standard)

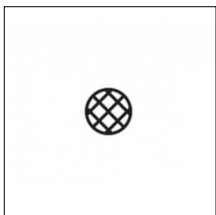

### Code 0.26455.0000 - Honeycomb wide texture

Type: Optical  
Finishing: Without finish / Stainles Steel / Natural aluminium (Standard)

## Accessories

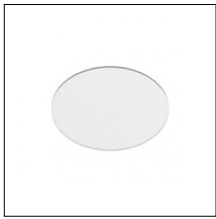

### Code 0.26467.0000 - Opal lens

Type: Optical

Finishing: Without finish / Stainles Steel / Natural aluminium (Standard)

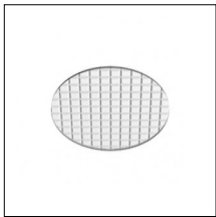

### Code 0.26475.0000 - Diffusive lens

Type: Optical

Finishing: Without finish / Stainles Steel / Natural aluminium (Standard)

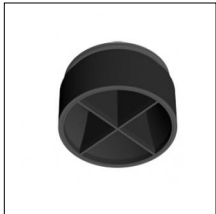

### Code 0.26483.0000 - Cross blade louver

Type: Optical

Finishing: Without finish / Stainles Steel / Natural aluminium (Standard)

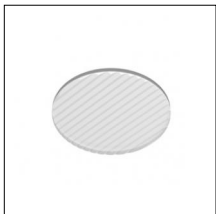

### Code 0.26495.0000 - Ribbed glass

Type: Optical

Finishing: Without finish / Stainles Steel / Natural aluminium (Standard)



### Code 0.26499.0012 - Cone 45 ° wall washer

Type: Optical

Finishing: Embossed matt white (Standard)



### Code 0.26499.0031 - Cone 45 ° wall washer

Type: Optical

Finishing: Embossed matt black (Standard)

## Accessories

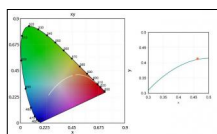
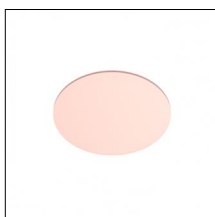

**Code 0.26564.0000 - Selective filter 3000K-2700K**

Type: Optical

Finishing: Without finish / Stainles Steel / Natural aluminium (Standard)

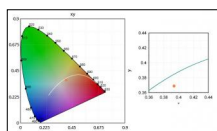
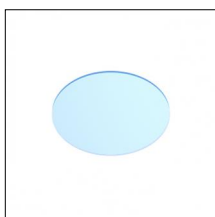

**Code 0.26572.0000 - Selective filter 3000K-3600K**

Type: Optical

Finishing: Without finish / Stainles Steel / Natural aluminium (Standard)

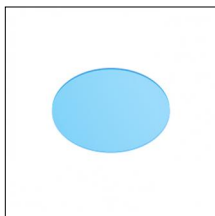

**Code 0.26580.0000 - Selective filter 3000K-4000K**

Type: Optical

Finishing: Without finish / Stainles Steel / Natural aluminium (Standard)

Indoor | Linear systems and solutions for coves | Yori Channel Arm

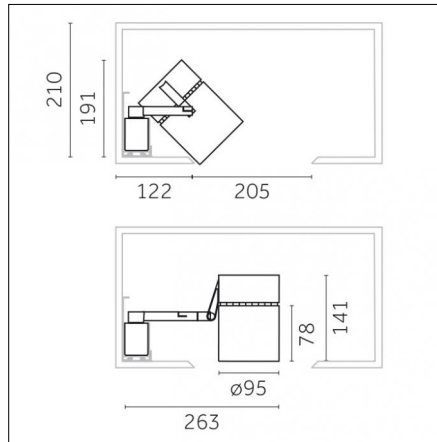

Very narrow 7°

12

IP20



Risk 1

850°



### Code 0.KM14A.HC12

#### Light source features

**Number of light sources:** 1

**Source type:** LED HC

**Watt:** 17W

**Lm:** 1700lm

**Lm/W:** 100lm/W

**Kelvin/CRI:** 3000K / >98

**SDCM/L90 B10:** < 2 / 50000

#### Electrical features

**Driver included:** YES

**Driver position:** integrated

**Driver type:** On-Off

**Isolation class:** Class I

#### Optical features

**Beam angle:** 7°

**Optical type, adjustability:** Adjustable

**Interchangeable optic (IOS):** YES

#### Physical features

**Material:** Die-cast aluminium

**Mounting:** Surface mounted

**Fixing:** Ceiling

**Finishing:** Embossed matt white (Standard)

**Weight:** 1.4Kg

#### Notes:

The lighting body is fitted with a 4-point articulated arm: Adapter: +/- 68° in the vertical axis First articulation point: +/- 90° in the vertical axis Second articulation point: 45° in the horizontal axis Projector head: 90° in the horizontal axis

Luminaire constructed in conformity with Directives 2014/35/EU (LV), 2014/30/EU (EMC), 2009/125/EC (Ecodesign) with Regulations (EC) No 245/2009, (EU) No 347/2010 and (EU) 2015/1428 (for luminaires with fluorescent and metal halide lamps only), 2009/125/EC (Ecodesign) with Regulations (EU) No 1194/2012 and 2015/1428 (for LED luminaires only), 2011/65/EU (RoHS 2) and 2012/19/EU (WEEE).

#### Reggiani SPA Illuminazione

Viale Monza, 16 20845 Sovico (MB) Italy  
Tel. (+39) 039 2071.1 fax (+39) 039 2071 999

www.reggiani.net  
contact@reggiani.net

## Photometries



## Specifications text

**YORI**  
Track, channel, recessed and surface mounting fixture. Symmetrical output. Available for LED and metal halide lamps. Die-cast aluminium body. Interchangeable IOS Ø 50mm (LL1) and Ø 80mm (LL2) reflectors in polycarbonate stabilised up to 140° with highly reflective metal coating - exclusive anti-scratch treatment with surface vitrification for LED lamps. Interchangeable IOS Ø 80mm reflectors in 99.99% pure aluminium, with bayonet fitting for metal halide lamps. Anti-static polycarbonate protective screen with a high transmission index (97%); transparent for very narrow light beams, satin for narrow, medium and wide beams and satin/prismatic for the Mira version; anti-yellowing, stabilised against UV rays, resistant to 850° incandescent wire test, self-extinguishing V0; tempered protective glass for IOS reflectors for metal halide lamps Spot adjustable 0° to 90° vertically and 356° horizontally; integrated plastic no-glare screen; recessed optics for improved visual comfort; mounts to false ceilings with the innovative KlikFix one-way spring system (for recessed, semi-recessed and surface mounted versions); drilled bezel for fine mortaring with 0.7 mm trimless bezel thickness for perfect plastering (recessed version); special perforated steel panel maximises heat dispersal outwards (recessed version); vertical slide for moving the luminaire outwards (recessed version); grub screw for locking the adjustment (recessed version); mechanical/electrical connector with m/f connectors (channel version); up to 10 units can be connected in line with a single power supply (channel version); articulated boom for orienting the fixture (for coves, false ceiling and surround versions); available as pre-assembled KIT version with 2, 3 and 4 fixtures for channel, surface and trimless mounting. Anti-yellowing epoxy powder coating, stabilised against UV rays. Product available with the following finishes: matt embossed white 12, matt embossed black 31. Passive heat dissipation via optimised fixture casing construction, which uses the heat conductivity of the metal and convective currents. Available with LED ON/OFF driver, DIMM 1-10V, PHASE CUTTING and DALI 220/240V VAC 50/60 Hz. Electronic driver for LED lamps, electronic power supply for metal halide lamps. Driver/power supply included in package. Isolation class II and III. IP20. The product can be equipped with: cross grille, no-glare honeycomb grille and UV, IR, dichroic and selective filters for food applications. Emergency unit (3 hour) available as accessory equipment. Fixture built in compliance with Standard EN 60598-1 and amendments and EC Directives 2006/95/CE (low voltage), 2004/108/CE (EMC), 2009/125/CE (Ecodesign), 2002/96/CE (RAEE), 2011/65/CE (RoHS).

Luminaire constructed in conformity with Directives 2014/35/EU (LV), 2014/30/EU (EMC), 2009/125/EC (Ecodesign) with Regulations (EC) No 245/2009, (EU) No 347/2010 and (EU) 2015/1428 (for luminaires with fluorescent and metal halide lamps only), 2009/125/EC (Ecodesign) with Regulations (EU) No 1194/2012 and 2015/1428 (for LED luminaires only), 2011/65/EU (RoHS 2) and 2012/19/EU (WEEE).

## Optics

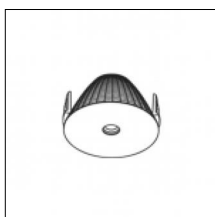

**Code 0.35135.0000 - Ø95mm precision optic 12° - LED**

Finishing:  
Description:



Narrow 12°

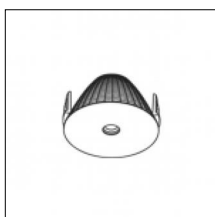

**Code 0.35136.0000 - Ø95mm precision optic 24° - LED**

Finishing:  
Description:



Medium 24°

## Accessories

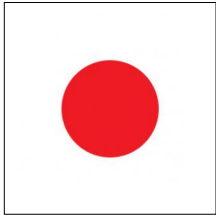

**Code 0.26406.004A - Red glass filter 1 mm**

Type: Optical  
Finishing: Red

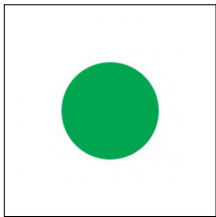

**Code 0.26406.005A - Green glass filter 1 mm**

Type: Optical  
Finishing: Green

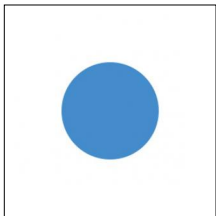

**Code 0.26406.006A - Blue glass filter 1 mm**

Type: Optical  
Finishing: Blue

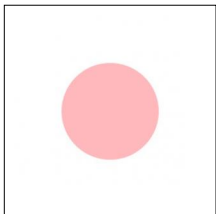

**Code 0.26406.007A - Pink glass filter 1 mm**

Type: Optical  
Finishing: Pink

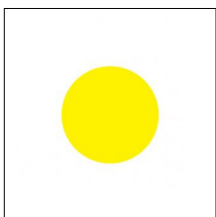

**Code 0.26406.008A - Yellow glass filter 1 mm**

Type: Optical  
Finishing: Yellow

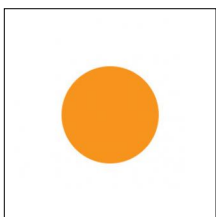

**Code 0.26406.009A - Orange glass filter 1 mm**

Type: Optical  
Finishing: Orange



## Accessories

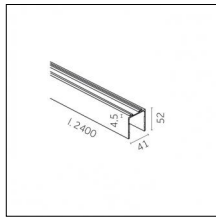
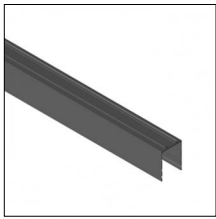

### Code 0.25401.0012 - Surface-mounted rail + connecting piece

Type: Structural  
 Finishing: Embossed matt white (Standard)  
 Description: Length: 2400mm

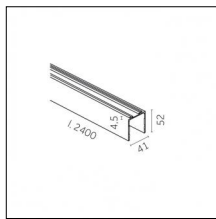
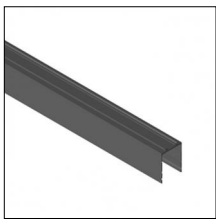

### Code 0.25401.0031 - Surface-mounted rail + connecting piece

Type: Structural  
 Finishing: Embossed matt black (Standard)  
 Description: Length: 2400mm

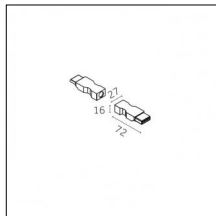
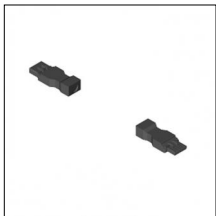

### Code 0.25417.0000 - Connector

Type: Structural  
 Finishing: Without finish / Stainles Steel / Natural aluminium (Standard)  
 Height: 16mm  
 Description: Connector with plug and socket for electric cable with maximum section of 1.5 mm

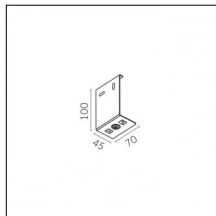

### Code 0.25431.0012 - Concealed mounting rail bracket

Type: Structural  
 Finishing: Embossed matt white (Standard)  
 Length: 70mm Width: 45mm Height: 100mm

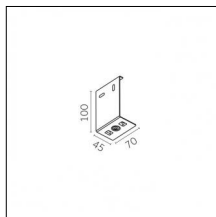

### Code 0.25431.0031 - Concealed mounting rail bracket

Type: Structural  
 Finishing: Embossed matt black (Standard)  
 Length: 70mm Width: 45mm Height: 100mm

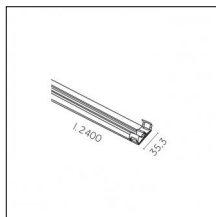

### Code 0.25432.0012 - Mounting rail cover including spring clips

Type: Structural  
 Finishing: Embossed matt white (Standard)  
 Description: Length: 2400mm

Luminaire constructed in conformity with Directives 2014/35/EU (LV), 2014/30/EU (EMC), 2009/125/EC (Ecodesign) with Regulations (EC) No 245/2009, (EU) No 347/2010 and (EU) 2015/1428 (for luminaires with fluorescent and metal halide lamps only), 2009/125/EC (Ecodesign) with Regulations (EU) No 1194/2012 and 2015/1428 (for LED luminaires only), 2011/65/EU (RoHS 2) and 2012/19/EU (WEEE).

## Accessories

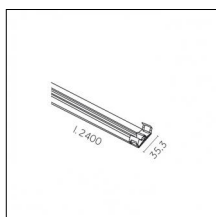

### Code 0.25432.0031 - Mounting rail cover including spring clips

Type: Structural  
 Finishing: Embossed matt black (Standard)  
 Description: Length: 2400mm

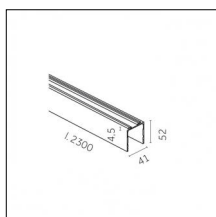
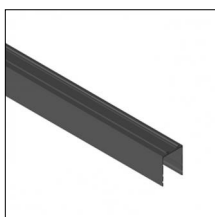

### Code 0.25801.0012 - Surface-mounted rail module

Type: Structural  
 Finishing: Embossed matt white (Standard)  
 Description: Add on to 0.25401.00 for strip configuration for up to 10 Yori luminaires on total section, including mechanical coupler  
 Length: 2300mm

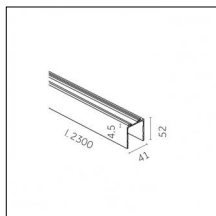
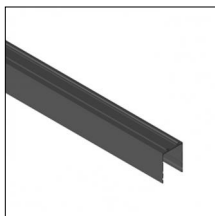

### Code 0.25801.0031 - Surface-mounted rail module

Type: Structural  
 Finishing: Embossed matt black (Standard)  
 Description: Add on to 0.25401.00 for strip configuration for up to 10 Yori luminaires on total section, including mechanical coupler  
 Length: 2300mm

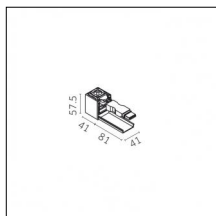
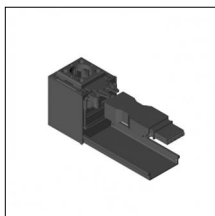

### Code 0.25850.0012 - Live end cap

Type: Structural  
 Finishing: Embossed matt white (Standard)  
 Height: 57.5mm  
 Description: Live end cap (dead end) module composed of: connector, 41 mm pronged base cap, fill-in space cover, 81 mm mounting rail cap

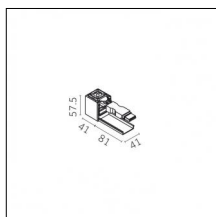
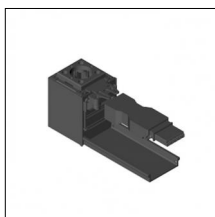

### Code 0.25850.0031 - Live end cap

Type: Structural  
 Finishing: Embossed matt black (Standard)  
 Height: 57.5mm  
 Description: Live end cap (dead end) module composed of: connector, 41 mm pronged base cap, fill-in space cover, 81 mm mounting rail cap

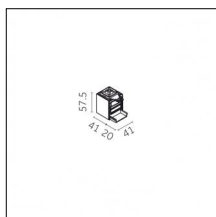
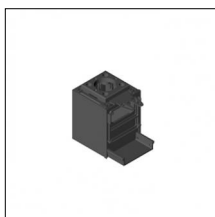

### Code 0.25851.0012 - Terminal end cap

Type: Structural  
 Finishing: Embossed matt white (Standard)  
 Height: 57.5mm  
 Description: Terminal end cap (dead end) module composed of: 41 mm cap, 41 mm pronged base cap, fill-in space cover, 20 mm mounting rail cap

## Accessories

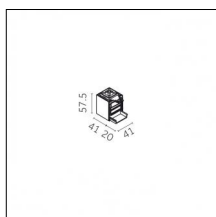
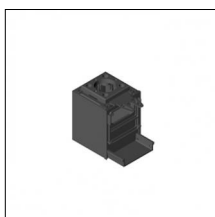

### Code 0.25851.0031 - Terminal end cap

Type: Structural

Finishing: Embossed matt black (Standard)

Height: 57.5mm

Description: Terminal end cap (dead end) module composed of: 41 mm cap, 41 mm pronged base cap, fill-in space cover, 20 mm mounting rail cap

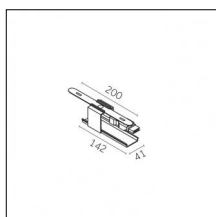
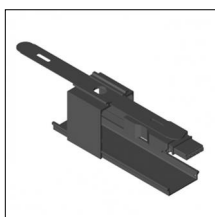

### Code 0.25852.0012 - Centre feed module

Type: Structural

Finishing: Embossed matt white (Standard)

Height: 57.5mm

Description: Centre feed module composed of: central body, mechanical coupler and 142 mm cover

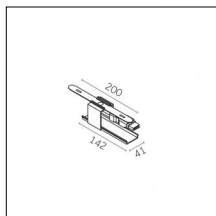
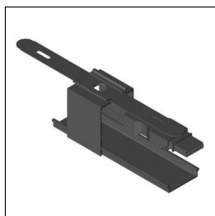

### Code 0.25852.0031 - Centre feed module

Type: Structural

Finishing: Embossed matt black (Standard)

Height: 57.5mm

Description: Centre feed module composed of: central body, mechanical coupler and 142 mm cover

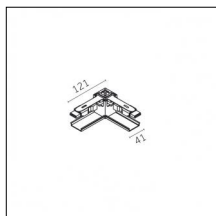
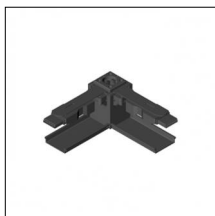

### Code 0.25853.0012 - "L" coupler for surface-mounted rail

Type: Structural

Finishing: Embossed matt white (Standard)

Length: 121mm Width: 41mm Height: 57.5mm

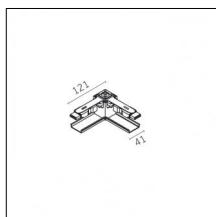

### Code 0.25853.0031 - "L" coupler for surface-mounted rail

Type: Structural

Finishing: Embossed matt black (Standard)

Length: 121mm Width: 41mm Height: 57.5mm

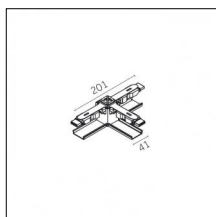

### Code 0.25854.0012 - "T" coupler for surface-mounted rail

Type: Structural

Finishing: Embossed matt white (Standard)

Length: 201mm Width: 41mm Height: 57.5mm

## Accessories

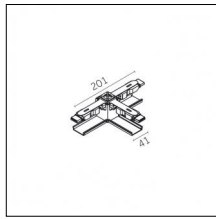
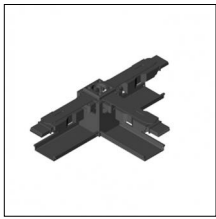

### Code 0.25854.0031 - "T" coupler for surface-mounted rail

Type: Structural  
Finishing: Embossed matt black (Standard)  
Length: 201mm Width: 41mm Height: 57.5mm

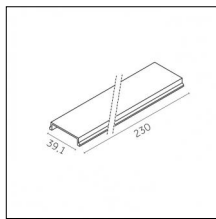

### Code 0.25870.0012 - Hard cover for surface-mounted and suspended mounting rail

Type: Structural  
Finishing: Embossed matt white (Standard)  
Length: 230mm Width: 35.3mm

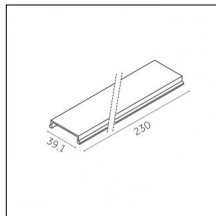

### Code 0.25870.0031 - Hard cover for surface-mounted and suspended mounting rail

Type: Structural  
Finishing: Embossed matt black (Standard)  
Length: 230mm Width: 35.3mm

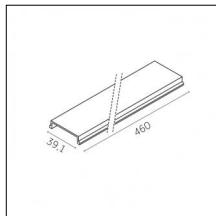

### Code 0.25871.0012 - Hard cover for surface-mounted and suspended mounting rail

Type: Structural  
Finishing: Embossed matt white (Standard)  
Length: 460mm Width: 35.3mm

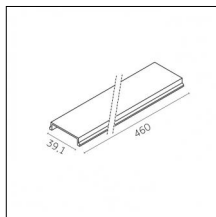

### Code 0.25871.0031 - Hard cover for surface-mounted and suspended mounting rail

Type: Structural  
Finishing: Embossed matt black (Standard)  
Length: 460mm Width: 35.3mm

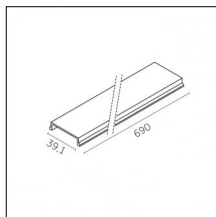

### Code 0.25872.0012 - Hard cover for surface-mounted and suspended mounting rail

Type: Structural  
Finishing: Embossed matt white (Standard)  
Length: 690mm Width: 35.3mm

## Accessories

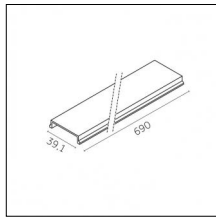

### Code 0.25872.0031 - Hard cover for surface-mounted and suspended mounting rail

Type: Structural  
Finishing: Embossed matt black (Standard)  
Length: 690mm Width: 35.3mm

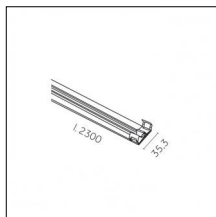

### Code 0.25874.0012 - Mounting rail cover including spring clips length: 2300 mm

Type: Structural  
Finishing: Embossed matt white (Standard)  
Length: 2300mm Width: 35.3mm  
Description: Mounting rail cover including spring clips length: 2300 mm

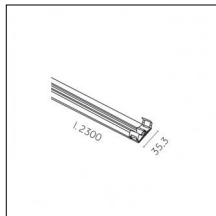

### Code 0.25874.0031 - Mounting rail cover including spring clips length: 2300 mm

Type: Structural  
Finishing: Embossed matt black (Standard)  
Length: 2300mm Width: 35.3mm  
Description: Mounting rail cover including spring clips length: 2300 mm

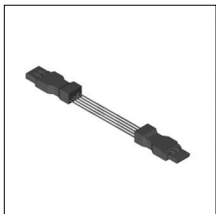

### Code 0.25880.0000 - Pre-wired power cable with plug and socket

Type: Structural  
Finishing: Without finish / Stainles Steel / Natural aluminium (Standard)  
Length: 230mm  
Description:



### Code 0.25881.0000 - Pre-wired power cable with plug and socket

Type: Structural  
Finishing: Without finish / Stainles Steel / Natural aluminium (Standard)  
Length: 460mm

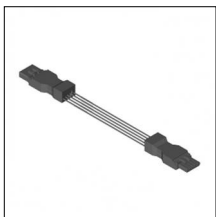

### Code 0.25882.0000 - Pre-wired power cable with plug and socket

Type: Structural  
Finishing: Without finish / Stainles Steel / Natural aluminium (Standard)  
Length: 690mm

## Accessories

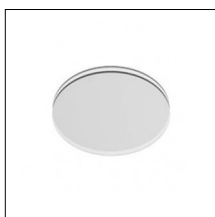

### Code 0.26414.0000 - Colored Gel Slides (2 pieces)

Type: Optical  
Finishing: Without finish / Stainles Steel / Natural aluminium (Standard)

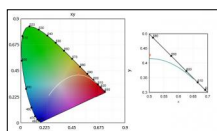

### Code 0.26422.0000 - Selective filter 2700K - 2500K

Type: Optical  
Finishing: Without finish / Stainles Steel / Natural aluminium (Standard)

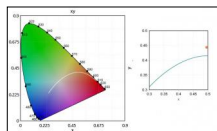
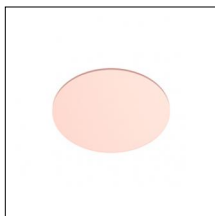

### Code 0.26430.0000 - Selective filter 2700K - 2200K

Type: Optical  
Finishing: Without finish / Stainles Steel / Natural aluminium (Standard)

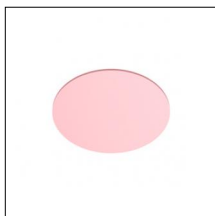

### Code 0.26438.0000 - Selective filter 2700K - 2000K

Type: Optical  
Finishing: Without finish / Stainles Steel / Natural aluminium (Standard)

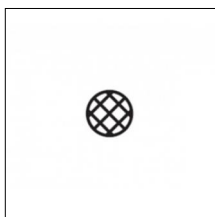

### Code 0.26446.0000 - Honeycomb dense texture

Type: Optical  
Finishing: Without finish / Stainles Steel / Natural aluminium (Standard)

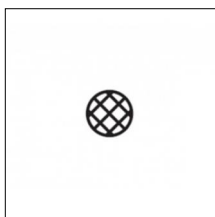

### Code 0.26454.0000 - Honeycomb wide texture

Type: Optical  
Finishing: Without finish / Stainles Steel / Natural aluminium (Standard)

## Accessories

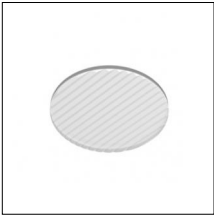

### Code 0.26459.0000 - Ribbed glass

Type: Optical

Finishing: Without finish / Stainles Steel / Natural aluminium (Standard)

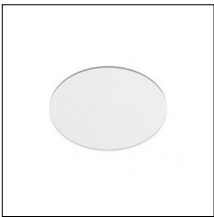

### Code 0.26466.0000 - Opal lens

Type: Optical

Finishing: Without finish / Stainles Steel / Natural aluminium (Standard)

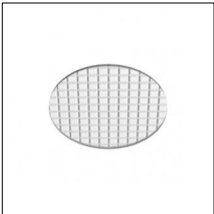

### Code 0.26474.0000 - Diffusive lens

Type: Optical

Finishing: Without finish / Stainles Steel / Natural aluminium (Standard)

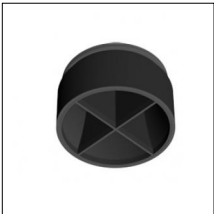

### Code 0.26479.0000 - Cross blade louver

Type: Optical

Finishing: Without finish / Stainles Steel / Natural aluminium (Standard)

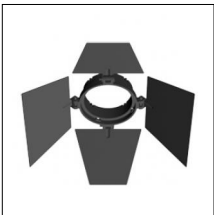

### Code 0.26487.0000 - Barn doors

Type: Optical

Finishing: Without finish / Stainles Steel / Natural aluminium (Standard)



### Code 0.26491.0012 - Cone 45 ° wall washer

Type: Optical

Finishing: Embossed matt white (Standard)

## Accessories



### Code 0.26491.0031 - Cone 45 ° wall washer

Type: Optical  
Finishing: Embossed matt black (Standard)

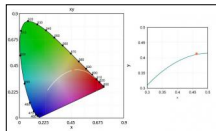
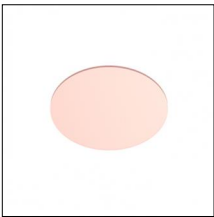

### Code 0.26563.0000 - Selective filter 3000K-2700K

Type: Optical  
Finishing: Without finish / Stainles Steel / Natural aluminium (Standard)

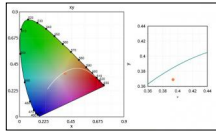
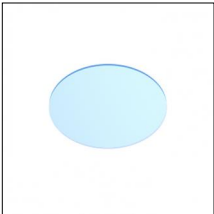

### Code 0.26571.0000 - Selective filter 3000K-3600K

Type: Optical  
Finishing: Without finish / Stainles Steel / Natural aluminium (Standard)

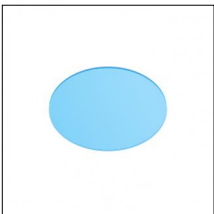

### Code 0.26579.0000 - Selective filter 3000K-4000K

Type: Optical  
Finishing: Without finish / Stainles Steel / Natural aluminium (Standard)