

Euclid 12

LED linear lighting system

The Euclid 12 system was developed with George Sexton Associates as a custom design for a major residential lighting project.

The smallest section linear system in the Radiant range the Euclid 12 can provide up to 700 lumens per mtr.

The system incorporates the same medium power LED light engines used in the Shard so that the two systems can be used together. On board linear drivers and LEDs in a wide variety of colour temperatures with CRI up to 95. Up to 700 lumens per mtr. Dot free opal or clear window versions are available.

The system can be supplied in any length up to 2.5 mtrs. Smallest cutting module based on 100 mm LED pitch.



Lumens per mtr



Euclid 20

LED linear lighting system

The Euclid 20 system was originally developed with DPA in Dubai for use on residential projects as a simple to install, cost effective linear lighting system. The 16 Amp plug together connector system, which fits inside the body extrusion, allows up to 11 mtrs to be lit from a single feed point without dark gaps between strips.

Designed for use in both indirect cove lighting applications and also, with the addition of a linear lens and optical films, for wall grazing and wall washing.

The system incorporates the same medium power LEDs used in the Shard and Euclid 12 so that all these systems can be used together. Up to 1,800 lumens per mtr. Clear window, Opal and Dot free opal and clear are available along with RGBW and dynamic white light versions.

The system can be supplied in any length up to 2.5 mtrs with the smallest cutting module based on 100 mm LED pitch.

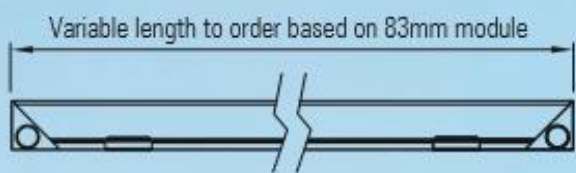
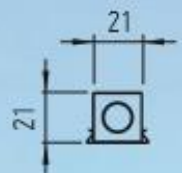



Linear lens version - 40° beam angle



Diffuse opal cover



Plug together 16 Amp connector between strips.
Connector fits inside modules for continuous lighting



Euclid 20 side feed



Euclid 20 Balljoint

Modular, 3D flexible LED linear lighting system

The Euclid 20 Balljoint system combines the simplicity of the Euclid 20 with the total flexibility of the 3D LED Flex range.

The system incorporates the same medium power LEDs used in the Euclid 20 so that these systems can be used together on the same project. On board linear drivers and LEDs in a wide variety of colour temperatures with CRI up to 95. Up to 1,800 lumens per mtr. Opal, Dot free opal, clear window and linear lens versions are available.

Modules in any length based on a 100 mm module can be used to make up complete lengths of the system. RGBW and dynamic white light engines can also be incorporated in this system.



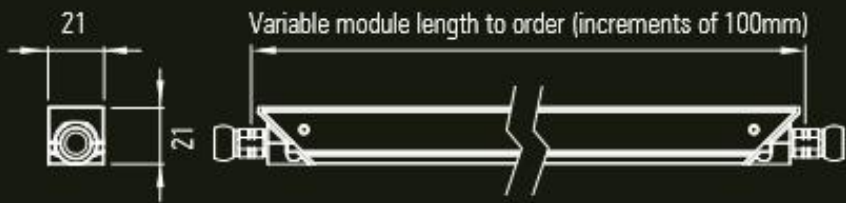

Strips up to 2 Mtrs can be comprised of custom combinations of modules of any specified length (increments of 100mm)

E.g. a 2 Mtr strip comprised of 10 x 200mm modules

Standard minimum bend radii with 100mm modules:

(The module length will effect the bend radii)

