

Direct View Monochromatic & RGB Pixel LED

PRODUCT SPECIFICATION SHEET

DATE:

TYPE:

COMPANY:

PROJECT:

BRACKET MOUNT

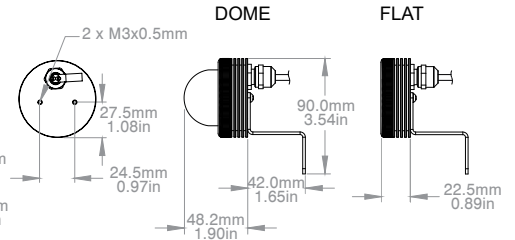
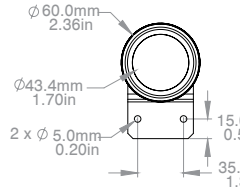

FLANGE MOUNT 90MM

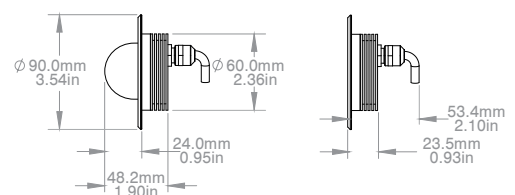
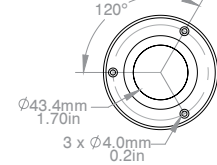

FLANGE MOUNT 105MM

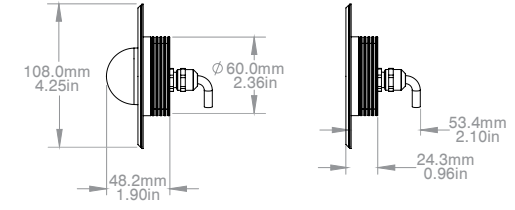
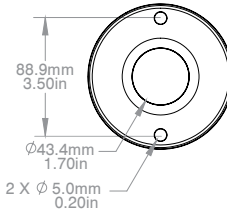

FLANGE MOUNT 115MM

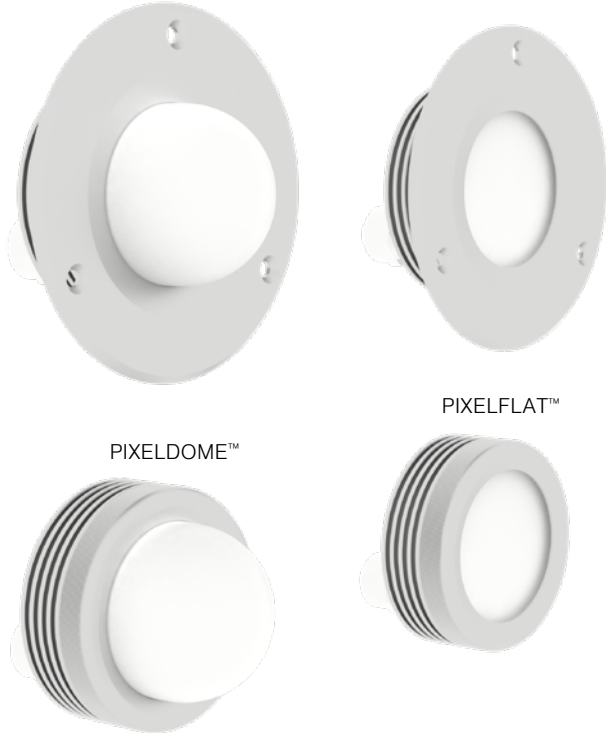
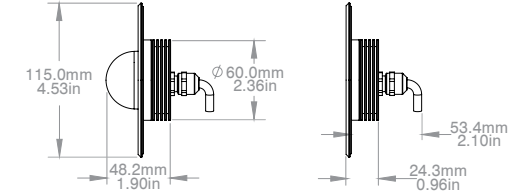
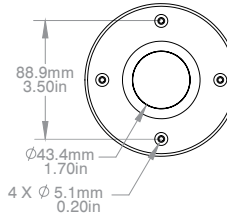

FEATURES:

- IP66 rated for dry, damp or wet locations
- Indoor or outdoor applications from -40°C to +50°C, -40°F to +122°F
- Machined anodized aluminum body designed for superior thermal management
- Projected Lifetime 50,000hrs @ 50°C, 86°F (B50, L70)
- 5 year limited warranty

OPTIONS:

- RGB or Monochromatic LED packages available
- Available in clear matte or black matte outdoor anodized finish
- Bracket, flange or junction box mounting
- Impact resistant, opal acrylic dome lens for 180°+ viewing angle or opal acrylic flat lens

SPECIFICATION LOGIC: PIXELDOME™ & PIXELFLAT™

| FAMILY | OPTICS | BODY COLOR | LED POWER | LED COLOR | CONTROL | MOUNTING ² |
|--------|--------------|--|-----------|--|--|--|
| PIXEL | DOME FLAT | CM - Clear Matte Anodized BM - Black Matte Anodized CUST - Custom Color ³ | 3W | 2700K 3000K 3500K 4500K 5000K 6500K RD - Red GR - Green BL - Blue AM - Amber RGB - Red, Green & Blue | ND - Non-Dimming ¹ DMX PD - Power/Data ³ | BK - Bracket Mount FM90 - Flange Mount 90mm FM105 - Flange Mount 105mm FM115 - Flange Mount 115mm ML - Mountless |

PRODUCT CONFIGURATION

1. Non-Dimming control option only available with monochromatic LED Color options
 2. For junction box options see accessories on Page 2.
 3. Non standard option and might require longer leadtime than usual. Contact factory for details.

Direct View Monochromatic & RGB Pixel LED

PRODUCT SPECIFICATION SHEET

| PRODUCT SPECIFICATIONS: PIXELDOME™ & PIXELFLAT™ | | | | | | |
|---|---|--|--|-------------------|--------------------|--------------------|
| ELECTRICAL | Rated Input Voltage | | 24V DC | | | |
| | Power Consumption (Max.) | | 3.5W | | | |
| | Approved Remote AC/DC Power Supply | | GVA Lighting, Inc. Power-Data Box Only | | | |
| OPTICAL | Light Source | | 1 x Red, 1 x Green, 1 x Blue LEDs or 3 x Mono Color LEDs | | | |
| | Lumens (Typical) | | 125 | | | |
| | Optics (FWHM) | | PMMA Opal Dome Lens, 180°+ Viewing Angle or PMMA Opal Flat Lens | | | |
| CONTROL | Lumen Maintainance (L70) | | 50,000 hours @ 50°C (B50, L70) | | | |
| | Control Interface | | DMX-512-A or No Dimming, On/Off | | | |
| | Control Systems | | GVA Lighting Power-Data Equipment/ Any third party DMX512-A controllers | | | |
| PHYSICAL | | | Bracket Mount | Flange Mount 90mm | Flange Mount 105mm | Flange Mount 115mm |
| | Size (Width x Depth PIXELDOME™ / Depth PIXELFLAT™) | mm | 60 x 48 / 23 | 90.0 x 48.2/ 23.5 | 108.0 x 48.2/ 24.3 | 115.0 x 48.2/ 24.3 |
| | | in | 2.4 x 1.9 / 0.9 | 3.54 x 1.90/ 0.93 | 4.25 x 1.90/ 0.96 | 4.53 x 1.90/ 0.96 |
| | Weight | kg | 0.16 | 0.15 | 0.15 | 0.15 |
| | | lbs | 0.34 | 0.33 | 0.33 | 0.33 |
| | Housing | | Machined 6063 T6 Aluminum, Anodized, Opal PMMA Dome/ Flat Lens | | | |
| | Fixture Connections | | 300mm Lead Cable, tinned stripped leads | | | |
| Rated Operation Temperature | | -40°C to +50°C, -40°F to 122°F | | | | |
| Environment | | Indoor/Outdoor, Dry or Damp or Wet Locations | | | | |
| CERTIFICATION & SAFETY | Listings | | ETL/cETL, RoHS | | | |
| | IEC Classifications | | Surface or Recessed Mount, Indoor/Outdoor-Use, Class III, IP66, for normal use | | | |
| | UL/CSA Classification | | Surface Mount or Recessed Mount, For Dry or Damp or Wet Locations | | | |
| | | | | | | |

These figures are subject to change due to further development and innovations of LED light sources.

ORDERING LOGIC: ACCESSORIES

| JUNCTION BOX KITS | | JB110 |
|---|---|---|
| <p>Technical drawings of JB110 junction box kit showing top, side, and front views with dimensions: 127mm (5.0in) diameter, 140mm (5.5in) height, 107mm (4.2in) side length, 83mm (3.3in) front length, 5mm (0.2in) offset, 5 x 3/4-14 NPT, and 4 x 1/2-14 NPT.</p> | PART NUMBER | |
| | 122393 | |
| | *Fits with FM105 Mounting Option *Kit includes required screws for mounting luminaire to junction box | |
| <p>Technical drawings of JB128 junction box kit showing top, side, and front views with dimensions: 127mm (5.0in) diameter, 151mm (6.0in) height, 85mm (3.4in) side length, 61mm (2.4in) front length, 10mm (0.4in) offset, and 5 x 3/4-14 NPT.</p> | PART NUMBER | |
| | 122394 | |
| | *Fits with FM115 Mounting Option *Kit includes required screws for mounting luminaire to junction box | |
| <p>Technical drawings of JB105 junction box kit showing top, side, and front views with dimensions: 144.0mm (5.67in) diameter, 124.0mm (4.88in) height, 97.2mm (3.83in) side length, 73.3mm (2.88in) front length, 5 x M16x1.5.</p> | PART NUMBER | |
| | 122751 | |
| | *Fits with FM105 Mounting Option *Kit includes required screws for mounting luminaire to junction box | |
| CABLE GLANDS | | |
| | SIZE | PART NUMBER |
| | 3/4in NPT | 280271 |
| | M16x1.5 | 280142 |
| | | Min. cable O.D.: 6.5mm, Max. cable O.D.: 14.0mm |
| | | Min. cable O.D.: 4.5mm, Max. cable O.D.: 10.0mm |
| RTV 102 SILICONE ¹ | | |
| | SIZE | PART NUMBER |
| | 85 mL tube | 260186 |
| | | |

1. All outdoor applications require RTV 102 silicone to be applied to all cable entries, thread plugs, cable glands, and conduit adapters. See installation guide for more details