

RGBW Inner Mixing Architectural Spot and Floodlight

PRODUCT SPECIFICATION SHEET

Color mixing in a single optic for wall washing/grazing applications and color compatibility with STR9® RGBW fixtures.

DATE:

TYPE:

COMPANY:

PROJECT:

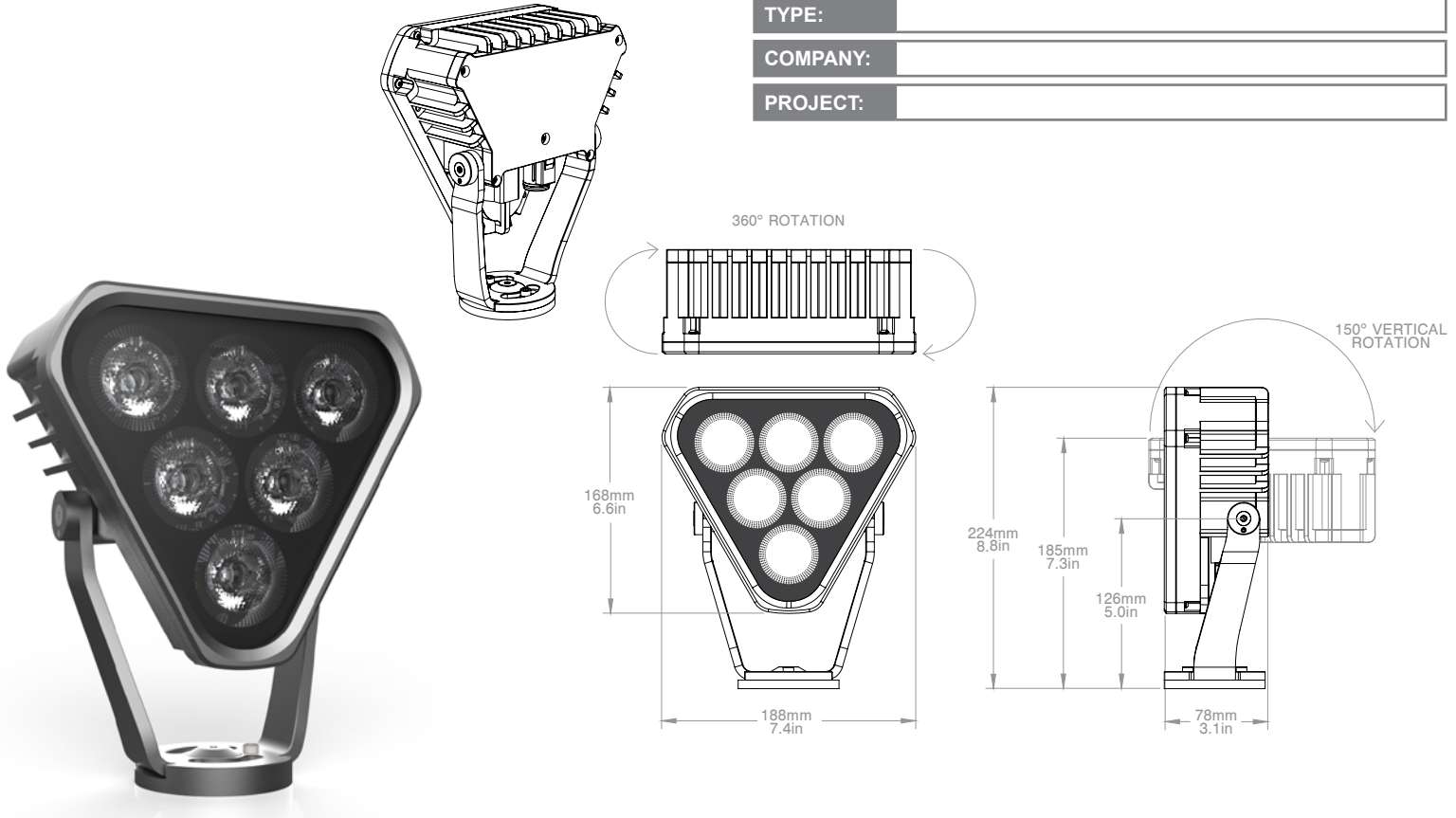

FEATURES:

- COLOR-AMP® technology allows up to three times higher light output in specific colors
- INFINITY® Technology compatible (INF)
- Built-in high temperature power supply (AC)
- IP66 sealed body design
- Plug-and-play with STR9® luminaires
- Color matched with STR9® RGBW linear luminaires
- Advanced thermal design with cutting-edge manufacturing process and materials
- Compact size, only 78mm (3.1in) in depth
- Weight of only 2.0kg (4.4lbs)
- Highly adjustable with 360° horizontal rotation and 150° vertical rotation

OPTIONS:

- Beam angles ranging from 10° to 90° with elliptical distribution options
- Optical accessories for glare control
- Clear matte and black matte standard anodized body colors
- Custom body colors available on demand
- ELV (48VDC), INF (380VDC) and AC (85~277VAC) input options
- Range of bracket lengths and mounting options

SPECIFICATION LOGIC: FL25 RGBW-IM (INNER MIXING)

FAMILY	BODY COLOR	LED COLOR	OPTICS(FWHM)*	VOLTAGE	MOUNTING OPTION
FL25	BM - Black Matte Anodized CM - Clear Matte Anodized CUST - Custom Color ¹	RGBW65K-IM	10 - 10°x10° 20 - 20°x20° 40 - 40°x40° 60 - 60°x60° 80 - 80°x80° 90 - 90°x90° 10x40 - 10°x40° H 40x10 - 40°x10° V 10x60 - 10°x60° H 60x10 - 60°x10° V 30x60 - 30°x60° H 60x30 - 60°x30° V	ELV - 48VDC INF - 380VDC AC277 - 85~277VAC	SM120 - Surface Mount 120mm ¹ SM200 - Surface Mount 200mm ¹ SM300 - Surface Mount 300mm ¹ SM400 - Surface Mount 400mm ¹ SM500 - Surface Mount 500mm ¹ SMXXX - Surface Mount Custom ¹ (specify length) TM120 - Tenon Mount 120mm ¹ PM - Pole Mount ¹

PRODUCT CONFIGURATION





1. Non standard option and might require longer leadtime than usual. Contact factory for details.

Nominal values are used. Actual measurements may differ slightly.

RGBW Inner Mixing Architectural Spot and Floodlight

PRODUCT SPECIFICATION SHEET

PRODUCT SPECIFICATIONS: FL25 RGBW-IM (INNER MIXING)

ELECTRICAL	Rated Input Voltage		48VDC		380VDC		85~277VAC		
	Power Consumption (max.)		25W		25W		30W		
OPTICAL	Light Source		6 x High Power 4 in 1 LEDs						
	CRI		70						
	COLOR-AMP Output (typical)	Color	Wave Length (nm)	Luminous Flux (lm)	Peak Intensity (cd)	Luminous Flux (lm)	Peak Intensity (cd)	Luminous Flux (lm)	Peak Intensity (cd)
		Red	617	450	10,330	410	9,300	360	8,260
	10°	Green	520	650	15,580	590	14,020	520	12,460
		Blue	453	190	4,420	170	3,980	150	3,540
		White	6700K	1,170	27,970	1,050	25,170	940	22,380
	Optics		High optical efficiency PMMA TIR Lens, Micro Lense Film, Tempered Glass Cover Lens						
	Beam Angle (FWHM)		10 (10°x10°), 20 (20°x20°), 40 (40°x40°), 60 (60°x60°), 80 (80°x80°), 90 (90°x90°), 10x40 (10°x40°), 40x10 (40°x10°), 10x60 (10°x60°), 60x10 (60°x10°), 30x60 (30°x60°), 60x30 (60°x30°)						
	Projected Lumen Maintenance		L70 > 60,000hrs @ Ta =50°C (122°F)						
CONTROL	Control Interface		DMX control through GVA's Power-Data Equipment						
PHYSICAL	Body Size (HxWxD)		168 x 188 x 78 mm (6.6 x 7.4 x 3.1 in)						
	Weight		2.0 kg (4.4 lbs)						
	Housing		Anodized 6061 Aluminum Alloy						
	Fixture Connections		IP68 Connectors						
	Rated Operation Temperature		-40°C (-40°F) to +50°C (122°F)						
CERTIFICATION & SAFETY	Environment		Dry, Damp or Wet Locations, 0-100% humidity						
	Listings		RoHS, REACH						
	IEC Classifications		Class 1 LED Luminaire						
	<div><div></div><div></div></div> <div><div></div><div></div><div></div><div>DRY DAMP WET</div></div>		<div>Constructed to meet requirements outlined in UL1598 & IEC60598</div> <div>Constructed to meet ANSI C136.31 3G Vibration standard for bridge and overpass applications</div>						

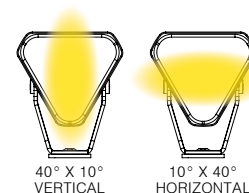

These figures are subject to change due to further development and innovations of LED light sources.

RGBW Inner Mixing Architectural Spot and Floodlight

PRODUCT SPECIFICATION SHEET

TYPICAL SYSTEM DIAGRAM: AC (WITH CONTROL)

NOTE: Length of leader cables and jumper cables directly affects the maximum number of fixtures in a single run.

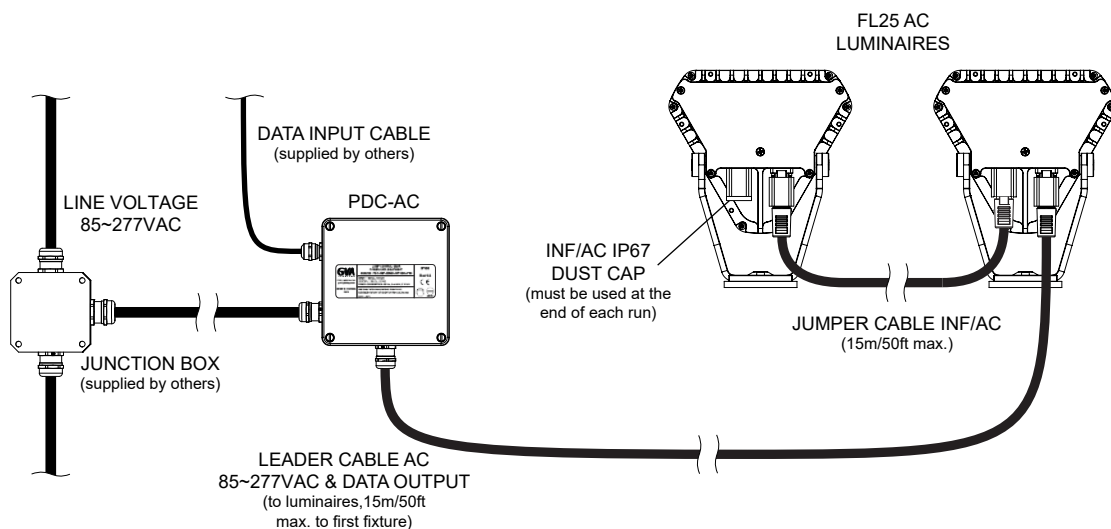

TYPICAL SYSTEM DIAGRAM: AC (WITH NO CONTROL)

NOTE: Length of leader cables and jumper cables directly affects the maximum number of fixtures in a single run.

To be used with FL25 MONO fixtures only.

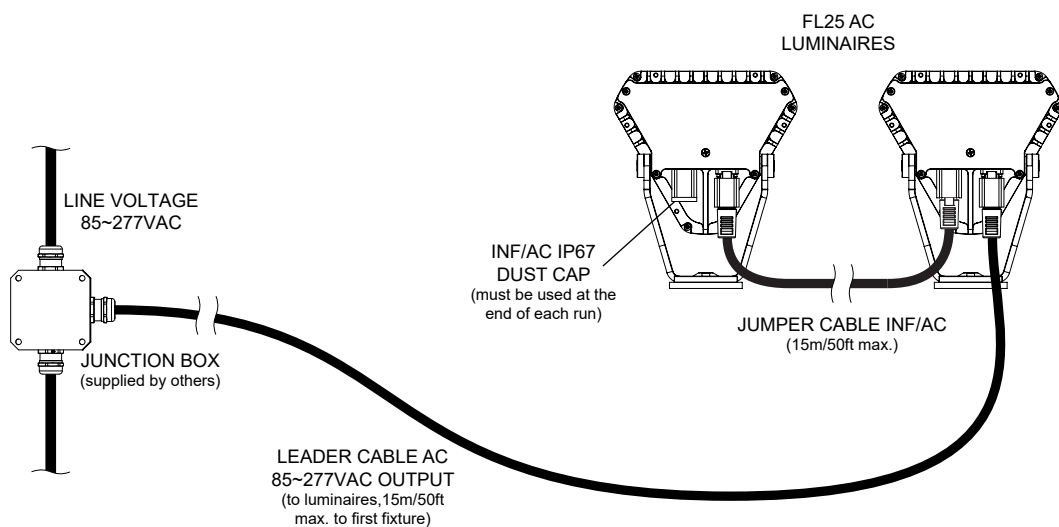

RGBW Inner Mixing Architectural Spot and Floodlight

PRODUCT SPECIFICATION SHEET

TYPICAL SYSTEM DIAGRAM: INFINITY® (WITH CONTROL)

NOTE: Length of leader cables and jumper cables directly affects the maximum number of fixtures in a single run.

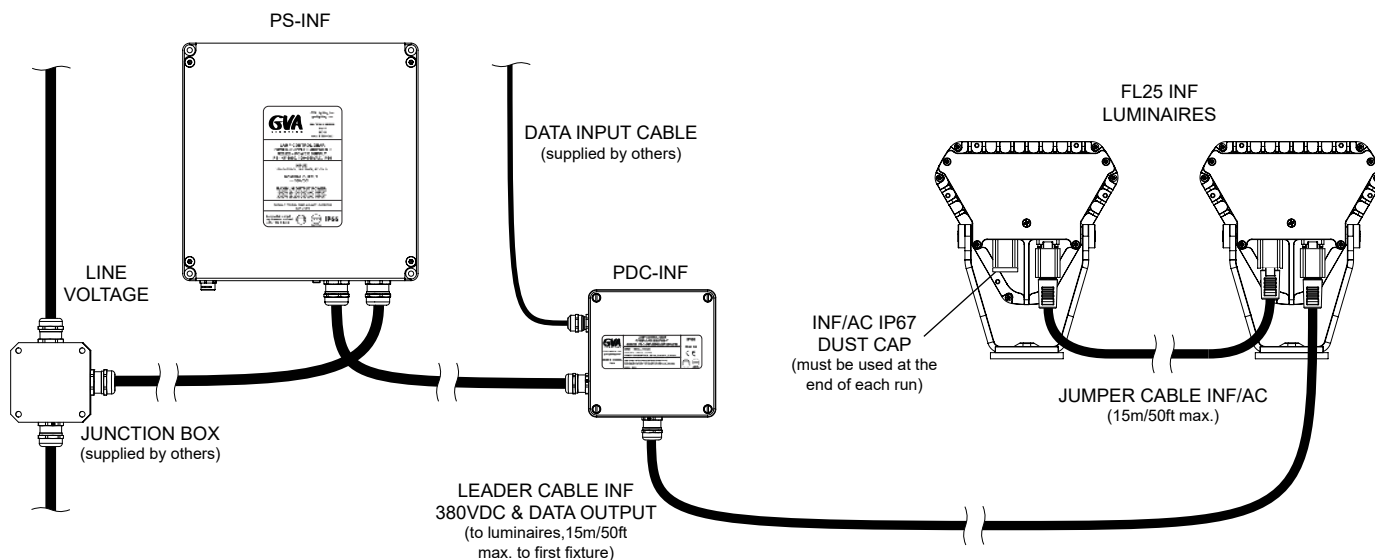

TYPICAL SYSTEM DIAGRAM: ELV (WITH CONTROL)

NOTE: Length of leader cables and jumper cables directly affects the maximum number of fixtures in a single run.

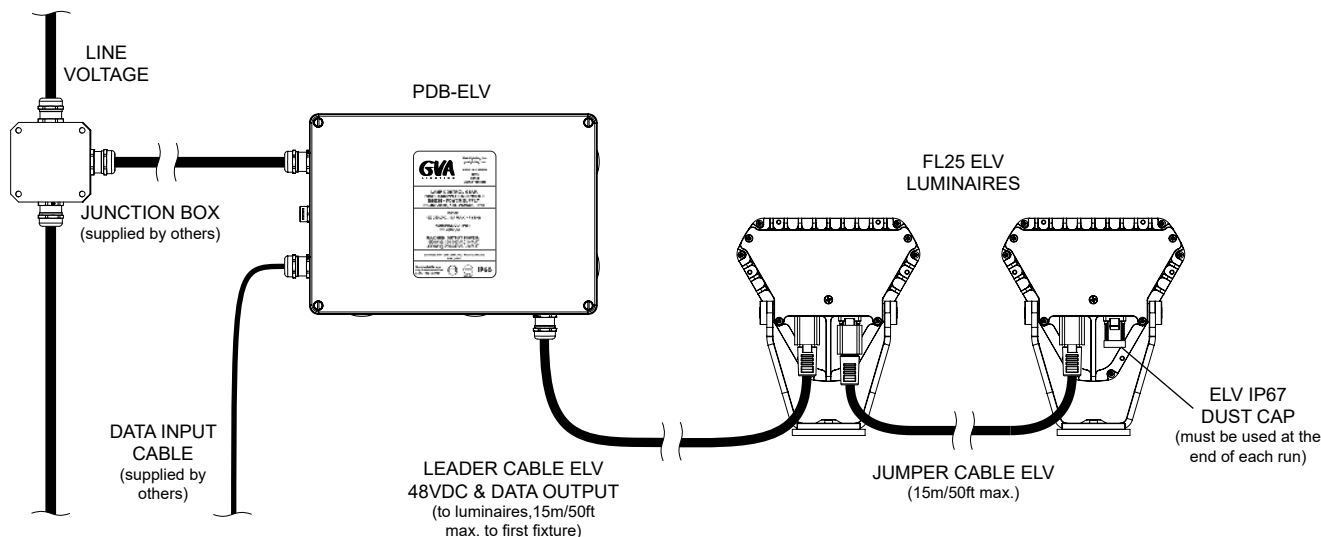

RGBW Inner Mixing Architectural Spot and Floodlight

PRODUCT SPECIFICATION SHEET

ORDERING LOGIC: ACCESSORIES

VISORS

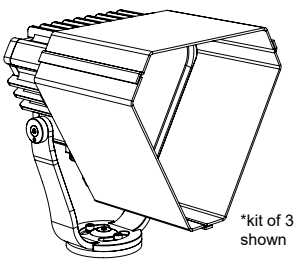

*kit of 3 shown

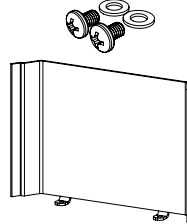
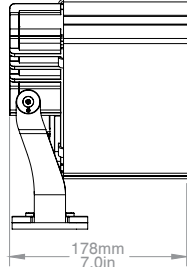

COLOR	KIT OF 1	KIT OF 2	KIT OF 3
Clear Matte Anodized	122397	122400	122403
Black Matte Anodized	122398	122401	122404
Custom Color	122399	122402	122405

* kit includes mounting hardware

BARN DOORS

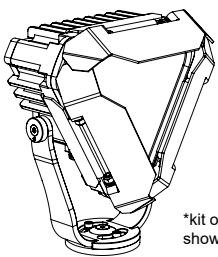

*kit of 3 shown

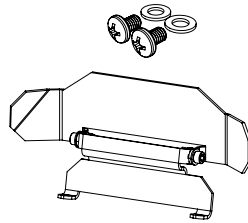
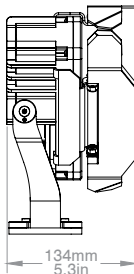

COLOR	KIT OF 1	KIT OF 2	KIT OF 3
Clear Matte Anodized	122407	122410	122413
Black Matte Anodized	122408	122411	122414
Custom Color	122409	122412	122415

* kit includes mounting hardware

ORDERING LOGIC: COMMON COMPONENTS

LEADER CABLES

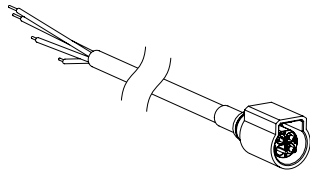

NOMINAL LENGTH	ELV	INF	AC
3m (10ft)	140723	140725	140858
9m (30ft)	140733	140710	140859
15m (50ft)	140724	140726	140860
CUSTOM	140732	140727	140861

JUMPER CABLES

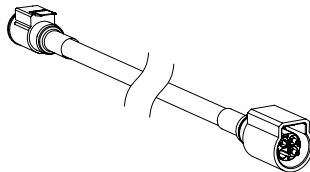

NOMINAL LENGTH	ELV	INF/AC
0.9m (3ft)	140729	140709
1.8m (6ft)	140730	140734
3.6m (12ft)	140731	140735
CUSTOM	140728	140708

CONNECTOR DUST CAP, IP67 (must be used at the end of each run)

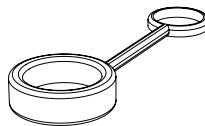

ELV	INF/AC
231182	230855