

Product Specification Sheet

Date: _____

Type: _____

Company: _____

Project: _____

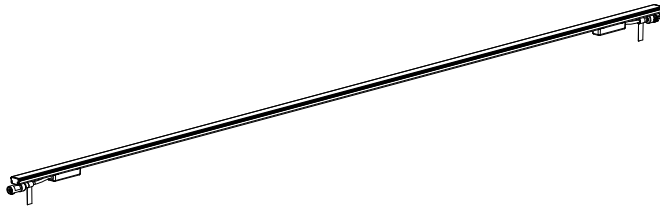

Mechanical Drawings

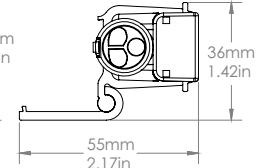
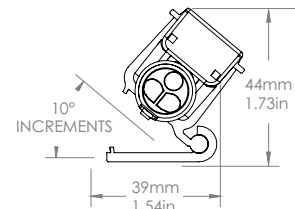
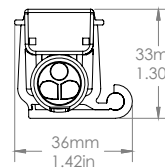
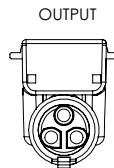
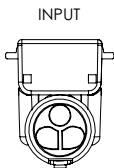
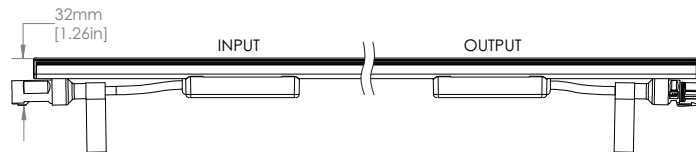
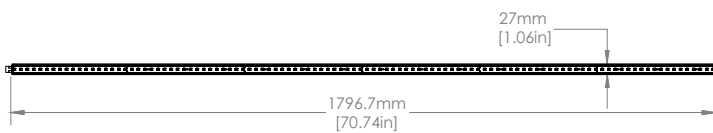

Features

- Low cost per m/cost per ft option for Highlighter HL-COVE system
- Up to 1500lm/m or 450lm/ft
- Power consumption: 5W maximum per 300mm/1ft
- 1800mm/6ft fixture length: ideal for long, straight runs
- 18 mid-power LEDs per 300mm/1ft for perfectly even illumination
- LED pitch is maintained within and between luminaires: no dark spots between fixtures
- DMX, DALI or 0~10V dimming through GVA's power-data equipment
- Through wiring for end-to-end connection via snap-in connectors: no junction boxes
- Compatible with HL-COVE modules: can be paired for applications with both straight and curved sections
- Simplified indoor construction for reduced fixture cost: IP40 rated
- Adjustable aim mounting brackets: 0-90° in 10° increments for precise control of lighting effect
- Mounting tracks for easy luminaire alignment
- Small fixture size: 37mm/1.4in high, 55mm/2.1in wide
- Projected lifetime: 115,000hrs @ 23°C, 73°F (L70)
- Operating temperature: 0°C to +50°C, 32°F to 122°F
- INFINITY® technology: exceptionally long runs (up to 200m or 672ft) from a single power source

Options

- HL-COVE Tray: mounting system with integrated glare control valence

Ordering Information

DESCRIPTION

HL-COVE-LITE-2200K
 HL-COVE-LITE-2700K
 HL-COVE-LITE-3000K
 HL-COVE-LITE-3000K-H1
 HL-COVE-LITE-3500K
 HL-COVE-LITE-4000K
 HL-COVE-LITE-4000K-H1
 HL-COVE-LITE-5000K
 HL-COVE-LITE-6500K
 HL-COVE-LITE-RD
 HL-COVE-LITE-GR
 HL-COVE-LITE-BL

ITEM NUMBER

G00069
 G00070
 G00071
 G00072
 G00073
 G00074
 G00075
 G00076
 G00077
 G00078
 G00079
 G00080

Items in grey, under development

Typical System Diagram

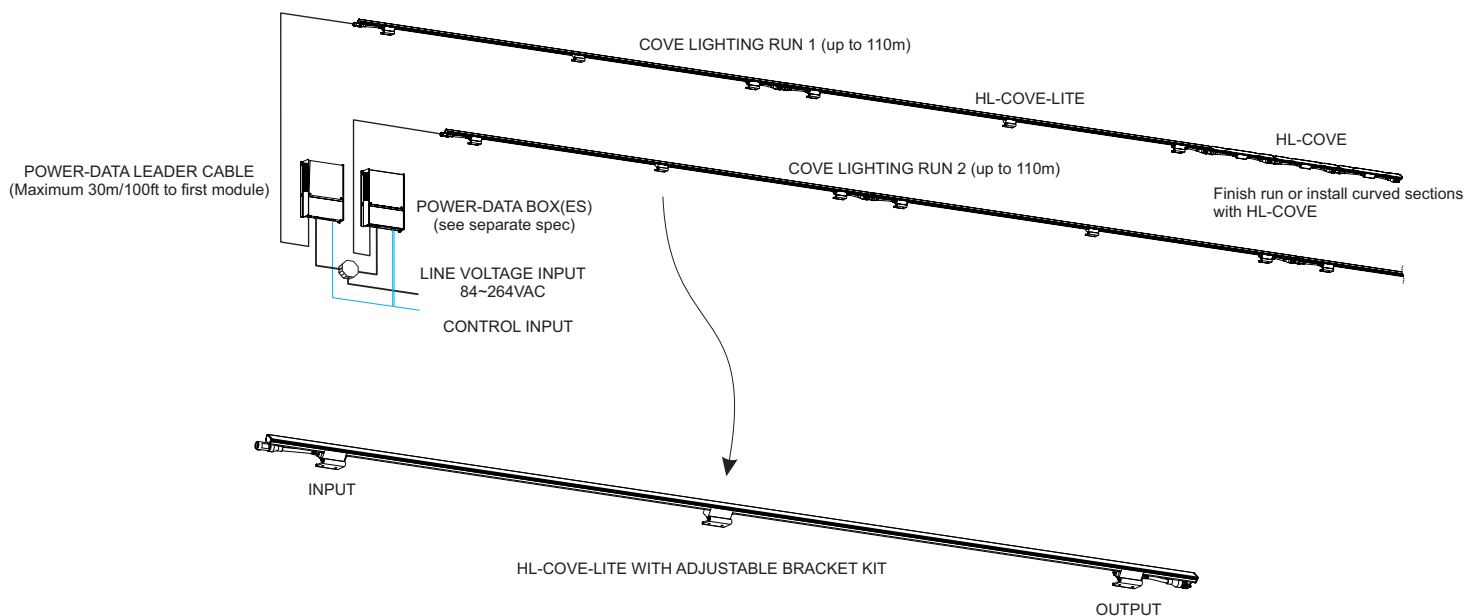

Product Specifications

HL-LITE COVE

Electrical	Rated Input Voltage	Nominal	380VDC
	Power Consumption	Typical	28.5W
		Maximum	30W
	Rated Current for Circuit	Maximum	6A
Optical	Light Source	Mono color LEDs	
	Luminous Flux (white LEDs)	lm	2700@4000K, 2000@3000K
	CRI		80+
Control	Control Interface	GVA Lighting's Proprietary ZH Control Interface	
	Fixture Connections	Mating connectors	
Physical	Length x Width x Height	mm	1796.7 x 27 x 32
		inches	70.74 x 1.06 x 1.26
	Weight	kg	0.58
		lbs	1.28
	Module Housing	Extruded, flame retardant polymeric body and lens	
	Rated Operating Temperature	0°C to +50°C, 32°F to +122°F	
	Rated Lifetime (L70 @ 23°C)	115,000hrs	
Environment	Dry or Damp Locations, IP40		
Certification & Safety	Lisitngs	cULus Listing Pending, CE, ROHS	
	IEC Classification	Class II LED luminaire	

These figures are subject to change due to further development and innovations.

HL-COVE-LITE™ Architectural Cove LED Luminaire

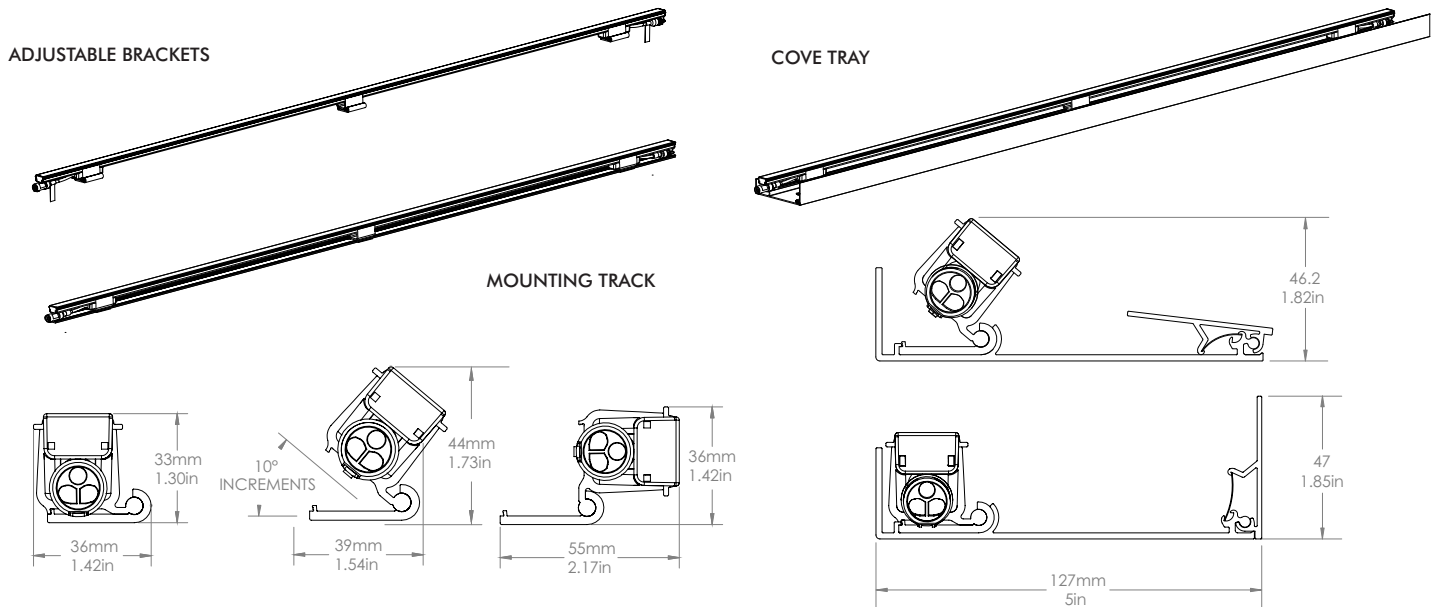

Mounting Tracks & Single Brackets

FAMILY	MOUNTING TYPE	PART NUMBER
ADJUSTABLE BRACKET, HL-COVE-LITE, MOUNTING TRACK, 1800MM	MOUNTING SCREWS MOUNTING TAPE	121211 121212

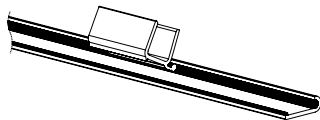

Single Brackets (Three per luminaire)

FAMILY	MOUNTING TYPE	PART NUMBER
ADJUSTABLE BRACKET, HL-COVE, SINGLE	MOUNTING SCREWS MOUNTING TAPE	120498 120551

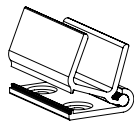

Adjustable Cove Tray (Includes adjustable brackets)

FAMILY	NOMINAL LENGTH (mm)	PART NUMBER
HL-COVE, TRAY	1800	121091

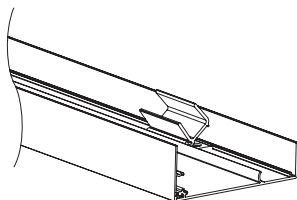

Connector Cap (must be used at the end of each run)

FAMILY	PART NUMBER
CONN, APP, HL-CONNECTOR CAP	230866

