

STR9® LITE

INFINITY®
GVA TECHNOLOGY

COLOR-AMP®
GVA TECHNOLOGY

GVA
LIGHTING

RGB Color Changing Linear Wall Washing and Grazing Indoor LED Lighting

PRODUCT SPECIFICATION SHEET



DATE:	
TYPE:	
COMPANY:	
PROJECT:	

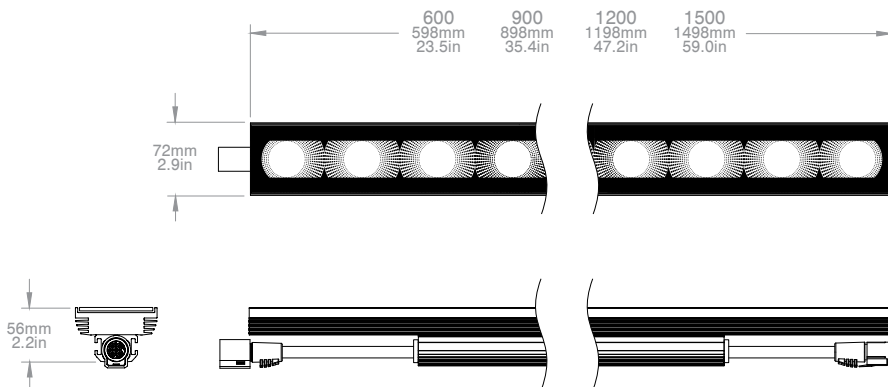

FEATURES:

Lighting Performance:

- Up to 1883 delivered lumens/meter (565 lumens/foot)
- COLOR-AMP® technology allows up to three times higher light output in specific colors
- Optics and diffusing film for outstanding color mixing (no striations or colour separation)
- Homogenous light output immediately adjacent to luminaire
- LED pitch is maintained within and between luminaires (no dark spots between fixtures)
- Color match with FL100™ RGBW-IM

Mechanical Details:

- Compact size, only 56.1mm (2.21in) high x 72.0mm (2.83in) wide
- IP50 rated simplified indoor construction for reduced fixture cost
- Optically clear tempered glass lens (no yellowing over time)
- Guaranteed long life time and high performance, no electrolytic capacitors in all DC designs
- Through wiring for end-to-end connection via snap-in connectors

Control:

- DMX control through GVA's power-data equipment
- 300mm resolution, each 300mm section can be addressed autonomously, self-addressing fixtures

Projected Lifetime: L70 > 54,000hrs @ $t_a = 50^\circ\text{C}$ (122°F)

Operating Temperatures: 0°C (32°F) to +50°C (122°F)

OPTIONS:

Power Source: INFINITY® Technology (INF) for exceptionally long runs from a single power source or Extra Low Voltage (ELV) for short runs, remote power supplies

Power Options: 15W or 20W per 300mm (1ft)

Nominal Length: 600mm (2ft), 900mm (3ft), 1200mm (4ft) and 1500mm (5ft) or custom length: 300¹ or 1800¹

Beam Distribution: Range of round and elliptical beam angles available

Body Color: Black matte and clear matte anodized or custom color

Accessories:

- 8 adjustable and 3 non-adjustable mounting brackets
- Glare control louvers

LED Color:

- Custom LED color combinations available

SPECIFICATION LOGIC: STR9® LITE RGB

FAMILY	NOMINAL LENGTH	BODY COLOR	POWER (per 300mm/1ft)	LED COLOR	OPTICS (FWHM)	INPUT VOLTAGE
STR9-LITE	300 ¹ 300E ¹ 600 900 1200 1500 1800	BM - Black Matte Anodized CM - Clear Matte Anodized	15W 20W	RGB	10 - 10° x 10° 12 - 12° x 12° 15 - 15° x 15° 30 - 30° x 30° 60 - 60° x 60° 80 - 80° x 80° 10x35 - 10° x 35° 15x60 - 15° x 60° 30x60 - 30° x 60° Other distributions available. Consult factory.	ELV - 24VDC or 48VDC ^{2,3} INF - 380VDC ⁴

PRODUCT CONFIGURATION

1 - Custom; consult factory, some restrictions apply, 300E applies to end condition

2 - For short/medium runs; 300mm (1ft) addressability for dimming; remote power-data equipment required

3 - For landscape lighting use 24VDC power-data equipment

4 - For long runs; full luminaire addressability for dimming; remote INFINITY® power-data equipment required

RGB Color Changing Linear Wall Washing and Grazing Indoor LED Lighting

PRODUCT SPECIFICATION SHEET

PRODUCT SPECIFICATIONS: STR9® LITE RGB								
Nominal Length		300/300E ¹	600	900	1200	1500	1800 ¹	
Electrical	Rated Input Voltage	24VDC, 48VDC or 380VDC						
	Power Consumption @ 24 or 48VDC Input	15W	15.3/	30.6	45.9	61.2	76.5	91.8
	Power Consumption @380VDC Input	20W	18.5/	37	55.5	74	92.5	111
		15W	/29.3	44.6	59.9	75.2	90.5	105.8
Optical	Light Source	4 x High Power 4 in 1 LEDs per 300mm (1ft)						
	COLOR-AMP™ 15W Lumen Output (typical)	All On	687	1374	2061	2748	3435	4122
		Red	323	646	969	1292	1615	1938
		Green	476	952	1428	1904	2380	2856
	COLOR-AMP™ 20W Lumen Output (typical)	Blue	280	560	840	1120	1400	1680
		All On	724	1448	2172	2896	3620	4344
		Red	315	630	945	1260	1575	1890
	Optic	Green	470	940	1410	1880	2350	2820
		Blue	207	414	621	828	1035	1242
		Beam Angle (FWHM)	High optical efficiency PMMA TIR lens, micro lens film, tempered glass cover lens					
Projected Lumen Maintenance		10 (10° x 10°), 12 (12° x 12°), 15 (15°x15°), 30 (30°x30°), 60 (60°x60°), 80 (80°x80°) 10x35 (10°x35°), 15x60 (15°x60°) 30x60 (30°x60°)						
Control	Control Protocol	DMX control through GVA's Power-Data Equipment						
Physical	Size (WxH)	mm	72.0 x 56.1					
		inches	2.83 x 2.21					
	Actual Length	mm	298/333	598	898	1198	1498	1798
		inches	11.73/13.11	23.54	35.35	47.17	58.98	70.79
	Weight	kg	1.07	2.14	3.21	4.28	5.35	6.42
		lbs	2.36	4.72	7.08	9.44	11.79	14.15
	Housing	Extruded aluminum body, tempered flat glass lens						
	Fixture Connections	Input and output snap-in connectors for end-to-end connection						
Rated Operation Temperature	0°C to 50°C (32°F to 122°F)							
Minimum Starting Temperature	0°C (32°F)							
Environment	Dry or damp locations only							
Certification & Safety	IES Classifications	Class 1 LED Luminaire						
			CE Certified QPS Field Inspection RoHS Compliant Constructed to meet requirements outlined in UL1598 & IEC60598					

1 - Custom configuration, consult factory

These figures are subject to change due to further development and innovations of LED light sources.

SELECTING LUMINAIRE VOLTAGE

24VDC

- for short runs only, up to 3.9m (12ft)
- use when class 2 circuit is required

48VDC

- for any short and medium length run, up to 7.8m (25ft)

380VDC

- for long runs, up to 76.5m (250ft)
- compatible with data center power grids
- compatible with solar and wind power

MAXIMUM RUN LENGTHS

	15W	20W
24VDC	N/A	3.9m (12ft)
48VDC	N/A	7.8m (25ft)
380VDC	N/A	76.5m (250ft)

Ratings are for 30°C, de-rating will be used for higher ambient temperatures

TYPICAL SYSTEM DIAGRAM: INFINITY® WITH CONTROL

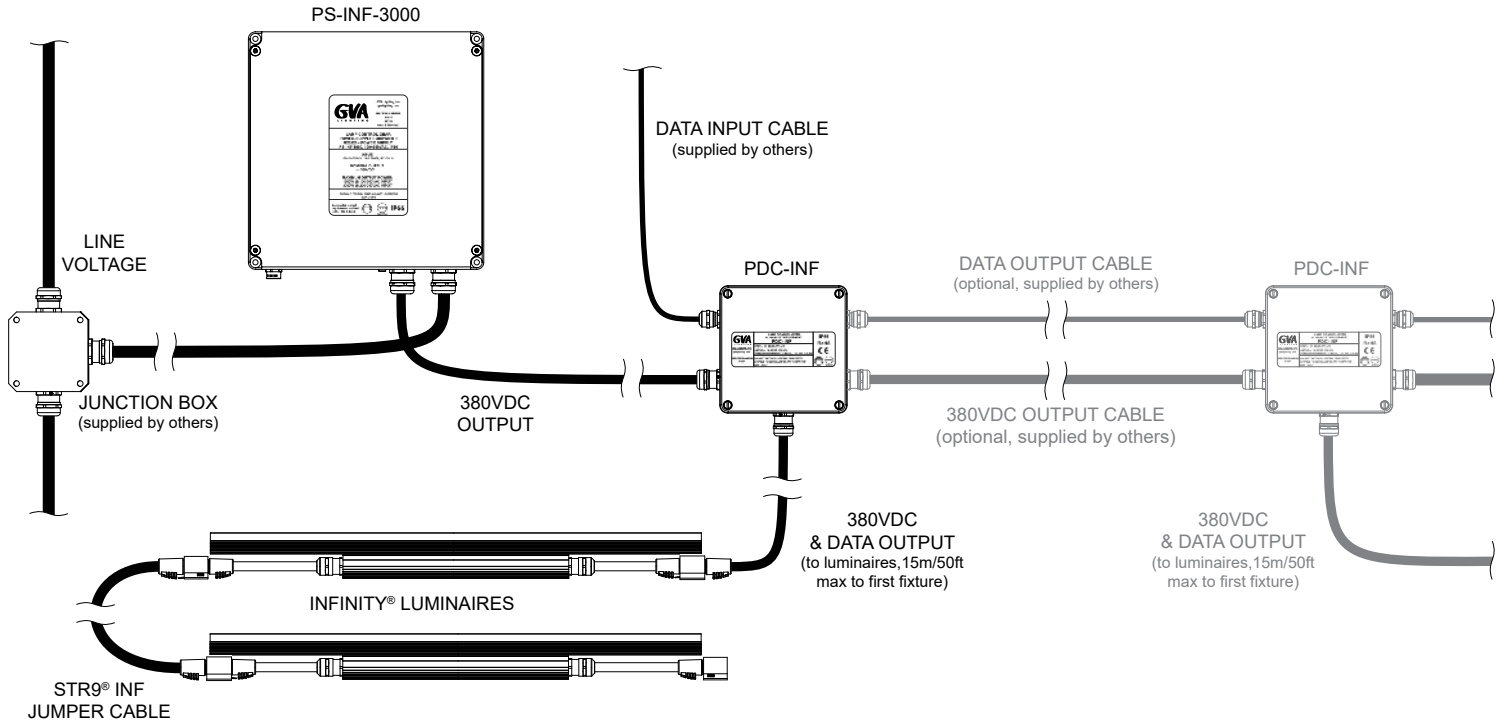

TYPICAL SYSTEM DIAGRAM: INFINITY® WITHOUT CONTROL

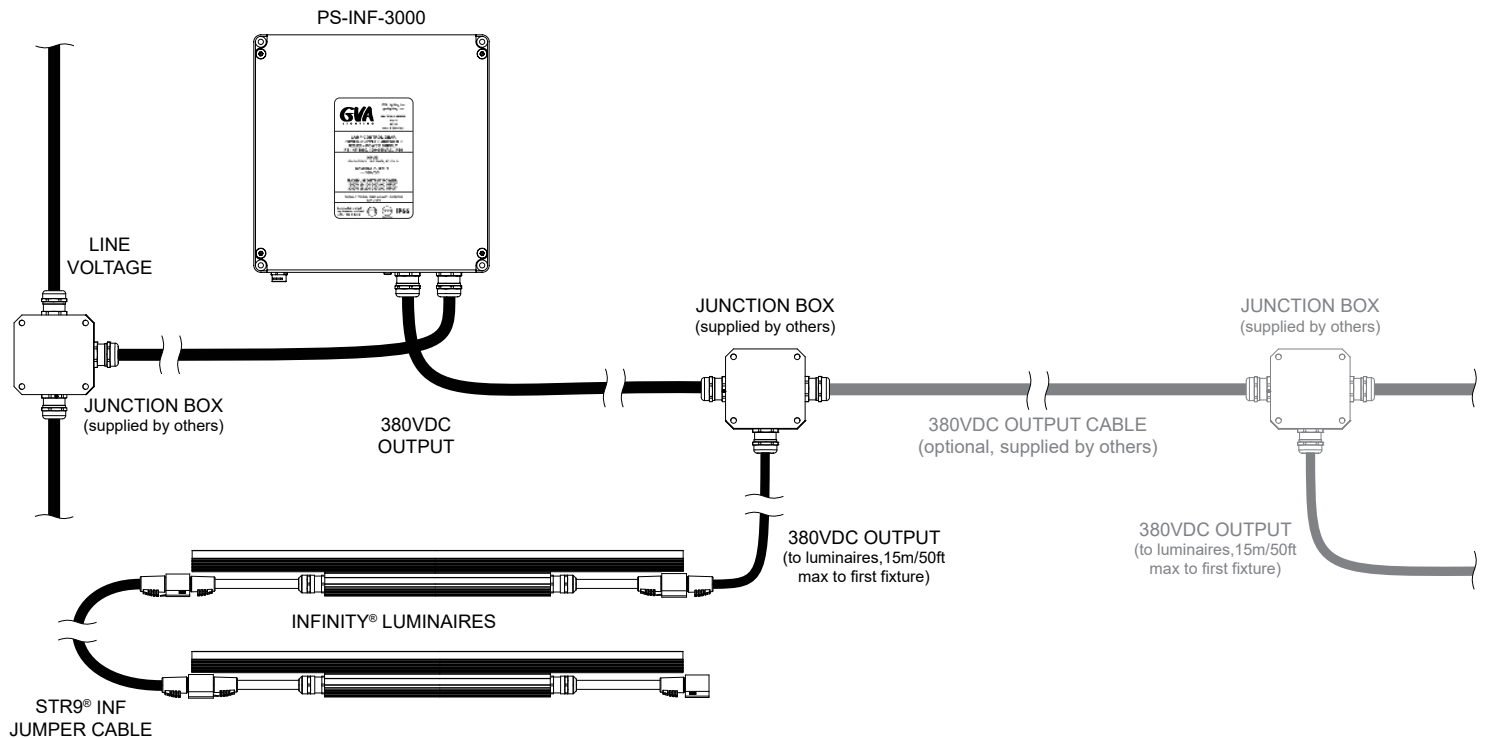

TYPICAL SYSTEM DIAGRAM: ELV WITH CONTROL

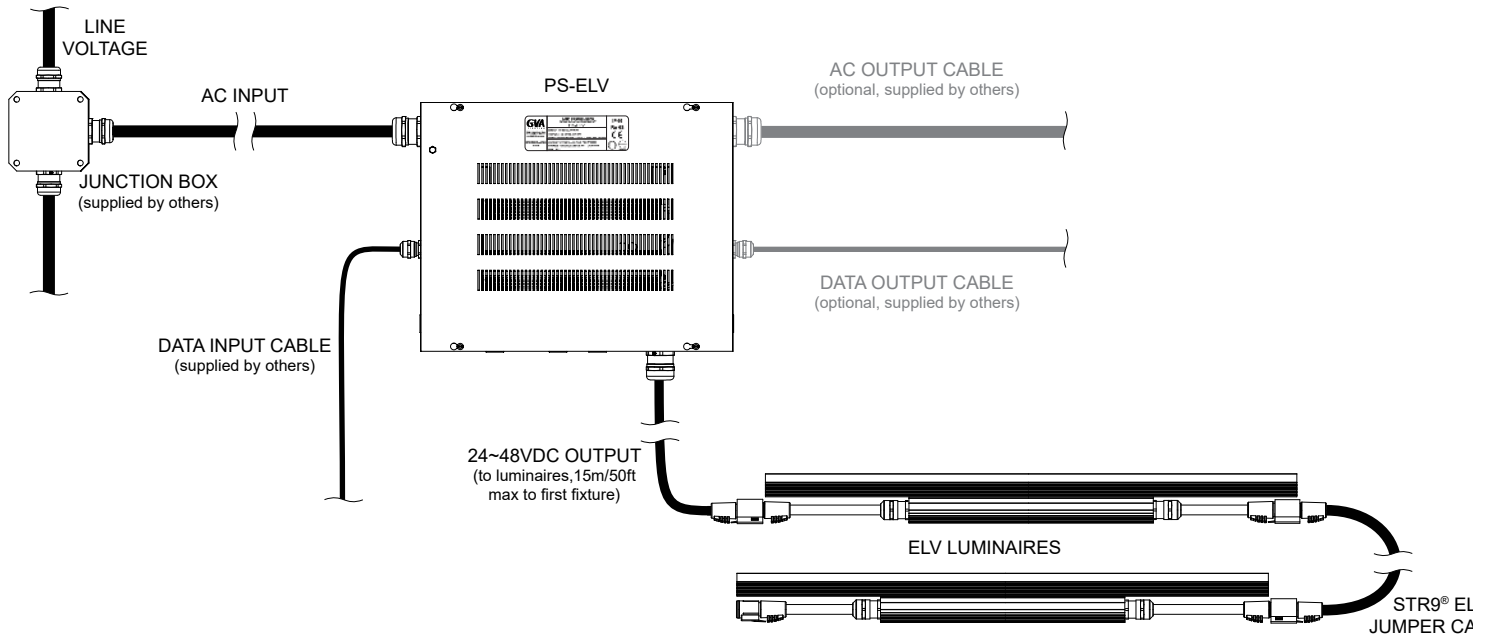

TYPICAL SYSTEM DIAGRAM: ELV WITHOUT CONTROL

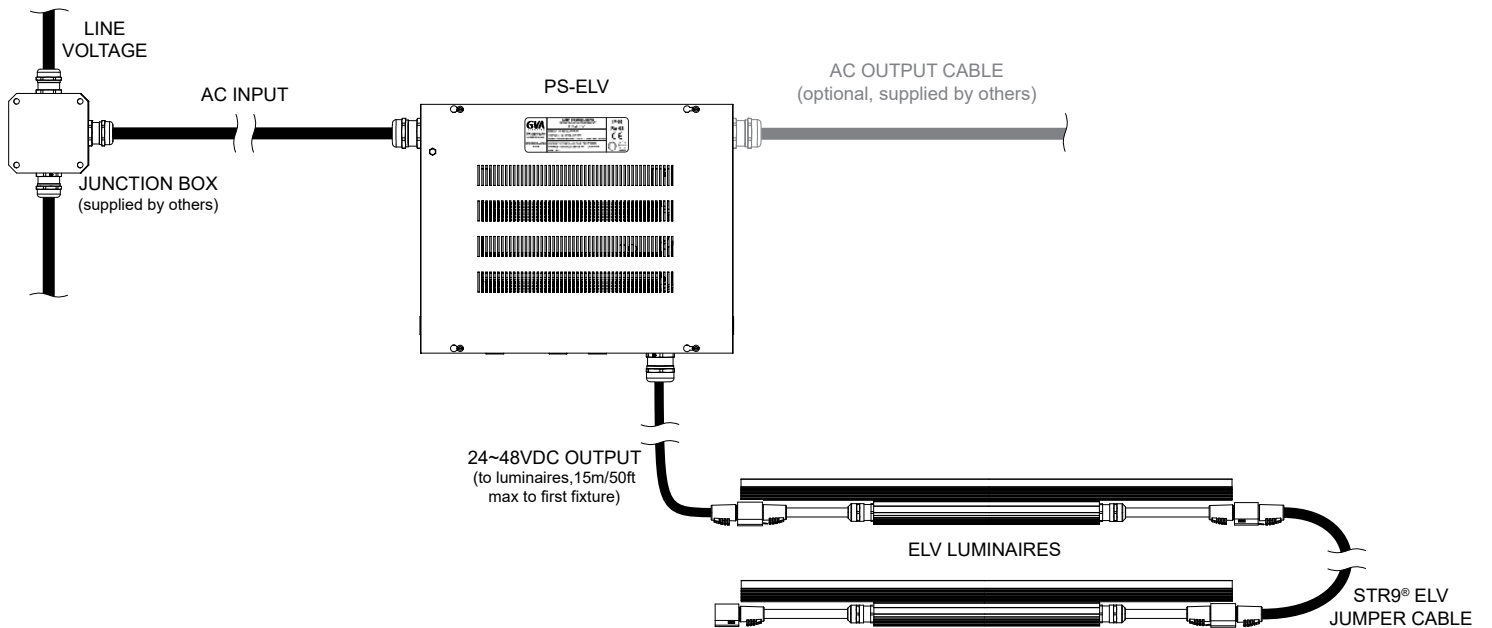

RGB Color Changing Linear Wall Washing and Grazing Indoor LED Lighting

PRODUCT SPECIFICATION SHEET

ORDERING LOGIC: STR9[®] MOUNTING ACCESSORIES

WXX - ADJUSTABLE WALL MOUNT BRACKET KIT

W40 ADJUSTABLE WALL MOUNT

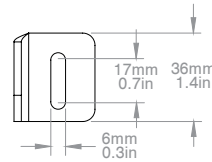
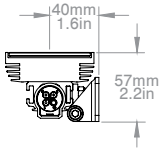

COLOR	PART NUMBER
Clear Matte Anodized	121128
Black Matte Anodized	121129

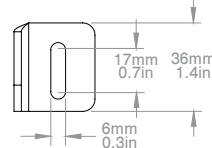
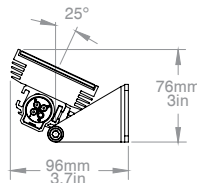
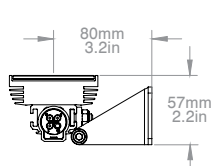

COLOR	PART NUMBER
Clear Matte Anodized	121130
Black Matte Anodized	121131

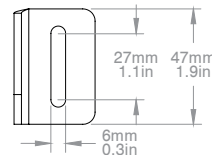
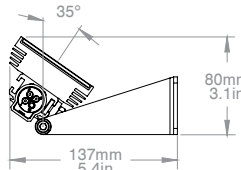
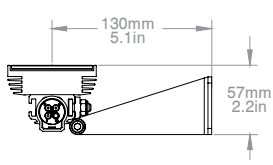

COLOR	PART NUMBER
Clear Matte Anodized	121132
Black Matte Anodized	121133

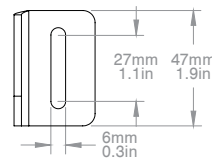
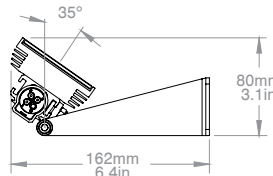
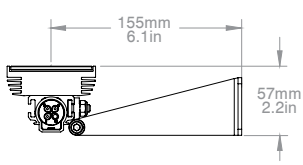

COLOR	PART NUMBER
Clear Matte Anodized	121134
Black Matte Anodized	121135

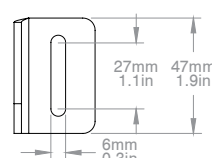
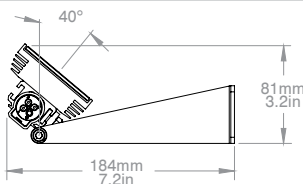
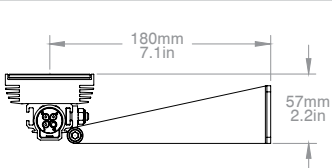

COLOR	PART NUMBER
Clear Matte Anodized	121136
Black Matte Anodized	121137

SMA-I - INSIDE ADJUSTABLE SURFACE MOUNT BRACKET KIT

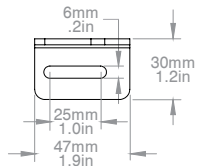
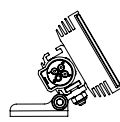
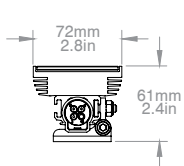

COLOR	PART NUMBER
Clear Matte Anodized	121138
Black Matte Anodized	121139

SMA-O - OUTSIDE ADJUSTABLE SURFACE MOUNT BRACKET KIT

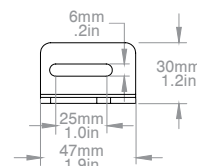
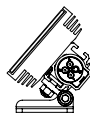
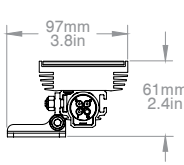

COLOR	PART NUMBER
Clear Matte Anodized	121825
Black Matte Anodized	121826

SML - SURFACE MOUNT BRACKET KIT, NON-ADJUSTABLE

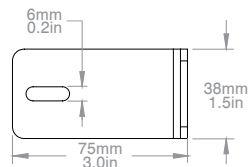
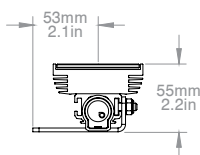

COLOR	PART NUMBER
Clear Matte Anodized	121140
Black Matte Anodized	121141

RGB Color Changing Linear Wall Washing and Grazing Indoor LED Lighting

PRODUCT SPECIFICATION SHEET

ORDERING LOGIC: STR9® MOUNTING ACCESSORIES

CLP - CLIP MOUNT KIT, NON-ADJUSTABLE

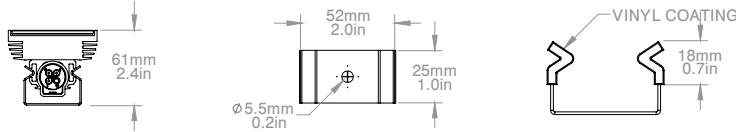

COLOR	PART NUMBER
Stainless Steel	121148

CTLX - ADJUSTABLE CANTILEVER BRACKET

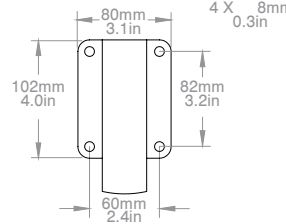
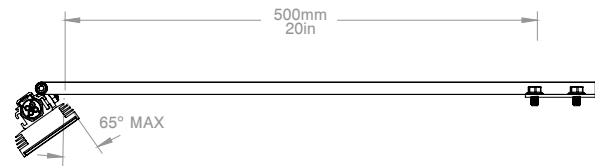

CTLH - HORIZONTAL MOUNTING BRACKET

COLOR	PART NUMBER
Clear Matte Anodized	121142
Black Matte Anodized	121143

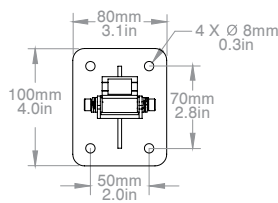
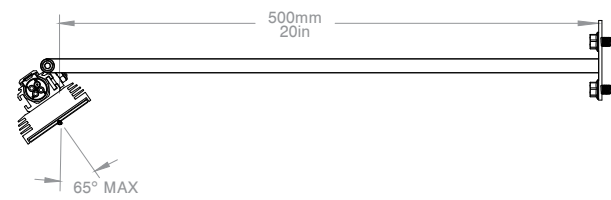

CTLV - VERTICAL MOUNTING BRACKET

COLOR	PART NUMBER
Clear Matte Anodized	121144
Black Matte Anodized	121145

MCD - CANTILEVER BRACKET, NON-ADJUSTABLE

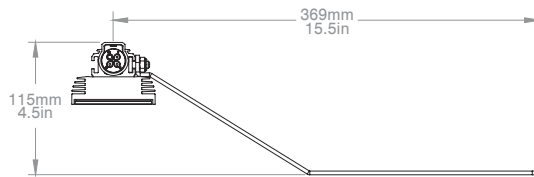

MCD

COLOR	PART NUMBER
Stainless Steel	121146

ORDERING LOGIC: POWER SUPPLIES & POWER DATA CONVERTORS

INFINITY POWER SUPPLIES, 100-240V AC

PS-INF 3000

INPUT TYPE	PART NUMBER
Single-Phase	G20260
Two-Phase	G20261

INFINITY POWER-DATA CONVERTORS

PDC-INF, INF+ZH, IP66

INPUT TYPE	PART NUMBER
1DMX	G20222
2DMX	G20228
0~10V DALI	G20223

ELV POWER SUPPLIES

FAMILY	OUTPUT VOLTAGE	POWER (Watts)		INPUT VOLTAGE	CONSTRUCTION	
PS	ELV24	60	240	120~277V AC	IP30 - Indoor IP66 - Outdoor	
		100	320			
	ELV48	240	480			
		320	640			
FAMILY	OUTPUT VOLTAGE	POWER (Watts)	CONTROL INPUT	OUTPUT	INPUT VOLTAGE	CONSTRUCTION
PDB	ELV24	60	240	0~10V	120~277V AC	IP30 - Indoor IP66 - Outdoor
		100	320	DALI		
	ELV48	240	480	DMX		
		320	640			

STR9[®] LITE

INFINITY[®]
GVA TECHNOLOGY

COLOR-AMP[®]
GVA TECHNOLOGY

GVA
LIGHTING

RGB Color Changing Linear Wall Washing and Grazing Indoor LED Lighting

PRODUCT SPECIFICATION SHEET

ORDERING LOGIC: COMMON COMPONENTS

STR9[®] LEADER CABLE ELV

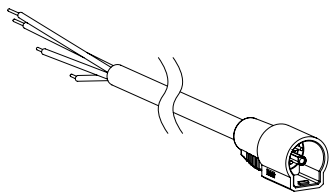

NOMINAL LENGTH	PART NUMBER
3m (10ft)	140723
9m (30ft)	140733
15m (50ft)	140724
CUSTOM	140732

STR9[®] LEADER CABLE INF

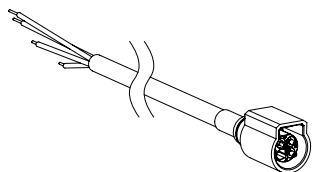

NOMINAL LENGTH	PART NUMBER
3m (10ft)	140725
9m (30ft)	140710
15m (50ft)	140726
CUSTOM	140727

STR9[®] JUMPER CABLE ELV

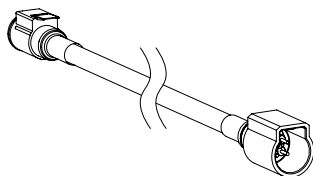

NOMINAL LENGTH	PART NUMBER
0.9m (3ft)	140729
1.8m (6ft)	140730
3.6m (12ft)	140731
CUSTOM	140728

STR9[®] JUMPER CABLE INF

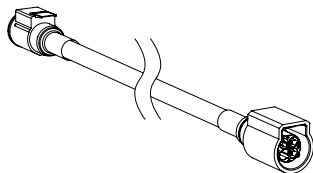

NOMINAL LENGTH	PART NUMBER
0.9m / 3ft	140709
1.8m / 6ft	140734
3.6m / 12ft	140735
CUSTOM	140708

STR9[®] CONNECTOR DUST CAP, IP67 (must be used at the end of each run)

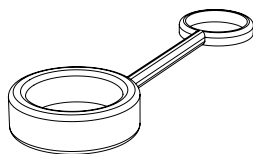

TYPE	PART NUMBER
STR9-INF	230855
STR-ELV	231182

STR9[®] GLARE CONTROL LOUVERS

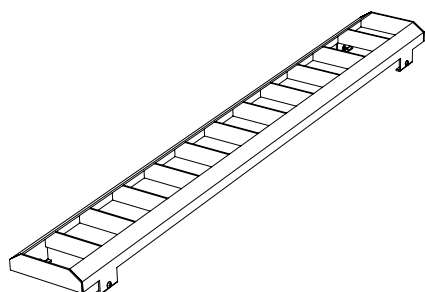

600mm LOUVER

COLOR	PART NUMBER
White	120939
Black	120933

900mm LOUVER

COLOR	PART NUMBER
White	120940
Black	120934

1200mm LOUVER

COLOR	PART NUMBER
White	120941
Black	120935

1500mm LOUVER

COLOR	PART NUMBER
White	120942
Black	120936