



Product Description

The VEX-MIDISPOT is an LED luminaire suitable for indoor and outdoor applications for architectural lighting and general lighting purposes.

This VEX-MIDISPOT uses a remote LED driver to power the luminaire. Driver dimming options are available. Lumen outputs vary between 300 and 600 lumens depending on white drive currents.

The luminaire is offered in single white LED colour temperatures, RGB, RGBA and RGBW and has various options for beam angles. It is ideal for applications such as architectural lighting, landscape, detail and spot lighting. Manufactured from anodised machined aluminium the luminaire offers unrivalled light output in a small form factor. Various beam angles are available for a multitude of light spreads.

Dimming options: Switched, 1-10V, DALI, DMX

Colour change option: RGB, RGB+White, RGB+Amber

Optional ground spike can be ordered separately for landscape projects

Technical

LED Drive Current (mA)	350 - 700	Maximum System Watts	9
Driver Type	Constant Current	Remote Driver Input Voltage	110-240 VAC
Connections	Hard Wired	Operating Temperature	-10 to + 40
CRI	70-85	LED Type	HB LED
Number of LEDs	3 or 4	Expected Lifetime (Hrs)	50,000
Beam Angle (Degrees)	Pin spot, narrow, medium, wide, extra wide	CCT (K)	2700, 3000, 4000, 5000
		Lumen output for whites	300-600
Dimensions (MM)	See Drawing	Weight (KG)	0.5
Ingress Protection (IP)	67	Finishes Available	Anodised Black or Silver

Dimensions

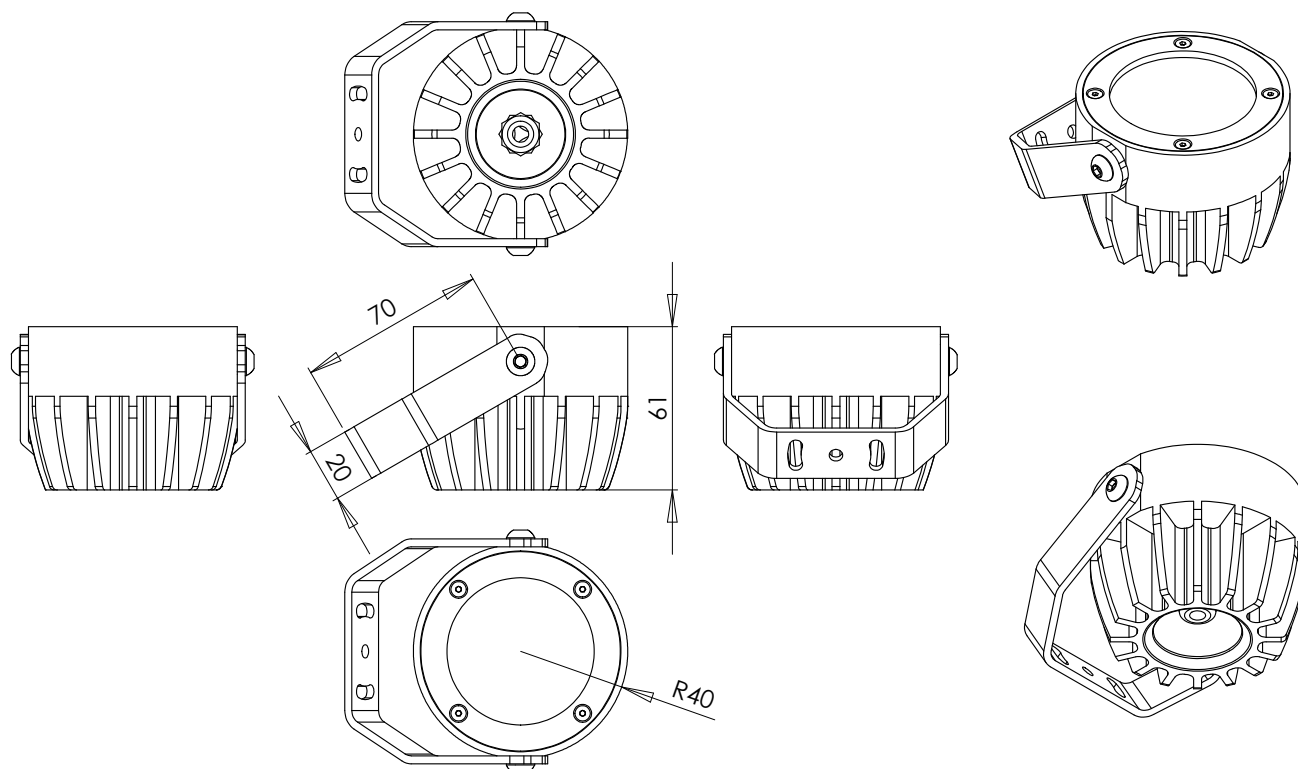

Order Code nomenclature

Product	Type	Qty LEDs	Colour Temp	Beam Angle
VEX	Midispot	3 or 4	2700 K	PIN SPOT - 006
			3000 K	NARROW - 010
			4000 K	MEDIUM - 015
			5000 K	WIDE - 025
			RGB	EXTRA WIDE - 045
			RGBA	
			RGBW	

VEX-MIDISPOT-3-4000-015

Product code example equates to a Vex MIDISPOT bracketed spot light containing 3 LED's in 4000 kelvin colour temperature with medium beam optics