

# VEX-MINILINE-TIR-PRO

**VEXICA**

PROJECT

TYPE

QUANTITY

LOCATION



## Luminaire:

**Materials:** Anodised Aluminium

**Finish:** Silver Body with Black End Caps

**Profile Dimensions:** 18 x 15mm

**Lengths:** 182mm to 1502mm

**Accessories:** Sprung Steel Fixing Clips

**Formats:** 2700K, 3000K, 3500K, 4000K, 5000K

**Lens:** PMMA

**Cable Entry:** Fitted Through Endcap

**Binning:** CREE Z BIN

## Technical

<b>Wattage</b>	18 Watts Per 1000mm	<b>Actual Power consumption (W)</b>	4.3
<b>Driver Type Remote</b>	Constant voltage 24 VDC	<b>Luminaire Lumens</b>	241
<b>Driver options</b>	SWITCHED	<b>Source Lumens (per DC watt)</b>	71
<b>Connections</b>	JST IP67	<b>Operating Temperature (°C)</b>	-10 to + 40
<b>CRI (Minimum)</b>	80	<b>CCT (K)</b>	2700
<b>Number of LEDs</b>	6 per 165mm	<b>LED Pitch (mm)</b>	27.5
<b>Beam Angle (°)</b>	48 x 16 and 34	<b>Listings</b>	CE
<b>IP rating</b>	IP40	<b>Weight (g)</b>	96 per 500mm
<b>Dimensions (mm)</b>	18 x 15mm    L: 179mm		

## Dimensions

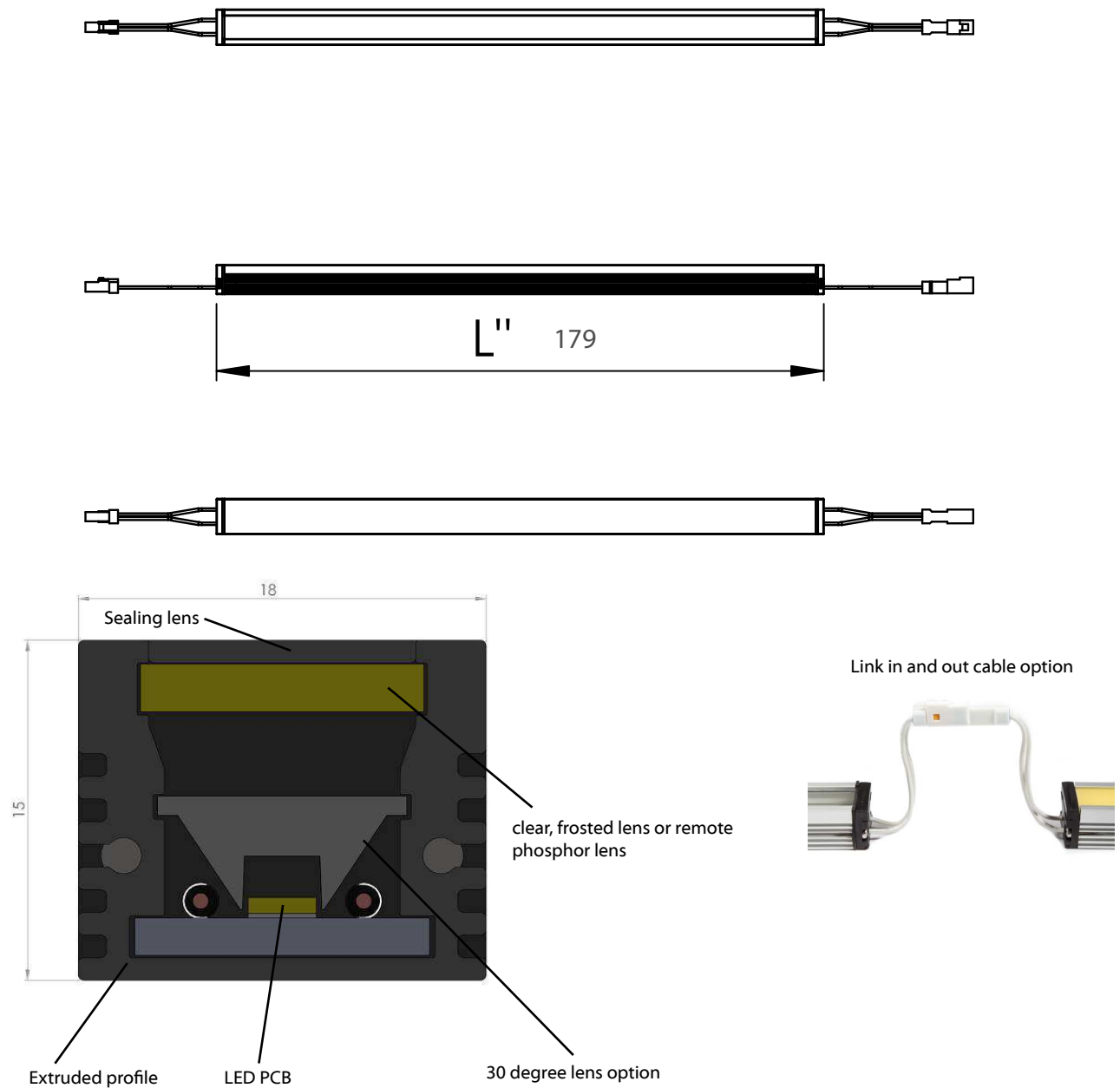

## Product order code

VEX - MINILINE - TIR - PRO- 179 - 2700 - IP40 - SWITCHED