

O Z O N E

Ozone

66 rue Notre Dame de Nazareth
75003 Paris

TECHNICAL DATA : Brasilia L

(please see conditions below)

Done on-line on March 27 2017

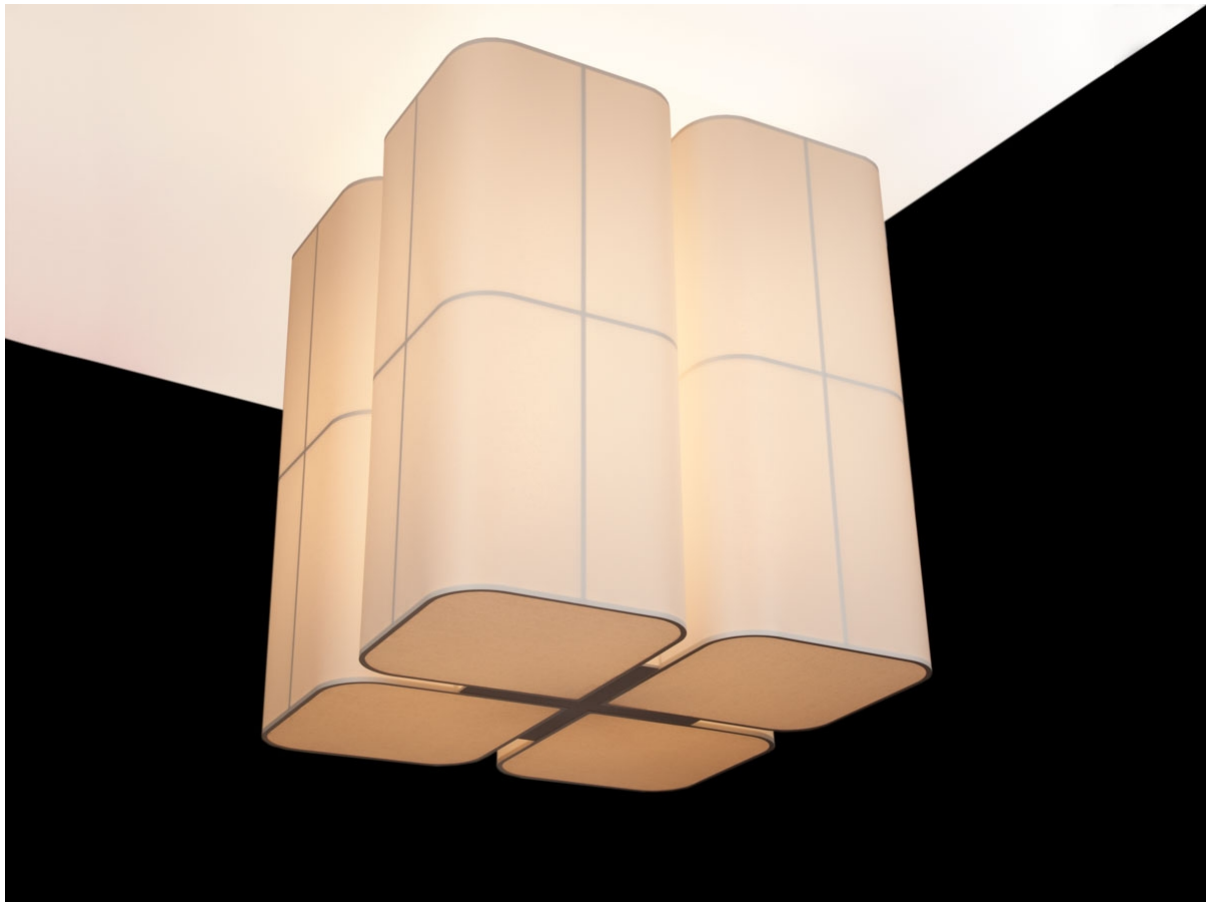

DESCRIPTION : Chandelier. Structures and stem are in white lacquered aluminum. The shade is in white polycarbonate with paper diffusion material. Warm white LED sources, 230W, 11800Lumens. Converter 24V outside the lamp, to be placed in a distant box, not included. Weight: 50kg.
Size: 100x100x110cm + Height of the hanging structure.
Compliance: CE Class III.

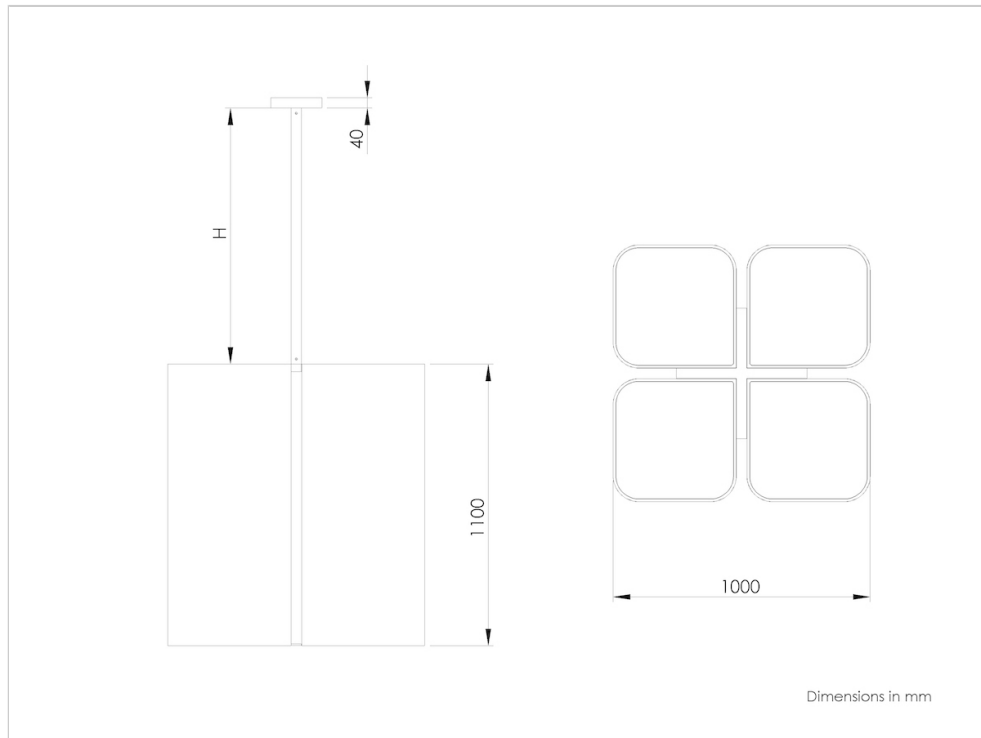

FUNCTION : The lighting provides a diffusing light, softening the shadows.
The light output is 11800 Lumens equivalent to a 12x100W incandescent bulb.
The light intensity can be dimmed from 0 to 100%.
A warm light is produced by ATEA brand LED 2200°K, with a CRI>95 and a yield of 75lm/W. Energy efficiency: A+.

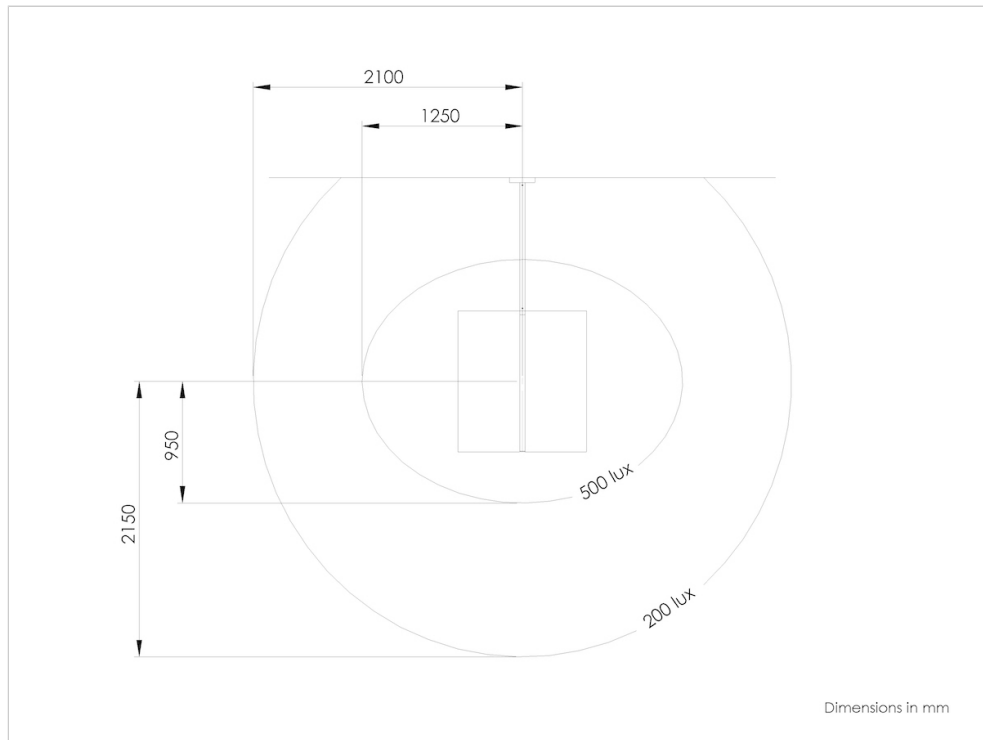

ELECTRICAL CONNECTION : The lighting consumes 230W, is supplied without 24V power supply and is designed to receive 4 remote constant voltage power supply 24V. We recommend the use of 4 power supplies MEANWELL PLC-100-24 with ELDOLED LINEARdrive 211D driver witch allows optimal 0-10V dimming from 0 to 100%. They must be placed in an accessible and ventilated place.

Make sure the cable length between power supply and light and their section apply to the attached diagram.

The cables must not cross the screws of the plate.

IMPORTANT:

Remote power supply 24V.

8 wires for power supply.

0-10V or DALI dimming.

Height of the hanging structure.

CABLE SIZE / MAX DISTANCE (D)				
0,5 mm ² / 20 AWG	0,75 mm ² / 18 AWG	1,0 mm ² / 17 AWG	1,5 mm ² / 15 AWG	2,5 mm ² / 13 AWG
5 m / 10 ft	8 m / 20 ft	10 m / 30 ft	15 m / 40 ft	25 m / 70 ft

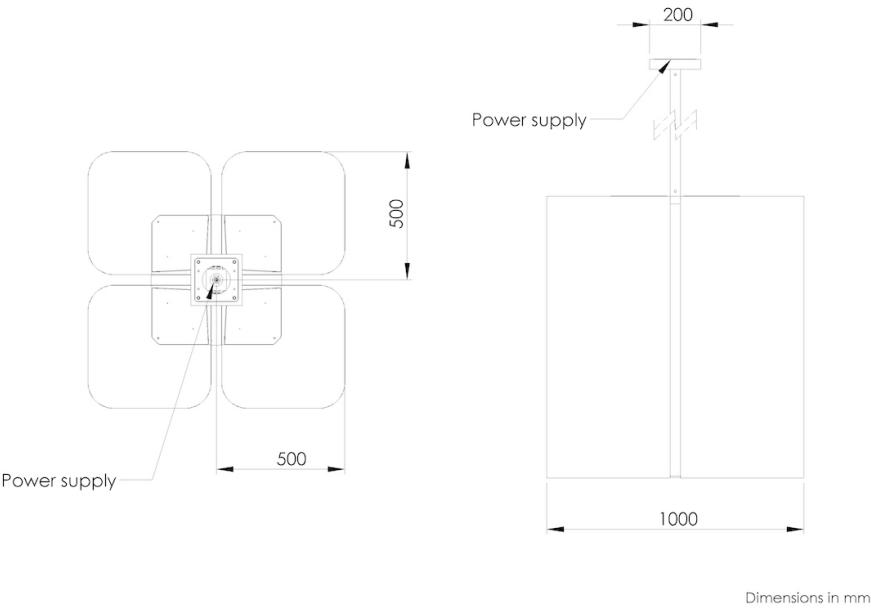
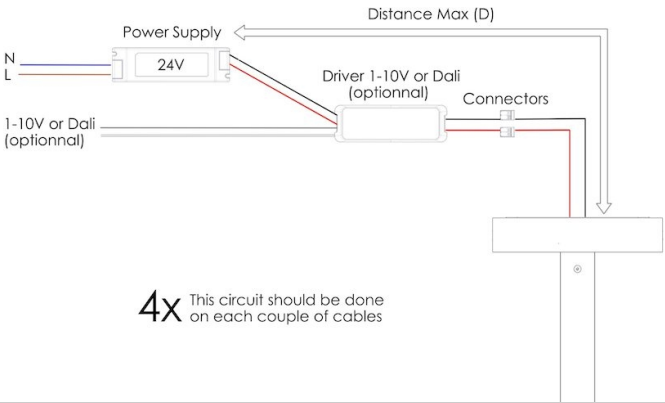

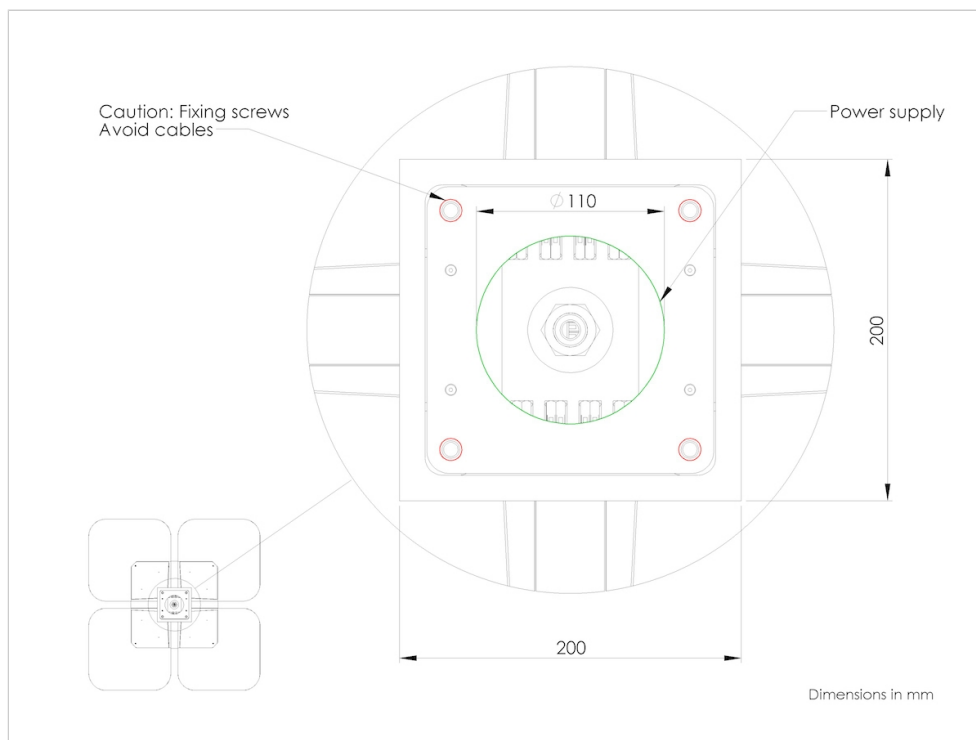

MECHANICAL FASTENING : Make sure that the ceiling is straight. The fixing of the plate is realized with screws, see map. Use the appropriate method according to the materials on which it will bind. Lamp Weight: 50kg. Drill avoiding electrical cables.

IMPORTANT:

If necessary please reinforce the ceiling at the plate.

Weight: 50kg.

Make sure that the ceiling is straight.

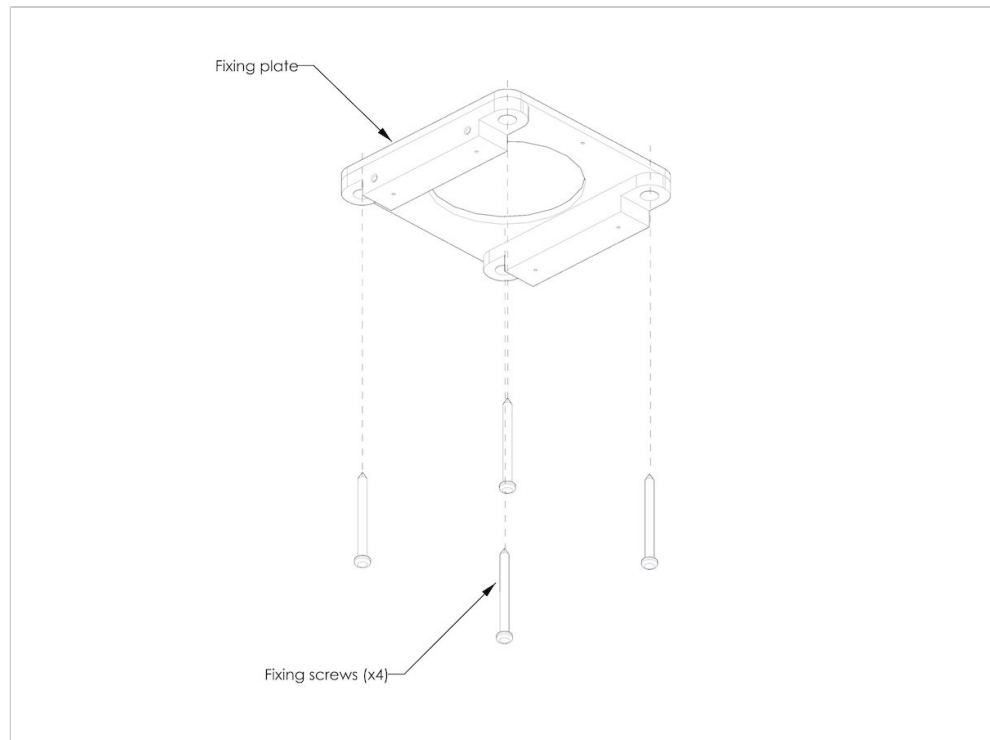

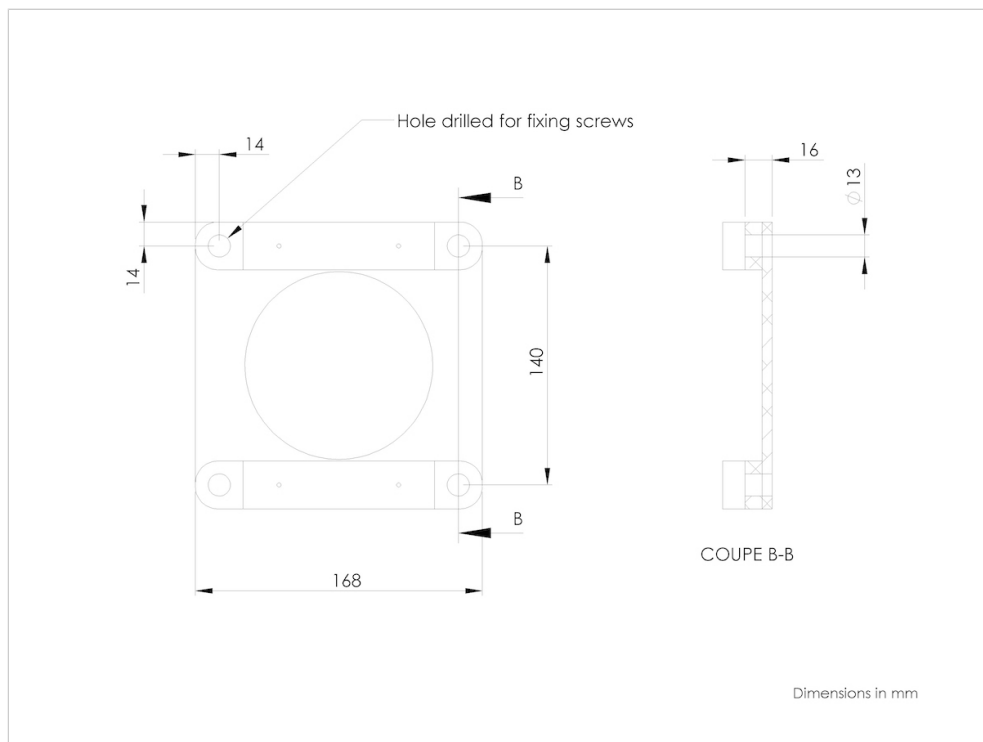

MOUNTING :

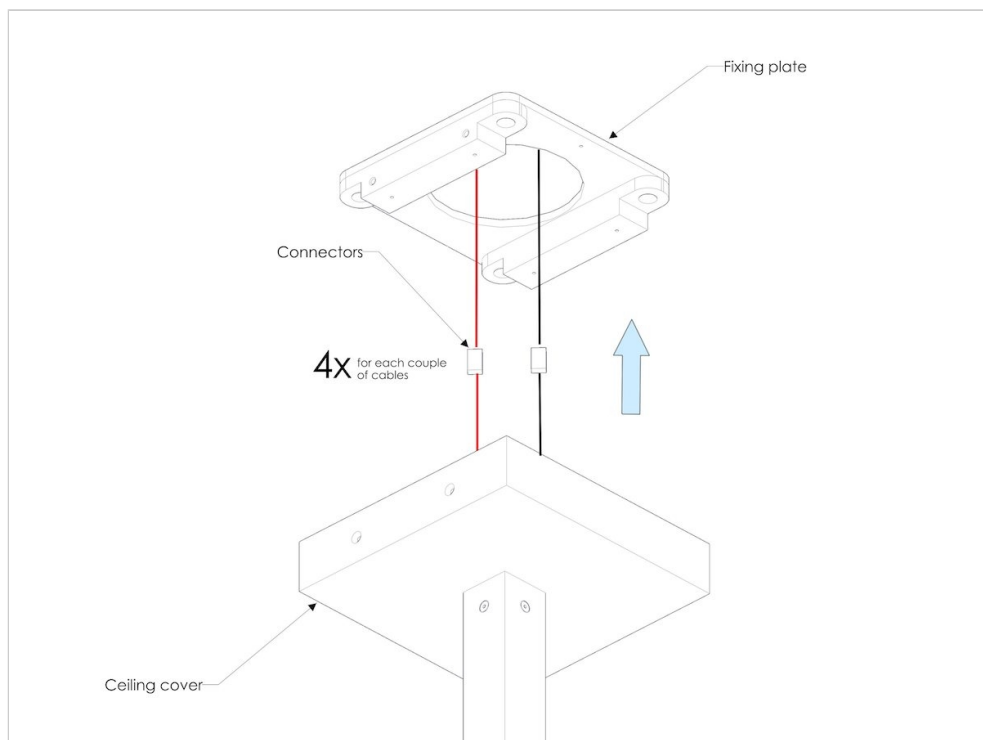

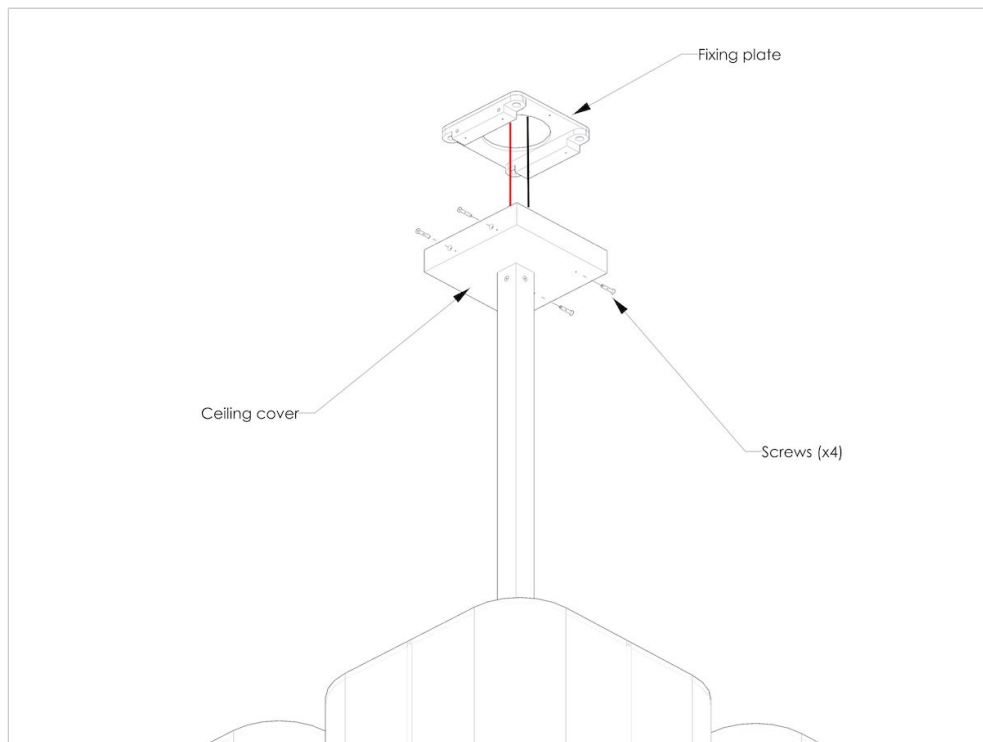

PACKAGING : The lamp is protected by 6 cardboard, wood and polyethylene foam packaging.

Weight light included: 35kg x4 + 25kg + 15kg.

Dimensions: 135x70x80cm x4 + 55x55x42cm + Hx16x15cm.

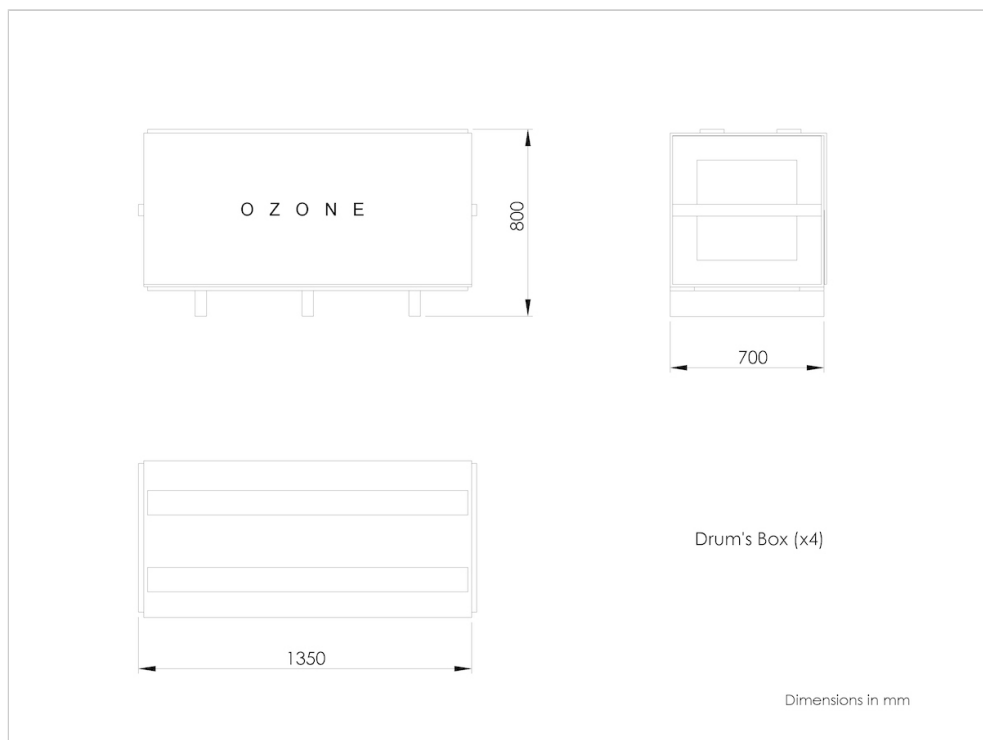

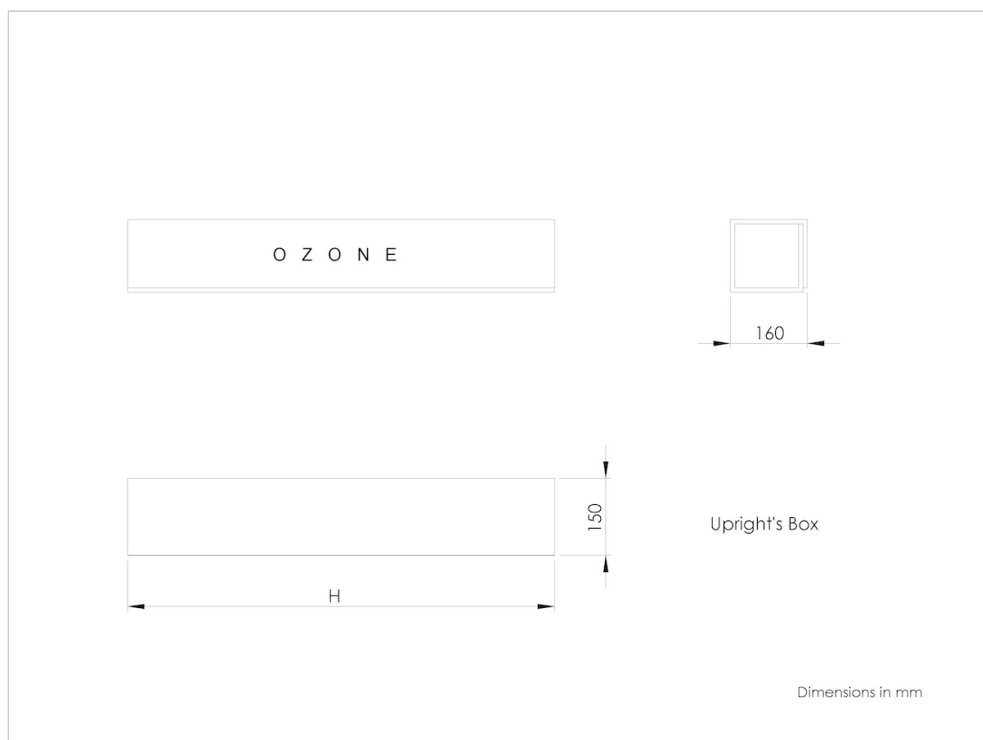
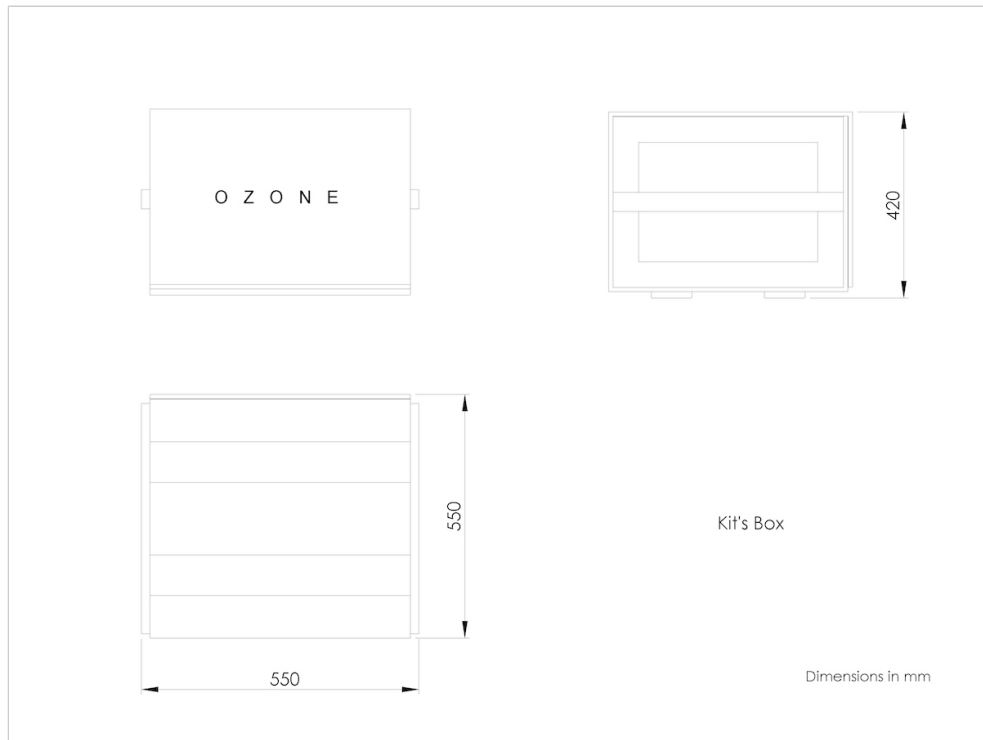

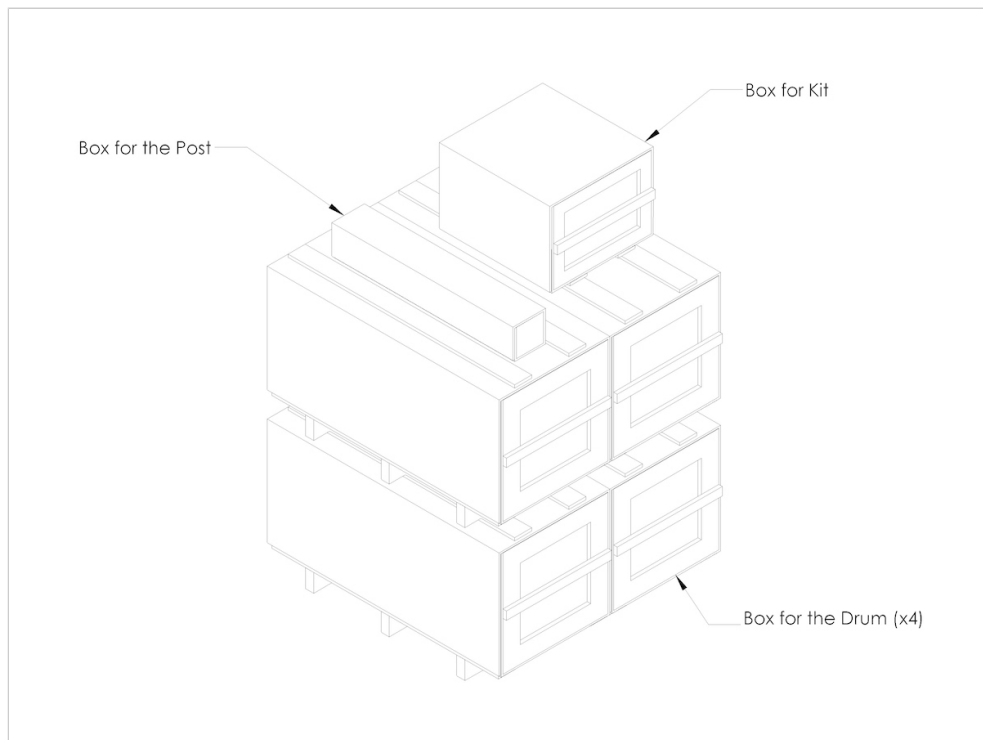

MAINTENANCE : The plate cleaning is done with a white soft damp cloth. For some traces locally you can use a soft cloth with glass cleaner . Be careful not to touch the LED to avoid damaging them. The diffuser cleaning is carried out with a dry cloth. For some traces can be used locally with a soft damp cloth carefully.

