

RING™

WHITE LED DIRECT ILLUMINATION

WEB PIN™ 100

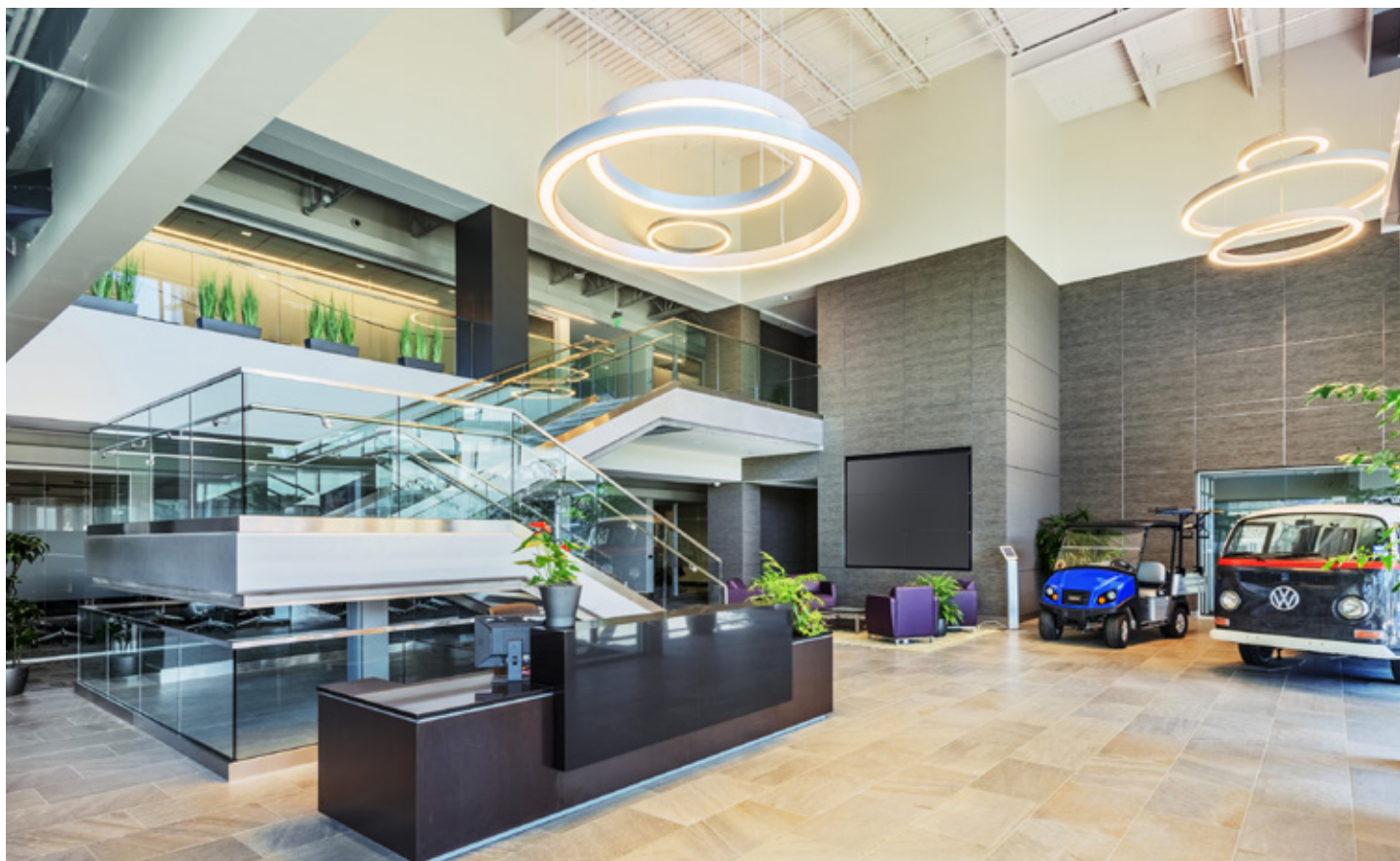

GENERAL SPECIFICATION

Body and trim: Steel and aluminium.

Finish: Powder coated.

Suspension: Stainless steel cables.

Power cable: Silver braided.

Diffusers: Opal Polycarbonate, supplied in sections.

Drivers: Integral, HPF electronic drivers for 120-277V, 0-10V, 1% dimming standard.

Mechanical: Luminaires mount directly over J box (by others).

Emergency system: Emergency option provides a 1.5 hour emergency lighting facility. The self contained system includes the inverter module, batteries, an LED charge indicator and a test switch.

Approvals: ETL.

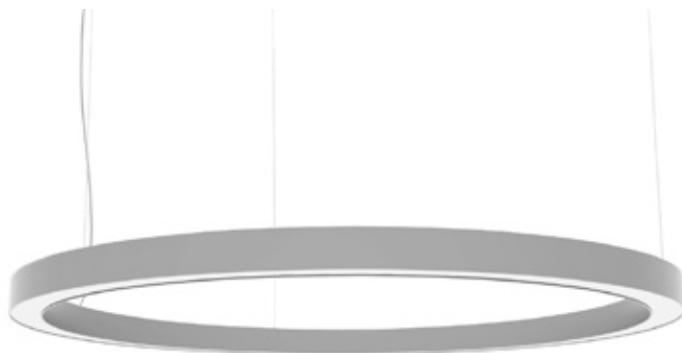

**A SPECIFY LUMINAIRE**

Code:	Diameter (A):	Power:	*Delivered lms:	*Efficacy LPW:	L70 @25°C:	Photometry:
95 0000	610mm/24"	65W LED	6038	93	> 50,000 hrs	File# 950000
95 0010	914mm/36"	101W LED	9438	93	> 50,000 hrs	File# 950010
95 0070	1219mm/48"	138W LED	12644	92	> 50,000 hrs	File# 950070
95 0020	1524mm/60"	180W LED	16704	93	> 50,000 hrs	File# 950020
95 0080	1829mm/72"	216W LED	19962	92	> 50,000 hrs	File# 950080
95 0030	2133mm/84"	260W LED	24127	93	> 50,000 hrs	File# 950030
95 0090	2438mm/96"	281W LED	25408	90	> 50,000 hrs	File# 950090
95 0040	2743mm/108"	325W LED	29769	92	> 50,000 hrs	File# 950040
95 0050	3657mm/144"	432W LED	39293	91	> 50,000 hrs	File# 950050
95 0060	5486mm/216"	692W LED	62501	90	> 50,000 hrs	File# 950060

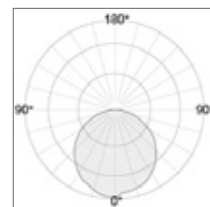
**B SPECIFY CCT**

30 3000K (min 80 CRI)

35 3500K (min 80 CRI)

40 4000K (min 80 CRI)

C SPECIFY SUSPENSION

S1 Vertical suspension

S2 Hub suspension (not available with 3657mm/144" DIA or larger)

D SPECIFY FINISH

WH White

MS Metallic silver

E SPECIFY OPTIONS

PR1 Lumen reduction to approximately 50% of standard output

PR2 Lumen reduction to approximately 75% of standard output

EN Encelium/Zigby control

EM Emergency system

*approx values based on 3000K (min 80 CRI)

Example Specification Code: 95 0010 • 35 • S1 • WH

Ring DIA:	Supplied sections:	Suspension points:	Total weight:
610mm/24"	1	3	8Kg/18lbs
914mm/36"	1	3	12Kg/26lbs
1219mm/48"	1	3	15Kg/35lbs
1524mm/60"	1	3	19Kg/42lbs
1829mm/72"	1	3	24Kg/52lbs
2133mm/84"	1	6	27Kg/60lbs
2438mm/96"	3	6	32Kg/69lbs
2743mm/108"	3	6	34Kg/75lbs
3657mm/144"	4	8	46Kg/102lbs
5486mm/216"	6	12	69Kg/152lbs

Ring luminaires are supplied in several sections for assembly on site.
Luminaires are pre-wired and connect electrically and mechanically.

