

Project Title:

Luminaire Ref:

 Press to send

Send form to whitegoods



plaster-in



bezel

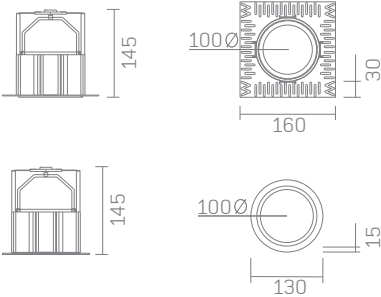

Specifier Details

Product Codes & Description (Ordering information)						
Frame	LED module	Beam °	Diffuser	Dimming	Voltage	Emergency
P100RRG* plaster-in B100RRG* bezel	XI-830-780* 80 CRI 8.8W Up to 780 lm	Xicato 40°* 56°	OA* open aperture (see accessories for available options)	ND non-dim 0-10V 0-10 Volt dim 1-10V 1-10 Volt dim TR trailing edge dim DALI DALI protocol	220-240V standard 120-277V universal	EMND non-dim EMST self-test EMDA DALI
	XI-930-500* 95 CRI 8.5W Up to 500 lm					
	CL-830-1300 80 CRI 13.6W Up to 1300 lm	Citiled 19°* 41°*				
	CL-930-1000 97 CRI 13W Up to 1000 lm					

* Items available for Quickship

Product Description
A 100mm round recessed directional multiple head gimbal luminaire with absolute minimal visual impact.

Finish
Standard product finish is white powder coated RAL 9010 with 30% gloss

Cut-out
Ø 115mm



Example LED module codes
XI-830-780
XI = Xicato
830 = 80CRI, 3000K colour temperature
780 = up to 780 lumen package

XI-927-500
XI = Xicato
927 = 95CRI, 2700K colour temperature
500 = up to 500 lumen package

CL-827-1300
CL = Citiled
830 = 80CRI, 3000K colour temperature
1300 = up to 1300 lumen package

Examples of typical output options
Module XI-827/830/840
Run @ 350mA = 780lm, 8.8W

Module XI-927/930/940
Run @ 350mA = 500lm, 8.5W

Module CL-827/830/840
Run @ 350mA = 1300lm, 13.2W

Dimming

- ND: non-dimming
- 0-10V: 0-10 Volt dimming, min 0.1%
- 1-10V: 1-10 Volt dimming, min 0.1%
- TR: trailing edge dimming
- DALI: DALI protocol, min 0.1%

All drivers are suitable for remote mounting up to 10 meters from fixture. Longer distances are available on request. Minimum ceiling depths apply, contact Whitegoods for further details.

Emergency
EMND: emergency non-dimmable
EMST: emergency self-test
EMDA: emergency DALI protocol

Accessories
AG-50-F: frosted glass
AG-50-C: clear glass
AG-50-S: sculpture glass
AG-50-P: micro prismatic glass
AL-50: louvre

Notes

- Manufacturing LED module detail shown. Refer to photometry data for LM79-08 results.
- All LED modules available in 2700, 3000, 3500 and 4000 Kelvin.
- Luminaires rated at 40°C maximum ambient temperature.
- 30° tilt in all directions.
- Insert with Citiled module must be disengaged in tilted position.

Please contact Whitegoods for further LED specifications.