

# ADL.CP Type N

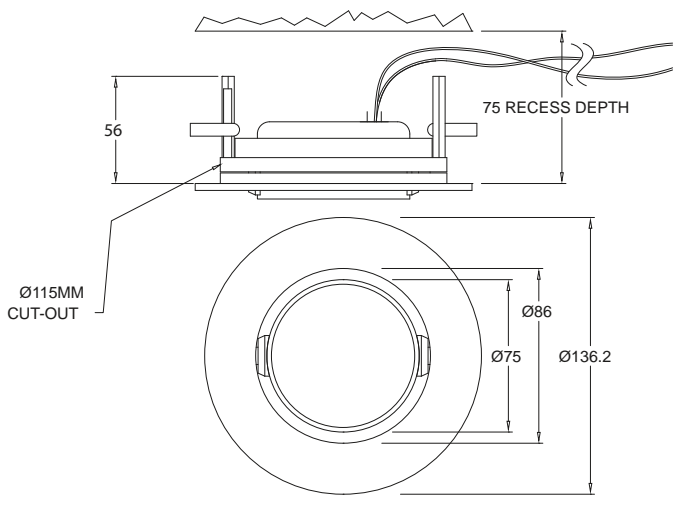

Order Code	ADL.CP.N3 or N5.Finish.Optic.Col Temp
Example	ADL.CP.N5.RAL9010.20°.6500K



- Materials: Aluminium
- Lamp: Type N3 or Type N5 LED PCB
- Finish: Brushed aluminium or painted to any RAL colour
- Dimming: 1-10V or DMX
- Driver: Remote driver required.  
Allow 6.9W (N3) or 11.6W (N5) at 700mA  
Allow 3.2W (N3) or 5.4W (N5) at 350mA
- Locking: 3mm allen key required
- Available Tilt: ± 38°
- Weight: 0.55kg
- Description: Lockable Power LED downlight with magnetic coverplate to conceal fixings.
- Accessories: Ø20mm optics (N5 PCB) or Ø27mm optics (N3 PCB)

Please note all output figures are based on output from bare LED strips/arrays and for indicative purposes only, output will vary when in fittings and as a function of the LED colour and running temperature

## LED Information

Each LED "lamp" consists of one or more CREE power LED thermally bonded to an aluminium cored printed circuit board. Colour temperatures of 2800K, 3000K, 3500K, 5000K and 6500K can be specified as can Amber, Red, Green or Blue.

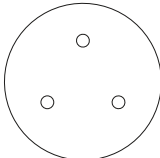

**Type N3**  
Ø61mm PCB with three x CREE XREs on one circuit. For Ø27mm optics.

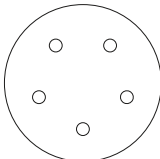

**Type N5**  
Ø61mm PCB with five x CREE XPEs on two circuits. For Ø20mm optics.

For driver information see LED spec sheet