

Iris Type S

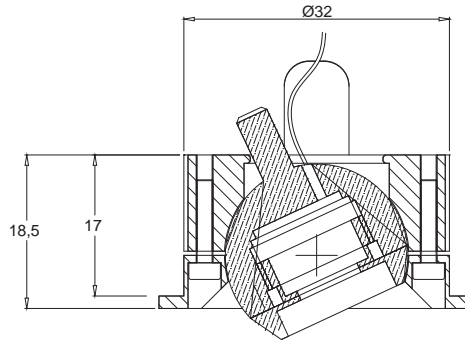

Snoot Options:

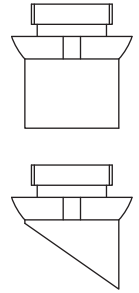

Order Code	Iris Type S.col temp.optic.finish
Example	Iris Type S.2800K.8.2°.alu



Materials:	Aluminium
Lamp:	Type S (1 x Cree XPE)
IP Rating:	IP65
Finish:	Anodised
Dimming:	1-10V, DMX or DALI (Mains dim available for some set ups but not recommended for single fittings / small numbers)
Cut out:	Ø34
Driver:	Remote driver required. 500mA max
Locking:	With 1.5mm allen key
Available Tilt:	±22°
Weight:	0.1kg
Description:	IP65 rated eyeball fitting that finishes almost flush with the mount surface. Interchangeable Ø10mm optics.
Accessories:	Ø10mm optics. See technical section on our website for beam angle options. Optional snoots

Please note all output figures are based on output from bare LED strips/arrays and for indicative purposes only, output will vary when in fittings and as a function of the LED colour and running temperature

LED Information

The Type S PCB uses 1 x Cree XPE power LED thermally bonded to an FR4 gold coated PCB, heat sunk by means of gold vias. Colour temperatures of 2800K, 3000K, 3500K and 6500K can be specified as can amber, red, green or blue.

Type S

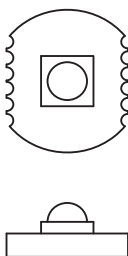

For driver information see LED driver spec sheet.