

## Frog Type M

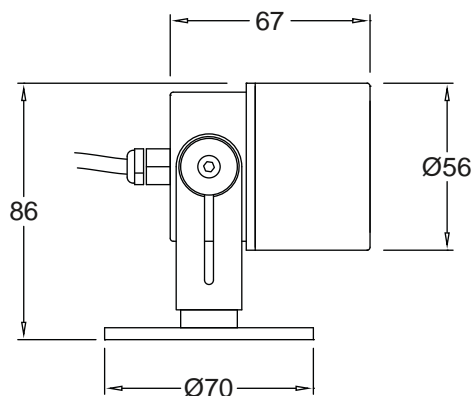

Order Code	Frog.M.col temp.optic.finish
Example	Frog.M.3000K.20°.RAL9006



Materials:	Aluminium
Lamp:	Type M (3 x Cree XPE)
IP Rating:	IP66
Finish:	Anodised or painted any RAL colour
Dimming:	1-10v or DMX
Driver:	Remote driver required. Allow 9w at 700mA, 3w at 350mA
Locking:	2.5mm allen key required
Available Tilt:	± 90°
Weight:	0.5kg
Description:	Type M LED version of our Frog exterior spot
Deviation:	Can be spike mounted
Accessories:	Ø20mm optics. See technical section on our website for beam angle options. Lenses and louvers available.

Please note all output figures are based on output from bare LED strips/arrays and for indicative purposes only, output will vary when in fittings and as a function of the LED colour and running temperature

### LED Information

The Type M "lamp" consists of three CREE XPE power LED thermally bonded to an aluminium cored printed circuit board. Colour temperatures of 2800K, 3000K, 3500K, 5000K and 6500K can be specified as can Amber, Red, Green, Blue or any combination of these.

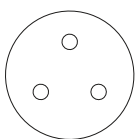

#### Type M

Ø49mm PCB with three LEDs on a single circuit. For XPE optics.

For driver information see LED driver spec sheet.  
For more optic information see Optic spec sheet.